



## RALLY GUANAJUATO MÉXICO

León, Guanajuato, México

March 6 - 11, 2018

Approved by the FIA

## 2018 SUPPLEMENTARY REGULATIONS

## INDEX

|  |    |
|--|----|
| 1. Introduction.....                                   | 3  |
| 2. Organisation .....                                  | 4  |
| 3. Programme.....                                      | 9  |
| 4. Entries.....  | 13 |
| 5. Insurance .....                                     | 18 |
| 6. Advertising and Identification.....                 | 19 |
| 7. Tyres .....   | 19 |
| 8. Fuel .....  | 21 |
| 9. Reconnaissance.....                                 | 22 |
| 10. Administrative Checks.....                         | 23 |
| 11. Scrutineering, Sealing and Marking .....           | 24 |
| 12. Other Procedures.....                              | 25 |
| 13. Identification of Officials.....                   | 28 |
| 14. Prizes .....                                       | 29 |
| 15. Final Checks and Protests.....                     | 30 |
| Appendix 1 – Provisional Itinerary .....               | 31 |
| Appendix 2 – Provisional Reconnaissance Schedule ..... | 35 |
| Appendix 3 – Competitors’ Relations Officers.....      | 36 |
| Appendix 4 – Competition Numbers and Advertising ..... | 37 |
| Appendix 5 - Safety Requirements.....                  | 38 |
| Appendix 6 – SIT – Safety Tracking System .....        | 39 |

## 1. INTRODUCTION

### 1.1. Rally México 2018

This rally will be run in compliance with the FIA International Sporting Code and its appendices, the 2018 FIA World Rally Championship Sporting Regulations and these Supplementary Regulations.

Modifications, amendments and/or changes to these Supplementary Regulations will be announced only by numbered and dated Bulletins (issued by the Clerk of the Course or the Stewards).

Additional information will be published in Rally Guide 2, to be issued on February 6<sup>th</sup> 2018. The 2018 FIA World Rally Championship Sporting Regulations can be found at: [www.FIA.com](http://www.FIA.com)

### 1.2. Road Surface

- The Rally stages will be run on gravel.
- The Super Special Stages (Stages 9/10 & 17/18) will be run on mixed surface, 20% gravel and 80% asphalt.
- The Street Stage GTO (SS 1) will be run on cobblestone and concrete. [2.53 km]
- The Street Stage León (SS 5 & 19) will be run on pavement. [1.11 Km]

### 1.3. Distances

This Rally will have a total Itinerary distance of 1055.88 kilometres, of which 344.49 kilometres will be Special Stages. (33%)

For the NACAM Rally Championship Itinerary, only sections 1 to 4 of the itinerary will be run for a total of 225 kilometres of Special Stages.

## 2. ORGANISATION

### 2.1. FIA Titles for which the Rally counts

- FIA World Rally Championship for Manufacturers
- FIA World Rally Championship for Drivers
- FIA World Rally Championship for Co-drivers
- FIA WRC 2 Championship for Teams
- FIA WRC 2 Championship for Drivers
- FIA WRC 2 Championship for Co-Drivers
- FIA WRC 3 Championship for Teams
- FIA WRC 3 Championship for Drivers
- FIA WRC 3 Championship for Co-Drivers
- FIA NACAM Rally Championship for Drivers
- FIA NACAM Rally Championship for Co-drivers

### 2.2. Visa numbers

|              |                    |                             |
|--------------|--------------------|-----------------------------|
| FIA Visa No. | <b>3WRC/250118</b> | Issued on: January 25, 2018 |
| ASN Visa No. | <b>148/2018</b>    | Issued on: January 19, 2018 |

### 2.3. Organizer's Contact Details

**Promoter:** Rallymex S.A. de C.V.

**ASN:** Organización Mexicana del Deporte Automovilístico Internacional (OMDAI FIA-México)

**Rally Secretariat:** **Rally México**  
 Ignacio Zaragoza #8  
 Col. Lomas Altas  
 Ciudad de México, 11950, MEXICO

|  |                            |
|--|----------------------------|
| General information e-mail:            | info@rallymexico.com       |
| Competitor's information <b>ONLY</b> : | compinfo@rallymexico.com   |
| Competitor entries <b>ONLY</b> :       | entries@rallymexico.com    |
| Official Website:                      | http://www.rallymexico.com |

|      |                  |
|------|------------------|
| Tel. | +52 55 5259 6904 |
| Fax. | +52 55 5570 3824 |

**Opening Hours (GMT -6 hrs):** Mon-Fri: 09:00 to 18:00 hrs

## 2.4. Organisation Committee

### Honorary Committee of the Rally

|  |                                |
|--|--------------------------------|
| <b>Guanajuato State Constitutional Governor:</b>   | Miguel Márquez Márquez         |
| <b>León Municipal President:</b>                   | Héctor López Santillana        |
| <b>Guanajuato Municipal President:</b>             | Edgar Castro Cerrillo          |
| <b>Silao Municipal President:</b>                  | Juan Antonio Morales Maciel    |
| <b>Irapuato Municipal President:</b>               | Ricardo Ortiz Gutierrez        |
| <b>State Economic Development Secretary:</b>       | Guillermo Romo Pacheco         |
| <b>State Public Works Secretary:</b>               | José Arturo Durán Miranda      |
| <b>State Public Safety Secretary:</b>              | Alvar Cabeza de Vaca Appendini |
| <b>State Attorney:</b>                             | Carlos Zamarripa Aguirre       |
| <b>State Tourism Board Secretary:</b>              | Fernando Olivera Rocha         |
| <b>León Tourism Board Secretary:</b>               | Gloria Cano                    |
| <b>State Commission for Sports and Youth Care:</b> | Isaac Piña                     |
| <b>León Municipal Economic Director:</b>           | Ramón Alfaro Gómez             |

### National Sporting Authorities

|  |                       |
|--|-----------------------|
| <b>OMDAI FIA México (ASN) President:</b> | Ing. José Abed        |
| <b>FEMADAC President</b>                 | Fernando Alfonso Oros |
| <b>CNRM President</b>                    | Álvaro Portalópez     |

### Organising Committee

|                             |                    |
|-----------------------------|--------------------|
| <b>President:</b>           | Juan Suberville    |
| <b>Rally Manager:</b>       | Gilles Spitalier   |
| <b>Rally Director:</b>      | Patrick Suberville |
| <b>Clerk of the Course:</b> | Jaime del Palacio  |

## 2.5. Stewards of the Meeting

|                                  |                           |
|----------------------------------|---------------------------|
| <b>Chairperson:</b>              | Mrs Waltraud Wunsch (DEU) |
| <b>2<sup>nd</sup> Steward:</b>   | Mr Hugo Mersan (PAR)      |
| <b>ASN Steward:</b>              | Mr Carlos Cordero (MEX)   |
| <b>Secretary of the Stewards</b> | Ms Yvonne Gilli           |

## 2.6. FIA Delegates

|   |                      |
|---|----------------------|
| <b>FIA Safety Delegate:</b>                 | Ms Michèle Mouton    |
| <b>FIA Medical Delegate:</b>                | Dra Manuela Alberro  |
| <b>FIA Media Delegate:</b>                  | Mrs Hayley Gallagher |
| <b>FIA Technical Delegate:</b>              | Mr Jérôme Toquet     |
| <b>Assistant to FIA Technical Delegate:</b> | Mr Karmo Uusmaa      |
| <b>Assistant to FIA Technical Delegate:</b> | Mr Lionel Berard     |
| <b>Assistant to FIA Technical Delegate:</b> | Mr Clément Clerc     |
| <b>FIA Sporting Delegate:</b>               | TBA                  |

## 2.7. Senior Officials

|   |                              |
|---|------------------------------|
| <b>President Organising Committee:</b>        | Juan Suberville              |
| <b>Rally Director:</b>                        | Patrick Suberville           |
| <b>Rally Manager:</b>                         | Gilles Spitalier             |
| <b>Clerk of the Course:</b>                   | Jaime del Palacio            |
| <b>Deputy Clerk of the Course:</b>            | Javier Martínez Gallardo     |
| <b>Assistant Clerk of the Course, Route:</b>  | René Hernandez               |
| <b>Assistant Clerk of the Course, Safety:</b> | Juan Goya                    |
| <b>Secretary of the Rally:</b>                | Bonnie Lee                   |
| <b>Human Resources Manager:</b>               | Ricardo Vélez                |
| <b>Chief Safety Officer:</b>                  | José Luis Abarca             |
| <b>Safety Coordinator OMDAI-FIA</b>           | Fernando Gutiérrez           |
| <b>Media Safety Officer:</b>                  | Andrés Nissen                |
| <b>Medical Director OMDAI FIA</b>             | Dr. Eduardo Pérez Pasten     |
| <b>Deputy Medical Director OMDAI FIA</b>      | Dr. Miguel M. Rubio Acitores |
| <b>Chief Medical Officer:</b>                 | Dr. Pablo Escalera Castillo  |
| <b>Deputy Chief Medical Officer:</b>          | Dr. Juan Pablo Cerwinka      |
| <b>Competitors' Relations Officer:</b>        | Ernesto Bachtold             |
| <b>Chief Media Officer:</b>                   | Adrian Molina                |
| <b>Media Accreditation Officer:</b>           | Estefania Duvignau           |
| <b>Media Centre Manager:</b>                  | Mauricio Gutierrez           |

|  |   |
|--|---|
| <b>Operations, General:</b>              | Jorge Gómez   |
| <b>Operations, Rally Campus:</b>         | Gabriela Arellano   |
| <b>Operations, Stages:</b>               | Dirk de Rudder  |
| <b>Service Area Coordinator:</b>         | Adda Fernanda López Alejos  |
| <b>Helicopter Coordinator:</b>           | Gustavo Salvatori   |
| <b>Materials:</b>                        | Amado Alarcón<br>Rocio Alarcón<br>Jesús Rangel  |
| <b>Chief Results Officer:</b>            | Jerónimo Aldana Falcon  |
| <b>Chief Scrutineer:</b>                 | Rafael Maggio   |
| <b>Stage Commanders:</b>                 | Arturo Boy<br>Gerardo Boy<br>Mariele Steller<br>Erick Alcerreca<br>Marco Alcerreca<br>Antonio Peñaflor<br>Marlen Peñaflor<br>Diego Morones<br>Ricardo Velez |
| <b>Planning Manager:</b>                 | Miguel Angel Ordorica   |
| <b>Chief Spectator Coordinator:</b>      | Vanessa Mota  |
| <b>Sales / Marketing:</b>                | Paloma Gonzalez   |
| <b>Assistant Com. Stand Coordination</b> | Luli Frago  |
| <b>Design / Image:</b>                   | Oscar Gutiérrez   |
| <b>VIP Coordinator:</b>                  | Beatriz Aponte  |
| <b>Information Technologies:</b>         | Heriberto Guevara   |
| <b>Social Media Manager:</b>             | Francisco Avalos  |
| <b>Video Producer:</b>                   | Christian Viguer  |

## 2.8. HQ Location and Details

The Rally HQ is located at:

Explanada de la Feria (Rally Campus)  
Blvd. Adolfo López Mateos 1816  
at Blvd. Francisco Villa  
León, Guanajuato  
MEXICO

Tel: +52 (477) 771-1301  
Fax: +52 (477) 771-1363

### Location of Start and Finish

|                               |                                     |
|-------------------------------|-------------------------------------|
| Ceremonial Start:             | Alhóndiga de Granaditas, Guanajuato |
| Start of Section 1:           | León Fairgrounds, León              |
| Start of Sections 2 to 6:     | León Fairgrounds, León              |
| End of Sections 2 to 5 and 7: | León Fairgrounds, León              |
| End of Section 6:             | Guanajuato, Guanajuato              |
| Start of Section 7:           | Guanajuato, Guanajuato              |
| End of the Rally:             | León Fairgrounds, León              |
| Podium:                       | Foro del Lago, Parque Explora, León |

### Location of overnight Parc Fermé

Only one overnight Parc Fermé location will be used throughout the rally at the León Fairgrounds (Rally Campus) in León, Guanajuato.

## 2.9. Official Notice Board

The Official Notice Board will be located in the Service Park main area at the Secretariat.

### 3. PROGRAMME

#### Saturday January 13<sup>th</sup>, 2018

Publication of Supplementary Regulations  
Opening Date of Entries

Website / Courier  
Permanent Secretariat

#### Tuesday February 6<sup>th</sup>, 2018

|       |                                      |                                 |
|-------|--------------------------------------|---------------------------------|
| 18:00 | Final date to receive import papers  | Permanent Secretariat           |
|       | Closing date for entries (GMT -6hrs) | Permanent Secretariat           |
|       | Issuing of the Road Book             | Permanent Secretariat / Courier |
|       | Publication of Rally Guide 2         | Website                         |

#### Tuesday February 13<sup>th</sup>, 2018

|       |  |                       |
|-------|--|-----------------------|
| 18:00 | Final date to receive original entry forms | Permanent Secretariat |
|       | Final date to notify fuel requirements     | Fuel Supplier         |

#### Thursday February 15<sup>th</sup>, 2018

|   |                       |
|---|-----------------------|
| Publication of Approved Entry List                | Website               |
| Final date to order extra material                | Permanent Secretariat |
| Final date for Shakedown registration (except P1) | Permanent Secretariat |

#### Saturday March 3<sup>rd</sup>, 2018

|       |                                   |              |
|-------|-----------------------------------|--------------|
| 12:00 | Opening of Service Park for Teams | Rally Campus |
|-------|-----------------------------------|--------------|

## Monday March 5<sup>th</sup>, 2018

|               |  |              |
|---------------|--|--------------|
| 08:00 – 22:00 | Opening of Rally Secretariat & Official Notice Board | Rally Campus |
| 08:00 – 22:00 | Registration for Reconnaissance                      | Secretariat  |
| 16:00 – 18:00 | Collection of Tracking Systems for Reconnaissance    | Secretariat  |
| 16:00 – 22:00 | Administrative Check-In (All competitors)            | Secretariat  |

## Tuesday March 6<sup>th</sup>, 2018

|               |  |              |
|---------------|--|--------------|
| 07:00 – 20:00 | Opening of Rally Secretariat & Official Notice Board | Rally Campus |
| 07:00 – 20:00 | Registration for Reconnaissance                      | Secretariat  |
| 07:00 – 19:00 | Reconnaissance                                       |              |
| 08:00 – 20:00 | Opening of Media Centre                              | Rally Campus |
| 08:00 – 20:00 | Administrative Checks: By appointment (P1)           | Secretariat  |
| 08:00 – 20:00 | Administrative Check: (All Competitors)              | Secretariat  |
| 14:00 – 18:00 | Opening of Media Accreditation                       | Media Centre |
| 17:00 – 20:00 | Collection of FIA Safety Tracking Systems            | Secretariat  |

## Wednesday March 7<sup>th</sup>, 2018

|               |  |              |
|---------------|--|--------------|
| 07:00 – 12:00 | Registration for Reconnaissance                      | Secretariat  |
| 07:00 – 19:00 | Reconnaissance                                       |              |
| 07:00 – 20:00 | Opening of Rally Secretariat & Official Notice Board | Rally Campus |
| 08:00 – 14:00 | Collection of FIA Safety Tracking Systems            | Secretariat  |
| 08:00 – 18:00 | Opening of Media Accreditation                       | Media Center |
| 08:00 – 20:00 | Opening of Media Centre                              | Rally Campus |
| 10:00 – 13:30 | Certification, sealing and marking (P1)              | Rally Campus |
| 10:00 – 20:00 | Administrative Check-In (All competitors)            | Secretariat  |
| 12:00 – 14:00 | Weight Checks (P1)                                   | Service Park |
| 16:00         | Team Managers' Briefing                              | HQ           |
| 15:00 – 20:00 | Pre-event Scrutineering (P2, P3 & Non-Priority)      | Service Park |
| 19:00 – 21:00 | Return of Tracking Systems for reconnaissance        | Secretariat  |
| 20:00 – 23:00 | León Welcoming Cocktail (All Drivers)                | Explora Park |

## Thursday March 8<sup>th</sup>, 2018

|               |  |                       |
|---------------|--|-----------------------|
| 08:00 – 20:00 | Opening of Rally Secretariat & Official Notice Board | Rally Campus          |
| 08:00 – 24:00 | Opening of Media Centre                              | Rally Campus          |
| 08:00 – 18:00 | Opening of Media Accreditation                       | Media Centre          |
| 09:00 – 13:00 | Shakedown (P1)                                       | Llano Grande          |
| 11:00 – 13:00 | Shakedown (P2 & P3)                                  | Llano Grande          |
| 13:00 – 14:00 | Shakedown (Others)                                   | Llano Grande          |
| 13:30         | Pre-event FIA Press Conference                       | Media Centre          |
| 14:00 – 15:30 | Promotional activities                               | Rally Campus          |
| 16:00         | Publication of Start List for Sections 1 & 2         | Official Notice Board |
| 18:30         | Start of Section 1 (Start of Rally)                  | Rally Campus          |
| 20:00         | First car on start ramp, Ceremonial Start            | Guanajuato            |
| 20:00         | Helicopter pilots' briefing                          | HQ                    |

## Friday March 9<sup>th</sup>, 2018

|               |   |                       |
|---------------|---|-----------------------|
| 06:30 – 22:00 | Opening of Rally Secretariat            | Rally Campus          |
| 06:30 – 23:00 | Opening of Media Centre                 | Rally Campus          |
| 09:30         | Start of Section 2                      | Rally Campus          |
| 21:00         | Publication of Start List for Section 4 | Official Notice Board |

## Saturday March 10<sup>th</sup>, 2018

|               |  |                       |
|---------------|--|-----------------------|
| 07:30 – 22:00 | Opening of Rally Secretariat                         | Rally Campus          |
| 07:30 – 23:00 | Opening of Media Centre                              | Rally Campus          |
| 08:15         | Start of Section 4                                   | Rally Campus          |
| 20:36         | Final control for NACAM Classification (Control 19A) | Rally Campus          |
| 21:00         | Publication of Start List for Section 6              | Official Notice Board |

## Sunday March 11<sup>th</sup>, 2018

|               |   |                       |
|---------------|---|-----------------------|
| 07:00 – 18:00 | Opening of Rally Secretariat              | Rally Campus          |
| 07:00 – 19:00 | Opening of Media Centre                   | Rally Campus          |
| 07:30         | Start of Section 6                        | Rally Campus          |
| 14:30         | Finish Podium Ceremony – End of Rally     | Foro del Lago         |
| 15:15         | Final Scrutineering                       | Scrutineering Hall    |
| 15:30         | Post Event FIA Press Conference           | Media Centre          |
| 18:00         | Publication of Provisional Classification | Official Notice Board |

## Monday March 12<sup>th</sup>, 2018

|               |   |              |
|---------------|---|--------------|
| 09:00 – 13:00 | Opening of Media Centre (Only by request) | Rally Campus |
| 10:00 – 13:00 | Opening of Rally Secretariat              | Rally Campus |

## 4. ENTRIES

### 4.1. Closing Date for Entries

Competitors wishing to take part in the 2018 Rally Guanajuato México must submit their entry form duly completed before Tuesday, February 6<sup>th</sup>, 2018 at 18:00 hrs. (GMT - 6 hrs.).

### 4.2. Entry Procedure

Those wishing to take part in Rally Mexico 2018 must register and fill in the electronic entry form available at <https://registrations.fia.com/wrcmex> duly completed before the closing date for entries. The entry will only be accepted if accompanied by the total amount of the Entry Fee. To be accepted, competitors must send a proof of payment of the entry fee by e-mail to the secretary of the event ([entries@rallymexico.com](mailto:entries@rallymexico.com)) by the closing date of entries. Foreign drivers must submit an approval from their ASN in the same e-mail.

The entry application should be accompanied by:

- The total entry fee
- Photocopies of:
  - FIA Licence of the entrant and both members of the crew
  - Drivers Licence of the crew members
  - First page of the homologation papers of the car with the number, group and cylinder capacity

Manufacturers, WRC 2 and WRC 3 entrants who wish to score points, must make their entries by using the electronic standard rally entry form for their championships available in the FIA application at <https://registrations.fia.com>

**In the case the Driver and Entrant are the same person, both licences (Driver & Entrant) must be sent and presented at registration.**

### 4.3. NACAM Championship

Competitors wishing to enter Rally Guanajuato Corona as a NACAM Championship competitor, please refer to the NACAM Championship regulations and specific documentation for entries, fees and specific regulations.

## 4.5. Number of Entrants Accepted and Classes

### 4.5.1. Number of Entrants

The maximum number of entries is **60**. If more than 60 entries are received, the Organisers will create a reserve list.

Entry applications outside the FIA Championships (WRC, WRC 2, WRC 3 and NACAM Rally Championship) will be confirmed after the entry closing date.

The criteria for acceptance of entries will be in the following order:

Priority 1 Drivers, Priority 2 Drivers and Priority 3 Drivers

The Organisers reserve the right to accept all other entries according to the driver results and the capacity / conditions of the vehicle entered.

### 4.5.2. Accepted Cars & Classes

Cars are eligible to enter as stipulated in the Article 4.5 of the 2018 WRC Regulations. All vehicles must comply with the provisions of Appendix J 2018.

NACAM Championship eligible vehicles will be communicated in a Bulletin.

| CLASSES    | GROUPS  |
|------------|---|
| <b>RC1</b> | World Rally Cars: 1.6 T engine  |
| <b>RC2</b> | S2000-Rally: 1.6T engine with a 28mm restrictor   |
|            | S2000-Rally: 2.0 Atmospheric  |
|            | Group R5 (VR5)  |
|            | Group R4 (VR4)  |
|            | Group NR4 over 2000cc (current N4)  |
| <b>RGT</b> | RGT cars  |
| <b>RC3</b> | Group A over 1600cc and up to 2000cc  |
|            | Super 1600  |
|            | R2 (atmo over 1600cc and up to 2000cc – VR2C and turbo over 1067cc and up to 1333cc – VR2C)   |
|            | R3 (atmo / over 1600cc and up to 2000cc – VR3C and turbo over 1067cc and up to 1333cc – VR3C) |
|            | R3 (turbo / up to 1620cc / nominal – VR3T)  |
|            | R3 (diesel / up to 2000cc / nominal – VR3D)   |
| <b>RC4</b> | Group A up to 1600cc  |
|            | R2 (atmo over 1390cc and up to 1600cc – VR2B and turbo over 927cc and up to 1067cc – VR2B)    |
|            | Kit-car up to 1600cc  |
|            | Group N over 1600cc and up to 2000cc  |
| <b>RC5</b> | Group N up to 1600cc  |
|            | R1 (atmo up to 1600cc - VR1A/VR1B and turbo up to 1067cc - VR1A/VR1B)                         |

## 4.6. Entry Fees and Packages for Private Entrants

### Manufacturers, WRC 2 and WRC 3 entered in the FIA Championships:

Entry fees and packages for Manufacturers, additional cars serviced in Manufacturer's service areas by a Manufacturer, and Support Championships registered in the FIA Championships will be those published by the FIA. (2018 WRC Regulations, Appendix VI)

### Other Competitors:

#### With the optional advertising proposed by the Organisers:

|                                    |         |
|------------------------------------|---------|
| Mexican Entries*                   | € 1'500 |
| NACAM Rally Championship entries   | € 2'000 |
| Private Entries                    | € 2'900 |
| Legal Entries                      | € 4'400 |
| WRC Car Entry** (legal or private) | € 6'380 |

#### Without the optional advertising proposed by the Organisers:

|                                    |         |
|------------------------------------|---------|
| Mexican Entries*                   | € 2'890 |
| NACAM Rally Championship entries   | € 3'850 |
| Private Entries                    | € 4'400 |
| Legal Entries                      | € 6'380 |
| WRC Car Entry** (legal or private) | € 9'300 |

### Definitions:

**Legal Entrant:** When the competing car is entered by a team (not a Manufacturer), a company or other legal entity (with legal entrant's licence).

**Private Entrant:** When the competing car is entered by the driver or the co-driver.

\*Refers to the driver's nationality only

\*\*Not entered by a Manufacturer

## Other Fees:

|                                    |       |
|------------------------------------|-------|
| Reconnaissance Only Entry Fee:     | € 900 |
| Extra Auxiliary Plate:             | € 290 |
| Optional Shakedown (P2, P3, Non P) | € 290 |

The following table describes the contents of entry packages in addition to those stipulated in Appendix VI of the 2018 WRC Regulations:

|                       | NACAM Champ.       | Legal Entries      | Private Entries    |
|-----------------------|--------------------|--------------------|--------------------|
| <b>Vehicle Plates</b> |                    |                    |                    |
| Service plates        | 2                  | 2                  | 2                  |
| Auxiliary plates      | 0                  | 1                  | 0                  |
| VIP plates            | 1                  | 1                  | 0                  |
| <b>Services</b>       |                    |                    |                    |
| Area in Service Park  | 100 m <sup>2</sup> | 100 m <sup>2</sup> | 100 m <sup>2</sup> |
| WLAN                  | -                  | -                  | -                  |
| <b>Administration</b> |                    |                    |                    |
| Regulations           | 1 (1)              | 1 (1)              | 1 (1)              |
| Road Book Sets        | 3 (1)              | 3 (1)              | 2 (1)              |
| Rally Guide 1         | Website            | Website            | Website            |
| Rally Guide 2         | Website            | Website            | Website            |
| Route maps            | 4 (1)              | 5 (1)              | 3 (1)              |
| Programme             | 3                  | 5                  | 2                  |
| Results               | Website            | Website            | Website            |
| <b>Passes</b>         |                    |                    |                    |
| Team Passes           | 8                  | 10                 | 6                  |

( ) No. of copies of the total to be mailed or couriered to the Team Manager

## 4.7. Payment Details

---

Entry fees must be paid by way of a bank transfer to the organizer's bank account:

**Bank:** JP Morgan Chase  
**Account Name:** Rallymex  
**Account No:** 527023605  
**Bank Address:** 1299 4<sup>th</sup> Street  
 San Rafael, California  
 United States  
**ABA:** 322271627  
**SWIFT:** CHASUS33

**NOTE:** Please include the Team and Driver names on the wire transfer instructions to the recipient as to credit each account correctly.

National (Mexican) teams, please contact the rally secretariat for other payment options at +52 55 5259 6904

## 4.8. Refunds

---

Entry fees will be refunded in full only:

- To participants whose entry has been rejected
- In the case of the rally not taking place

Organisers may refund 30% of the entry fee to those competitors who were unable to start the rally for reason of "force majeure" as agreed by the Stewards (certified by their ASN).

## 5. INSURANCE

Competitors and crews (driver and co-driver) are covered for public liability under a master policy held by Rallymex S.A. de C.V. for \$ 10,000,000.00 U.S. Dollars revolving coverage for any one accident or instance. The coverage includes special stages as well as road sections. The coverage will come into effect at the start of the rally and will include the Shakedown. It will cease at the end of the event or at the moment of retirement or exclusion. Full details can be obtained upon request from the Organisers.

Service vehicles and reconnaissance vehicles, including those bearing official plates issued by the Organisers, may never be considered as official participants of the rally. Therefore, they are not covered under the insurance policy of the rally and will remain the sole responsibility of their owner.

Comprehensive vehicle insurance and personal accident insurance are the sole responsibility of the entrant / competitor. As per article 2.5 of the 2018 FIA World Rally Championship Sporting Regulations, international crews are required to "have taken out an international insurance policy covering their repatriation, if necessary, after an accident".

Proof of insurance for reconnaissance cars must be shown upon registration for reconnaissance. Liability and third-party insurance as a minimum are compulsory for all crews under Mexican law.

Insurance sales are available at the secretariat during reconnaissance registration.

## 6. ADVERTISING AND IDENTIFICATION

### Organisers Advertising

Rally Plates and Optional Advertising must be affixed on the car before scrutineering as shown in Appendix 4 of these regulations.

### Restrictions

The advertising of alcoholic beverages is limited according to the Mexican legislation to alcoholic beverages under 22% in volume. Such brand logos may appear on the competition and service vehicles, as well as on drivers' overalls during the event.

### Identification Numbers

The Organisers will issue Competition Numbers, according to Article 18 of the 2018 FIA WRC regulations. These Competition Numbers must be affixed on the car before pre-event scrutineering as shown in Appendix 4 of these regulations and must be visible throughout the duration of the rally.

## 7. TYRES

### 7.1. Tyres specified for use during the Rally

In addition to complying with Articles 60, 61 & 62, of the 2018 WRC Sporting Regulations, the following quantities and type of tyre are confirmed for use.

| DMACK                  |                                |                               |
|------------------------|--------------------------------|-------------------------------|
|                        | List 1 (WRC Art. 60.3.1)       | List 2 (WRC Art. 60.2.1)      |
| 1 <sup>ST</sup> Choice | 205/65 R15 DMG+22 GH44 (Left)  | 215/65 R15 DMG+2 GH34 (Left)  |
|                        | 205/65 R15 DMG+22 GH44 (Right) | 215/65 R15 DMG+2 GH34 (Right) |
| Alt. Choice            | 205/65 R15 DMG+22 GS64 (Left)  | 215/65 R15 DMG+2 GS84 (Left)  |
|                        | 205/65 R15 DMG+22 GS64 (Right) | 215/65 R15 DMG+2 GS84 (Right) |

| MICHELIN               |                              |                          |
|------------------------|------------------------------|--------------------------|
|                        | List 1 (WRC Art. 60.3.1)     | List 2 (WRC Art. 60.2.1) |
| 1 <sup>ST</sup> Choice | Latitude Cross H90 L (Left)  | LTX Force S5 L (Left)    |
|                        | Latitude Cross H90 R (Right) | LTX Force S5 R (Right)   |
| Alt. Choice            | Latitude Cross S80 L (Left)  | LTX Force H4 L (Left)    |
|                        | Latitude Cross S80 R (Right) | LTX Force H4 R (Right)   |

| PIRELLI                |   |                          |
|------------------------|---|--------------------------|
|                        | List 1 (WRC Art. 60.3.1)  | List 2 (WRC Art. 60.2.1) |
| 1 <sup>ST</sup> Choice | 205/65-15 K6 Reinforced (Left)<br>205/65-15 K6 Reinforced (Right) | N/A                      |
| Alt. Choice            | 205/65-15 K4 Reinforced (Left)<br>205/65-15 K4 Reinforced (Right) | N/A                      |

## 7.2. Quantity of Tyres

Tyres for all Drivers must comply with article 62.1 of the 2018 WRC Sporting Regulations.

| Type of Car    | Total for the entire event |
|----------------|----------------------------|
| WRC Cars       | 24                         |
| All other cars | 22                         |

## 8. FUEL

### 8.1. Ordering Procedure

All FIA Priority Drivers must use the FIA fuel. The supplier appointed by the FIA for 2018 is Panta Distribuzione S.p.A.

The order form issued by Panta with payment instructions is available on the event website: <https://www.rallymexico.com/en/documents-competitors/>

The cost of the fuel including refuel services is **€5.00** per litre (Excl. taxes), dispensed into rally cars.

It is a condition of supply that payment must be received in full before delivery can be made. The balance of non-used fuel will be credited after the rally.

### 8.2. Closing Date for Ordering FIA Fuel

All competitors using FIA fuel must place their fuel order directly with Panta no later than Wednesday January 23<sup>rd</sup>, 2018. The order form must be e-mailed to [fuelorder@panta.it](mailto:fuelorder@panta.it) or faxed to +39 0373-235123

### 8.3. Fuel Distribution

Non-Priority drivers may use either FIA fuel, following the same conditions and rules as the Priority Drivers, or commercially available pump fuel, dispensed directly into competing cars from pumps at filling stations nominated in the Road Book or when distributed from a centralised system by the organiser where filling stations are not available.

Refuel and Remote Refuel zones are as detailed in the Rally Itinerary.

For environmental and safety reasons, no refuelling is allowed in the Service Park (no refuel from cans, drums or similar) except if authorised as by Art 50 of the 2018 WRC Regulations.

### 8.4. Refueling

All drivers must comply with article 59.3.7 of the 2018 WRC Sporting Regulations.

## 9. RECONNAISSANCE

### 9.1. Registration Procedure

- 9.1.1. All entrants taking part in the reconnaissance must register at the Rally Secretariat to get all the necessary documentation before starting reconnaissance. Registration for reconnaissance can be completed according to the following schedule:

|                               |               |
|-------------------------------|---------------|
| Monday March 5 <sup>th</sup>  | 08:00 – 22:00 |
| Tuesday March 6 <sup>th</sup> | 07:00 – 20:00 |

For priority 1 drivers, a team member duly designated can collect the materials. Other crews must register in person.

- 9.1.2. The reconnaissance ID sticker supplied during registration must be attached onto the reconnaissance car on the inside of the windshield (co-driver's side) and must be visible for the duration of the reconnaissance period.

### 9.2. Specific Restrictions

- 9.2.1. On special stages, the speed limit is 90 km/h unless traffic signs or lower limit zones are indicated in the reconnaissance Road Books. Additional lower limit zones may be issued before the start of reconnaissance. Competitors are reminded that stages will be open to normal traffic during reconnaissance and that they must drive in a manner that does not endanger or inconvenience other traffic or people living near the stages.
- 9.2.2. The maximum number of passengers on each special stage for reconnaissance is limited to two per entered crew. This is controlled by means of a Reconnaissance ID Sticker and a Reconnaissance Card which must be shown at the SS Start, SS Finish and if requested, to Reconnaissance Control Crews along the route.
- 9.2.3. All stages driven more than once in the rally will be considered as one stage for reconnaissance purposes.
- 9.2.4. For reconnaissance, only two passages will be allowed on each lane of the Super Special Stage.
- 9.2.5. Under no circumstances may crews drive in the opposite direction of the rally in the special stages according to the schedule, unless directed by the Organisers or authorities. Entering and leaving the special stage elsewhere than through Start and Finish controls is prohibited.
- 9.2.6. Special ID stickers will be issued for service vehicles used during reconnaissance as per WRC Reg. Art. 25.4.6.

### 9.3. Speed control checking devices

All crews will be required to use a special system for controlling the speed throughout reconnaissance by means of GPS.

This tracking system will be handed out at the Rally Secretariat.

The equipment will be available for collection at the Secretariat on Monday March 5<sup>th</sup> between 16:00 and 18:00. The equipment must be returned at the Rally Secretariat on Wednesday March 7<sup>th</sup> between 19:00 and 21:00 hrs.

## 10. ADMINISTRATIVE CHECKS

Administrative checks will take place at the rally secretariat following the specified schedule (Art. 3 of these regulations). All competitors must pass administrative checks before proceeding to pre-event scrutineering.

### 10.1. Documents to be Presented

The following documents will be checked:

- FIA licence of the entrant and both members of the crew
- Valid Driver's Licence for both members of the crew
- Driver and Co-Driver passport or Identification
- ASN Stamp or letter of authorisation for foreign competitors
- Information given in the entry form

### 10.2. Timetable

|               |                               |                   |
|---------------|-------------------------------|-------------------|
| 16:00 – 22:00 | Monday March 5 <sup>th</sup>  | All Competitors   |
| 08:00 – 20:00 | Tuesday March 6 <sup>th</sup> | P1 by appointment |
| 08:00 – 20:00 | Tuesday March 6 <sup>th</sup> | All Competitors   |

## 11. SCRUTINEERING, SEALING AND MARKING

Before pre-event scrutineering, competition numbers, rally plates and optional advertising, if accepted, must be affixed on the car.

### 11.1. Scrutineering Venue and Timetable

11.1.1. Sealing of parts and delivery of Scrutineering Certificates for Manufacturer cars will be held in each individual team service areas from 10:00 to 13:30 on Wednesday March 7<sup>th</sup> following a schedule published in a bulletin.

11.1.2. Checking of the Weight for Manufacturer cars will take place on Wednesday March 7<sup>th</sup> from 12:00 to 14:00.

11.1.3. Priority 2, Priority 3 & Others.

Sealing and marking of components will be performed during Pre-event Scrutineering starting at 15:00 Hrs on Wednesday March 7<sup>th</sup> in the Scrutineering Hall in Rally Campus according to a specified schedule drawn up and published in a bulletin before the event.

### 11.2. Transverse Mud Flaps

The use of Transverse Mud Flaps is mandatory as per Art. 252.7.7 of Appendix J of the FIA Sporting Code – Mud flaps.

### 11.3. Windows / Nets

The use of tinted or silvered windows, according to Appendix J, Art 253 Art 11, is authorized. Silvered or tinted films fitted on front side windows must have an opening equivalent to a circle of 70mm diameter in order to allow the occupants / content of the car to be seen.

### 11.4. Driver's Safety Equipment

Although drivers are not required to be present, all items of clothing and equipment in compliance with Appendix L Chapter III -including helmets and FHR (Frontal Head Restrain) intended to be used - must be presented during scrutineering.

## 12. OTHER PROCEDURES

### 12.1. Ceremonial Start Procedure and Order

The start of the rally (TC0) will take place at the Rally Campus Service OUT control on Thursday March 8<sup>th</sup>, 2018 starting at 18:15 hrs. There will be no holding area prior to the start of the rally. Competitors must check in at TC 0 at their published start times. Section 1 Time Cards can be collected at the TC 0 Control table 15 minutes before the first car is due.

From TC0 competitors will proceed to Silao, where a pre-start ceremony will take place between TC 0A and TC 0B. From there they will proceed to TC 1. There will be no escort for competitors to enter Guanajuato.

The ceremonial start will take place after the STOP control of SS1, at the “Alhondiga de Granaditas” in Guanajuato, after the “Street Stage GTO”. The start interval will be 3 minutes for all competitors in section 1. The start order for the ceremonial start and until the overnight park fermé (Section 1, TC 1A) will be at the discretion of the organizers in the interest of spectators and television. The start order will be as WRC Art. 45.2 for the rest of the rally.

### 12.2. Time Card Changes during the Rally

Time Cards will be issued or changed at the following time controls for the start of each section:

TC 0, TC 1B, TC 5B, TC 10D, TC 13B, TC 19B, TC 21B

### 12.3. Finish Procedure

The rally will end at Time Control TC 22C (Service H Out - Finish Area In) After this control a pre-finish holding area will be established and crews will be directed to the podium in the specified order outlined in Appendix IV of the WRC regulations at the appropriate times.

### 12.4. Permitted Early Check-In

Competitors are allowed to check in early without incurring a penalty at:

- “Overnight Regroup IN” control (TC 1A and 19A)
- “Flexi-Service OUT - Parc Fermé IN” controls (TC 10C and TC 18C)

## 12.5. Super Special Stage Procedure and Running Order

On SS 9/10 and 17/18, cars will run two at a time. At the start of stages 9 and 17, the two cars will be placed side by side in separate lanes, A and B. The first car entering the start area will be directed to lane A, the second to lane B. After completing the stages, the cars will be immediately directed to the starting gate, switch lanes and start stages 10 and 18 respectively.

The Organisers may, at their discretion, pair drivers on the stage in the interest of the spectators and television. This pairing may change the running order of the day. On Friday, there will be a 30-minute holding area between the Time Control and the first Stage Start where any changes in running order will be made. On Saturday, the holding time will be 20 minutes. The running order established from this point will remain the same throughout the remainder of the section. Refer to Rally Guide 2 for procedure diagrams.

There will not be a Time Control between special stages 9 & 10 in Section 3 and stages 17 & 18 in Section 5. Therefore, these stages will be considered as two parts of a single Super Special Stage. The road section between the finish of the first stage of the pair and the start of the second stage is enclosed within the control area and considered as Parc Fermé (WRC Reg. 2.10) where no repairs or assistance may take place.

Any crew unable to complete any of the Super Special Stages will be penalised as stipulated in Art. 46.2 of the 2018 WRC Regulations.

Should a car fail to complete any of the Super Special Stages within **4** minutes from his stage start time, the Organisers will **immediately** remove it to the road section after the STOP control. In this case, the competitor will be allocated a time of 4 minutes for each Super Special Stage that was not completed within the allowed time. If the competitor fails to complete the first stage of the Super Special in the allowed time, he may be allowed to start the second part of the Super Special Stage at the officials' discretion.

If the running of the Super Special Stage is interrupted, this will be signalled to the drivers by red flags shown by properly identified marshals.

When given this signal, the driver must immediately reduce speed and follow the instructions of the marshals or other officials. Failure to comply with this rule will entail a penalty at the discretion of the Stewards. (Article 40.5.3 of the 2018 WRC Regulations).

If the display of the red flags is caused by one of the two cars blocking the stage or delaying the other competitor, the provisions of WRC Regulations Article 39 will apply.

## 12.6. Special Procedures / Activities

A spectator autograph session will be organised for 30 minutes during the Regroup between 21A and 21B. All priority drivers are required to attend.

## 12.7. Official Time used during the Rally

### Start Intervals

The start intervals between all cars from the start of Section 2, and for the remainder of the rally, will be 3 minutes.

### Time

The official time throughout the rally will be that of the NIST Stations WWV and WWVB in Fort Collins, Colorado, USA, which can be found at <http://nist.time.gov>, and different shortwave frequencies, synchronised to the local hour of León, (GMT -6, U.S. Central Time Zone).

## 12.8. Re-start after retirement – Rally 2

Restart after retirement is permitted as stipulated under Art. 46 of the 2018 WRC Regulations.

## 12.9. Power Stage

There will be an 80 minute regroup before the start of the Power Stage (SS 22), as live TV coverage will be carried out (WRC Regs Art 13.3.2).

## 12.10. End of Power Stage

For the purpose of Live TV there will be interviews at the STOP control of the stage. The Organizers, in conjunction with WRC Promoter, may stop any car and its crew on the road section after the STOP control of the stage, so that they can take part in media interviews and a made-for-TV podium ceremony. These crews will be directed by officials after the STOP control of the stage. If necessary, additional time for the road section to TC 22A will be given by an official at this location on the time card.

## 12.11. NACAM Classification

NACAM Championship classification will start at Time Control 0 up to Time Control 13A.

Specific regulations and eligible vehicles will be published in a bulletin.

## 12.12. On Board Cameras

As per article 65.1 of the WRC Regulations the entrant of any car, which carries an on-board camera, must have the prior agreement of the Promoter.

Authorized cameras will be identified by an adhesive decal and must be mounted in the car at the time of scrutineering.

Competitors wishing to use a camera must supply the following information to the Promoter ([accreditation@wrc.com](mailto:accreditation@wrc.com)) at least one week before the start of reconnaissance: Entrant name, car number, entrant address and intended use of footage.

## 13. IDENTIFICATION OF OFFICIALS

The post chiefs will be identified as follows:

|                       |   |
|-----------------------|---|
| Stage Commander:      | Blue Tabard                             |
| Stage Safety Officer: | Green Tabard / Yellow Reflective Tabard |
| Doctor/Medic:         | White overall with "Doctor" legend      |
| Scrutineering:        | Purple overall                          |
| CRO:                  | Red Jacket with "CRO" legend            |
| Control Officials:    | Orange Tabard                           |
| Safety Marshals:      | Yellow Tabards                          |

## 14. PRIZES

Trophies will be awarded as follows:

- **Winning Manufacturer:** 1<sup>st</sup> One Trophy
- **Overall Classification:** 1<sup>st</sup>, 2<sup>nd</sup>, 3<sup>rd</sup>, 4<sup>th</sup> and 5<sup>th</sup> Two Trophies
- **FIA WRC 2 Classification:** 1<sup>st</sup>, 2<sup>nd</sup> and 3<sup>rd</sup> Two Trophies
- **FIA WRC 3 Classification:** 1<sup>st</sup>, 2<sup>nd</sup> and 3<sup>rd</sup> Two Trophies
- **FIA NACAM Rally Champ. Classification:** 1<sup>st</sup>, 2<sup>nd</sup> and 3<sup>rd</sup> Two Trophies
- **Class Classification as WRC Art. 4.4:** 1<sup>st</sup> : Two Trophies
- **Bernard Audibert Cup:** Two cups awarded to the best all Mexican classified crew (driver and co-driver).

- **Note:** Other contingency prizes may be awarded.

## 15. FINAL CHECKS AND PROTESTS

### 15.1. Final Checks

- 15.1.1. Post event scrutineering will be held on Sunday March 11<sup>th</sup> starting at 15:15 hrs in the Scrutineering Hall in Rally Campus.
- 15.1.2. Those crews selected by the Stewards for final scrutineering will be notified by the clerk of the course and are required to provide the proper equipment and technicians in the Scrutineering Hall in Rally Campus.

### 15.2. Protest Fees

The amount of the protest fee is: €1,000.

If the protest requires the dismantling and the re-assembling of different parts of a car, the claimant must pay an additional deposit.

The expenses incurred by the work and transport of the car shall be borne by the claimant if the protest is unfounded, or by the competitor against whom the protest is lodged if the claim is upheld.

If the protest is unfounded, and if the expenses incurred by the protest (scrutineering, transport, etc) are higher than the deposit amount, the difference shall be borne by the claimant. Conversely, if the expenses are less, the difference shall be returned to them.

### 15.3. Appeal Deposit

- Sum of the international appeal deposit: € 6,000.

## APPENDIX 1 – PROVISIONAL ITINERARY

### Thursday March 8th

| T.C.                    | Location                             | Distances |         |         | Target Time | 1st Car Due |
|-------------------------|--------------------------------------|-----------|---------|---------|-------------|-------------|
|                         |                                      | S.S.      | Liaison | Total   |             |             |
| SP                      | Service Park Out - Rally Campus León |           |         |         |             |             |
| RZ-0                    | To next Refuel Zone                  | (5.31)    | (32.52) | (37.83) |             |             |
| SD                      | Llano Grande                         |           | (16.67) | (16.67) | (0:30)      |             |
| SD                      | <b>Shakedown</b>                     | (5.31)    |         |         |             | (9:00)      |
| SP                      | Service Park IN                      |           | (15.85) | (21.16) | (0:45)      |             |
| <b>Shakedown Totals</b> |                                      | (5.31)    | (32.52) | (37.83) |             |             |

Shakedown

Version 2

### Thursday March 8th (Start of Rally)

| T.C.                   | Location  | Distances |         |        | Target Time | 1st Car Due |
|------------------------|---|-----------|---------|--------|-------------|-------------|
|                        |   | S.S.      | Liaison | Total  |             |             |
| 0                      | Start of Rally - Rally Campus León              |           |         |        |             | 18:15       |
| RZ-1                   | To next Refuel Zone                             | 2.53      | 113.03  | 115.56 |             |             |
| 0A                     | Silao Square IN                                 |           | 34.57   | 34.57  | 0:50        | 19:05       |
| 0B                     | Silao Square OUT                                |           | 0.19    | 0.19   | 0:15        | 19:20       |
| 1                      | Teatro Juárez                                   |           | 23.00   | 23.00  | 0:40        | 20:00       |
| SS 1                   | <b>Monster Street Stage GTO</b>                 | 2.53      |         |        |             | 20:08       |
| 1A                     | Overnight Regroup IN (Early Check-in permitted) |           | 55.27   | 57.80  | 1:30        | 21:38       |
| <b>Thursday Totals</b> |   | 2.53      | 113.03  | 115.56 |             |             |

Section 1

Version 2

## Friday March 9th

| T.C.                 | Location                             | Distances  |                 |                 | Target Time | 1st Car Due  |
|----------------------|--------------------------------------|--|-----------------|-----------------|-------------|--------------|
|                      |                                      | S.S.   | Liaison         | Total           |             |              |
| 1B                   | Overnight Regroup OUT - Service A IN |  |                 |                 |             | 9:30         |
| <b>SP-A</b>          | <b>Rally Campus Service Park</b>     | <b>(2.53)</b>  | <b>(78.27)</b>  | <b>(80.80)</b>  | <b>0:15</b> |              |
| 1C                   | Service A OUT                        |  |                 |                 |             | 9:45         |
| <b>RZ-2</b>          | <b>To next Refuel Zone</b>           | <b>26.05</b>   | <b>41.21</b>    | <b>67.26</b>    |             |              |
| 2                    | Las Coloradas                        |  | 30.08           | 30.08           | 0:45        | 10:30        |
| <b>SS 2</b>          | <b>Duarte - Derramadero 1</b>        | <b>26.05</b>   |                 |                 |             | <b>10:33</b> |
|                      | Refuel All (Cuestecita)              |  | (11.13)         | (37.18)         |             |              |
| <b>RZ-3</b>          | <b>To next Refuel Zone</b>           | <b>49.78</b>   | <b>74.03</b>    | <b>123.81</b>   |             |              |
| 3                    | Cuestecita                           |  | 11.69           | 37.74           | 0:45        | 11:18        |
| <b>SS 3</b>          | <b>El Chocolate 1</b>                | <b>31.44</b>   |                 |                 |             | <b>11:21</b> |
| 4                    | El Zorrillo                          |  | 7.33            | 38.77           | 0:50        | 12:11        |
| <b>SS 4</b>          | <b>Ortega 1</b>                      | <b>17.23</b>   |                 |                 |             | <b>12:14</b> |
| 5                    | Rally Campus León                    |  | 65.09           | 82.32           | 1:45        | 13:59        |
| <b>SS 5</b>          | <b>Street Stage León 1</b>           | <b>1.11</b>  |                 |                 |             | <b>14:02</b> |
| 5A                   | Tech Zone IN - Regroup IN            |  | 1.05            | 2.16            | 0:20        | 14:22        |
| 5B                   | Regroup OUT - Service B IN           |  |                 |                 | 0:20        | 14:42        |
| <b>SP-B</b>          | <b>Rally Campus Service Park</b>     | <b>(75.83)</b>   | <b>(115.24)</b> | <b>(191.07)</b> | <b>0:30</b> |              |
| 5C                   | Service B OUT                        |  |                 |                 |             | 15:12        |
| <b>RZ-4</b>          | <b>To next Refuel Zone</b>           | <b>26.05</b>   | <b>41.21</b>    | <b>67.26</b>    |             |              |
| 6                    | Las Coloradas                        |  | 30.08           | 30.08           | 0:45        | 15:57        |
| <b>SS 6</b>          | <b>Duarte - Derramadero 2</b>        | <b>26.05</b>   |                 |                 |             | <b>16:00</b> |
|                      | Refuel All (Cuestecita)              |  | (11.13)         | (37.18)         |             |              |
| <b>RZ-5</b>          | <b>To next Refuel Zone</b>           | <b>53.27</b>   | <b>77.99</b>    | <b>131.26</b>   |             |              |
| 7                    | Cuestecita                           |  | 11.69           | 37.74           | 0:45        | 16:45        |
| <b>SS 7</b>          | <b>El Chocolate 2</b>                | <b>31.44</b>   |                 |                 |             | <b>16:48</b> |
| 8                    | El Zorrillo                          |  | 7.33            | 38.77           | 0:50        | 17:38        |
| <b>SS 8</b>          | <b>Ortega 2</b>                      | <b>17.23</b>   |                 |                 |             | <b>17:41</b> |
| 8A                   | LFZ IN                               |  | 53.96           | 71.19           | 1:45        | 19:26        |
| 8B                   | LFZ OUT                              |  |                 |                 | 0:15        | 19:41        |
| 9                    | Autódromo de León                    |  | 1.22            | 1.22            | 0:05        | 19:46        |
| <b>SS 9</b>          | <b>SSS Autódromo de León 1</b>       | <b>2.30</b>  |                 |                 |             | <b>20:06</b> |
| <b>SS 10</b>         | <b>SSS Autódromo de León 2</b>       | <b>2.30</b>  |                 |                 |             | <b>20:11</b> |
| 10A                  | Tech Zone IN - Parc Fermé IN         |  | 14.92           | 17.22           | 1:15        | 21:26        |
| 10B                  | Parc Fermé OUT - Flexi-Service C IN  |  |                 |                 |             |              |
| <b>SP-C</b>          | <b>Rally Campus Service Park</b>     | <b>(79.32)</b>   | <b>(119.20)</b> | <b>(198.52)</b> | <b>0:45</b> |              |
| 10C                  | Flexi-Service C OUT - Parc Fermé IN  | For classified cars, except re-starting crews, 10C closes at |                 |                 |             | 0:00         |
| <b>Friday Totals</b> |                                      | <b>155.15</b>  | <b>234.44</b>   | <b>389.59</b>   |             |              |

Section 2

Section 3

Version 2

Saturday March 10th

| T.C.                   | Location  | Distances      |                 |                 | Target Time | 1st Car Due  |
|------------------------|---|----------------|-----------------|-----------------|-------------|--------------|
|                        |   | S.S.           | Liaison         | Total           |             |              |
| 10D                    | Overnight Regroup OUT - Service D IN            |                |                 |                 |             | 7:30         |
| <b>SP-D</b>            | <b>Rally Campus Service Park</b>                | <b>(0.00)</b>  | <b>(0.00)</b>   | <b>(0.00)</b>   | <b>0:15</b> |              |
| 10E                    | Service D OUT                                   |                |                 |                 |             | 7:45         |
| <b>RZ-6</b>            | <b>To next Refuel Zone</b>                      | <b>30.97</b>   | <b>39.12</b>    | <b>70.09</b>    |             |              |
| 11                     | Guanajuatito                                    |                | 27.43           | 27.43           | 0:45        | 8:30         |
| <b>SS 11</b>           | <b>Guanajuatito 1</b>                           | <b>30.97</b>   |                 |                 |             | <b>8:33</b>  |
|                        | Refuel Ali (Alfaro)                             |                | (11.69)         | (42.66)         |             |              |
| <b>RZ-7</b>            | <b>To next Refuel Zone</b>                      | <b>36.35</b>   | <b>57.92</b>    | <b>94.27</b>    |             |              |
| 12                     | Sauz Seco                                       |                | 29.45           | 60.42           | 1:35        | 10:08        |
| <b>SS 12</b>           | <b>Otates 1</b>                                 | <b>26.37</b>   |                 |                 |             | <b>10:11</b> |
| 13                     | La Estancia                                     |                | 8.33            | 34.70           | 0:40        | 10:51        |
| <b>SS 13</b>           | <b>El Brinco 1 (Live TV)</b>                    | <b>9.98</b>    |                 |                 |             | <b>11:08</b> |
| 13A                    | Tech Zone IN - Regroup IN                       |                | 31.83           | 41.81           | 1:20        | 12:28        |
| 13B                    | Regroup OUT - Service E IN                      |                |                 |                 | 0:20        | 12:48        |
| <b>SP-E</b>            | <b>Rally Campus Service Park</b>                | <b>(67.32)</b> | <b>(97.04)</b>  | <b>(164.36)</b> | <b>0:30</b> |              |
| 13C                    | Service E OUT                                   |                |                 |                 |             | 13:18        |
| <b>RZ-8</b>            | <b>To next Refuel Zone</b>                      | <b>30.97</b>   | <b>39.12</b>    | <b>70.09</b>    |             |              |
| 14                     | Guanajuatito                                    |                | 27.43           | 27.43           | 1:00        | 14:18        |
| <b>SS 14</b>           | <b>Guanajuatito 2</b>                           | <b>30.97</b>   |                 |                 |             | <b>14:21</b> |
|                        | Refuel Ali (Alfaro)                             |                | (11.69)         | (42.66)         |             |              |
| <b>RZ-9</b>            | <b>To next Refuel Zone</b>                      | <b>42.06</b>   | <b>59.52</b>    | <b>101.58</b>   |             |              |
| 15                     | Sauz Seco                                       |                | 29.45           | 60.42           | 1:30        | 15:51        |
| <b>SS 15</b>           | <b>Otates 2</b>                                 | <b>26.37</b>   |                 |                 |             | <b>15:54</b> |
| 16                     | La Estancia                                     |                | 8.33            | 34.70           | 0:35        | 16:29        |
| <b>SS 16</b>           | <b>El Brinco 2 (Live TV)</b>                    | <b>9.98</b>    |                 |                 |             | <b>16:38</b> |
| 17                     | Autodromo León                                  |                | 21.88           | 31.86           | 0:40        | 17:18        |
| <b>SS 17</b>           | <b>SSS Autódromo de León 3</b>                  | <b>2.30</b>    |                 |                 |             | <b>17:38</b> |
| <b>SS 18</b>           | <b>SSS Autódromo de León 4</b>                  | <b>2.30</b>    |                 |                 |             | <b>17:43</b> |
| 18A                    | Tech Zone IN - Parc Fermé IN                    |                | 14.92           | 17.22           | 0:50        | 18:33        |
| 18B                    | Parc Fermé OUT - Flexi-Service F IN             |                |                 |                 |             |              |
| <b>SP-F</b>            | <b>Rally Campus Service Park</b>                | <b>(71.92)</b> | <b>(102.01)</b> | <b>(173.93)</b> | <b>0:45</b> |              |
| 18C                    | Flexi-Service F OUT - Parc Fermé IN             |                |                 |                 |             |              |
| 18D                    | Parc Fermé OUT                                  |                |                 |                 | 1:45        | 20:18        |
| 19                     | Rally Campus León                               |                | 0.10            | 0.10            | 0:05        | 20:23        |
| <b>SS 19</b>           | <b>Street Stage León 2</b>                      | <b>1.11</b>    |                 |                 |             | <b>20:26</b> |
| 19A                    | Overnight Regroup IN (Early Check-in permitted) |                | 1.05            | 2.16            | 0:10        | 20:36        |
| <b>Saturday Totals</b> |   | <b>140.35</b>  | <b>200.20</b>   | <b>340.55</b>   |             |              |

Version 2

Section 4

Section 5

Sunday March 11th

| T.C.                 | Location                               | Distances      |                 |                 | Target Time | 1st Car Due  |
|----------------------|--|----------------|-----------------|-----------------|-------------|--------------|
|                      |  | S.S.           | Liaison         | Total           |             |              |
| 19B                  | Overnight Regroup OUT - Service G IN   |                |                 |                 |             | 7:15         |
| <b>SP-G</b>          | <b>Rally Campus Service Park</b>       | <b>(1.11)</b>  | <b>(1.15)</b>   | <b>(2.26)</b>   | <b>0:15</b> |              |
| 19C                  | Service G OUT                          |                |                 |                 |             | 7:30         |
| <b>RZ-10</b>         | <b>To next Refuel Zone</b>             | <b>24.32</b>   | <b>42.20</b>    | <b>66.52</b>    |             |              |
| 20                   | Sauz Seco                              |                | 21.03           | 21.03           | 0:45        | 8:15         |
| <b>SS 20</b>         | <b>Alfaro</b>                          | <b>24.32</b>   |                 |                 |             | <b>8:18</b>  |
|                      | Refuel All (Cuestecita)                |                | (34.42)         | (45.49)         |             |              |
| <b>RZ-11</b>         | <b>To Final Parc Fermé</b>             | <b>22.14</b>   | <b>121.52</b>   | <b>143.66</b>   |             |              |
| 21                   | San Nicolas                            |                | 71.88           | 96.20           | 1:47        | 10:05        |
| <b>SS 21</b>         | <b>Las Minas (Live TV)</b>             | <b>11.07</b>   |                 |                 |             | <b>10:08</b> |
| 21A                  | Guanajuato Regroup IN - Tech Zone IN   |                | 0.35            | 11.42           | 0:15        | 10:23        |
| 21B                  | Guanajuato Regroup OUT                 |                |                 |                 | 1:20        | 11:43        |
| 22                   | San Nicolas                            |                | 13.44           | 13.44           | 0:32        | 12:15        |
| <b>SS 22</b>         | <b>Las Minas Power Stage (Live TV)</b> | <b>11.07</b>   |                 |                 |             | <b>12:18</b> |
| 22A                  | Tech Zone IN                           |                | 57.02           | 68.09           | 1:30        | 13:48        |
| 22B                  | Tech Zone OUT - Service H IN           |                |                 |                 | 0:05        | 13:53        |
| <b>SP-H</b>          | <b>Rally Campus Service Park</b>       | <b>(46.46)</b> | <b>(163.72)</b> | <b>(210.18)</b> | <b>0:10</b> |              |
| 22C                  | Service H OUT - Finish Area IN         |                |                 |                 |             | 14:03        |
|                      | Finish Podium                          |                | (1.00)          | (1.00)          |             | 14:30        |
|                      | Parc Fermé                             |                | (1.00)          | (1.00)          |             |              |
| <b>Sunday Totals</b> |  | <b>46.46</b>   | <b>163.72</b>   | <b>210.18</b>   |             |              |

Section 6

Section 7

Version 2

## APPENDIX 2 – PROVISIONAL RECONNAISSANCE SCHEDULE

### P1 and WR Cars

| SS            | Name                  | From  | To    | Window |
|---------------|-----------------------|-------|-------|--------|
| Tue           |                       |       |       |        |
| 3/7 + 4/8     | El Chocolate + Ortega | 7:00  | 10:30 | 3:30   |
| 21/22         | Las Minas             | 8:00  | 12:30 | 4:30   |
| 12/15 + 13/16 | Otates + Brinco       | 11:45 | 15:45 | 4:00   |
| 9/10/17/18    | SSS Autodromo Leon    | 14:00 | 16:30 | 2:30   |
| SD            | Shakedown             | 14:30 | 16:30 | 2:00   |
| 5/19          | Street Leon           | 15:30 | 17:30 | 2:00   |
| Wed           |                       |       |       |        |
| 2/6           | Duarte x2             | 7:00  | 10:30 | 3:30   |
| 1             | SSS GTO               | 9:45  | 12:30 | 2:45   |
| 11/14         | Guanajuatito x2       | 11:00 | 15:30 | 4:30   |
| 20            | Alfaro x2             | 13:00 | 17:00 | 4:00   |

### P2, P3 and Others

| SS            | Name                  | From  | To    | Window |
|---------------|-----------------------|-------|-------|--------|
| Tue           |                       |       |       |        |
| 3/7 + 4/8     | El Chocolate + Ortega | 7:30  | 11:00 | 3:30   |
| 21/22         | Las Minas             | 8:30  | 13:00 | 4:30   |
| 12/15 + 13/16 | Otates + Brinco       | 12:15 | 16:15 | 4:00   |
| 9/10/17/18    | SSS Autodromo Leon    | 14:30 | 17:00 | 2:30   |
| SD            | Shakedown             | 15:00 | 17:00 | 2:00   |
| 5/19          | Street Leon           | 16:00 | 18:00 | 2:00   |
| Wed           |                       |       |       |        |
| 2/6           | Duarte x2             | 7:30  | 11:00 | 3:30   |
| 1             | SSS GTO               | 10:15 | 13:00 | 2:45   |
| 11/14         | Guanajuatito x2       | 11:30 | 16:00 | 4:30   |
| 20            | Alfaro x2             | 13:30 | 17:30 | 4:00   |

\*The SSS start will not be given to different priority groups on the same run as time schedules overlap.

## APPENDIX 3 – COMPETITORS' RELATIONS OFFICERS



Ernesto Bachtold  
cro@rallymexico.com  
Spanish – English – German

The Competitors' Relations office is located in the Service Park next to the Rally Secretariat.

A detailed schedule of the CRO activities will be published on the Bulletin Board.

## APPENDIX 4 – COMPETITION NUMBERS AND ADVERTISING

Size and colours for the competition numbers will follow Article 18 of the 2018 FIA WRC Regulations. The competition numbers and the optional advertising must be affixed according to the following diagram:

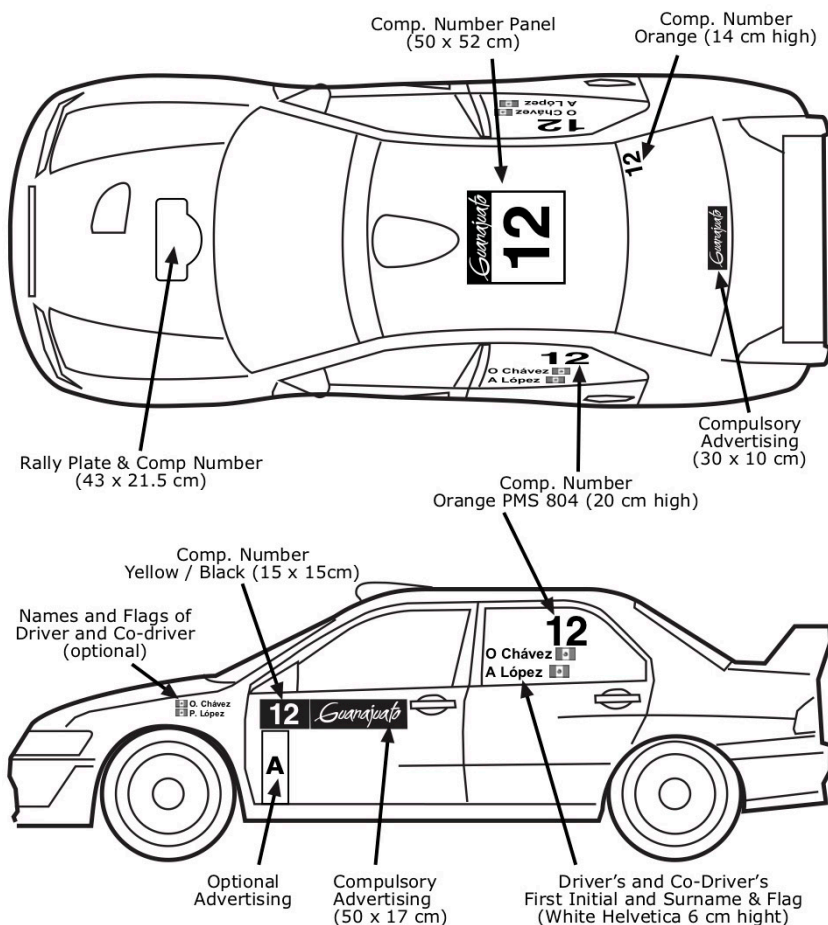

**A:** Optional Advertising (15x35cm vertical).

*Optional advertising will be announced in a bulletin.*

## APPENDIX 5 - SAFETY REQUIREMENTS

All the entrants and drivers are reminded of the Appendix L to the 2018 FIA International Sporting Code, in particular regarding Chapter III – Drivers' Equipment (helmets, flame-resistant clothing, frontal head restraint (FHR) and safety belts).

Clothing comprising overalls, gloves (optional for co-drivers), long underwear, balaclavas, socks and shoes must be homologated to FIA 8856-2000.

These regulations also apply to the Shakedown stage.

## APPENDIX 6 – SAS – SAFETY TRACKING SYSTEM

### SAS Fitting Kit Manual – RALLY CAR

#### **\*\*Product Disclaimer\*\***

*"This manual, the specifications, and the material contained in it, as released by Status Awareness Systems and RallySafe, is for the purpose of information only. Due to continuous ongoing development, information and specifications may change at any time without notice. RallySafe, and the companies that have contributed to it, shall not be liable for any use of the manual or information supplied.*

*The material contained in this manual is protected by copyright and other types of Intellectual Property Rights. The commercial exploitation of the material contained in this specification requires a license to such Intellectual Property Rights.*

*This manual may be utilised or reproduced without any modification, in any form or by any means, for informational purposes only. For any other purpose, no part of the specification may be utilised or reproduced, in any form or by any means, without permission in writing from RallySafe.*

*The word RallySafe and the RallySafe logo are registered trademarks"*

### Fitting Kit Components

The RallySafe Kit includes:

- RallySafe Installation and Fitting Kit Instruction Sheet;
- 3-in-1 antenna with leads;
- Internal radio antenna with lead;
- 6 – 24v wiring loom with plug;
- Mount, to be bolted to tunnel;
- Adjustable mount connector/knuckle.



(Contents may differ slightly to image shown)

## 12 Volt Power Supply (Please read carefully)

RallySafe requires a reliable power supply from 9 to 28 volts DC. We recommend a 5 amp (Max) blade type or similar quality fuse is used at the battery supply end of the RallySafe power lead.

**Zero volts or battery negative can be picked up at any suitable earthing point providing the isolation switch does not switch the negative side of the battery.**

The RallySafe unit has an internal battery that is kept charged via the car's power supply. It acts as a reserve supply to power the unit in the case of an accident where a car's power supply is interrupted. i.e. car battery smashed or dislodged.

In the yellow power loom there are 5 wires. **White blue and grey must be stagger cut and heat shrinked or taped back so they can't short to ground or to each other.** Red and black are used as follows:

## Connection Diagram

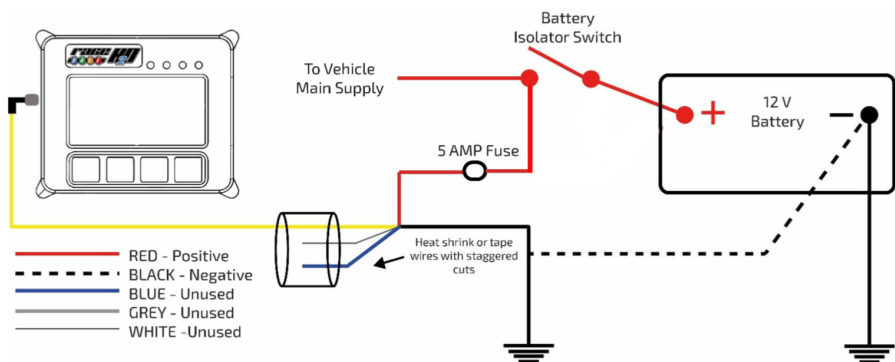

RALLYSAFE 12V WIRING DIAGRAM

## Unit Mounting & Dimensions

For mounting the RallySafe unit is a RAM style 50mm x 75mm flat base with ball, bolted through the tunnel with 4 M6 Bolts. It should be in a central, protected location on the central tunnel in front of the seats and both easily visible and accessible by both the driver and co-driver/nav. Photographs of mounting and positioning can be seen below.

### MOUNTING EXAMPLES



*Here the 25mm rubber ball mount is securely attached to the tunnel.*



*The RallySafe unit then mounts to the 25mm rubber ball mount (connected through the RallySafe connector).*

#### Base Dimensions:

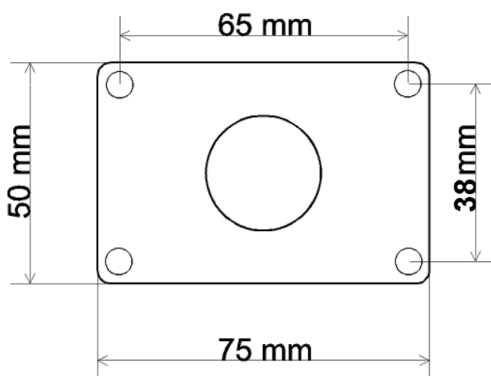

## Unit Dimensions

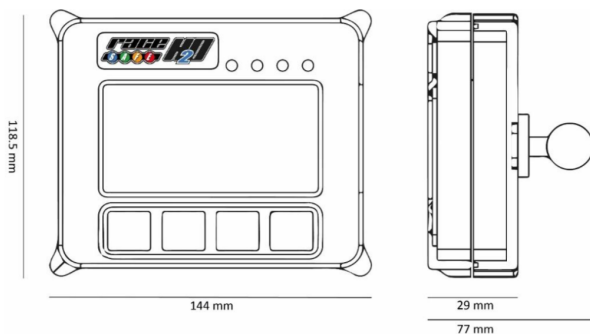

## Antenna Installation

All leads on both external and internal antennas **must** run on the inside of all roll cage bars. This is to stop cable crushing on impact. The preferred route is to go down from the antenna, underneath the closest part of the roll cage (roof cross or main hoop), follow that along to the roof hoop, then go down the inside A pillar to the unit. Any excess cable must be run so that the cable is not bent any tighter than a 100mm radius. We recommend running it across the underside of the dash and back (do not coil in tight loops). Cables must be tied neatly along the whole installation all the way to the unit so they can't be accidentally caught or dislodged. All this will be checked at scrutineering and you may be required to fix it before your car can pass.

### External Antenna:

The antenna is mounted through a 12mm hole in a central location on the ROOF of the vehicle, rear of the main roll bar hoop, allowing the cabling to pass through the roof and follow the cage bars back to the RallySafe unit location. The antenna is a fully watertight unit which seals against the roof surface.



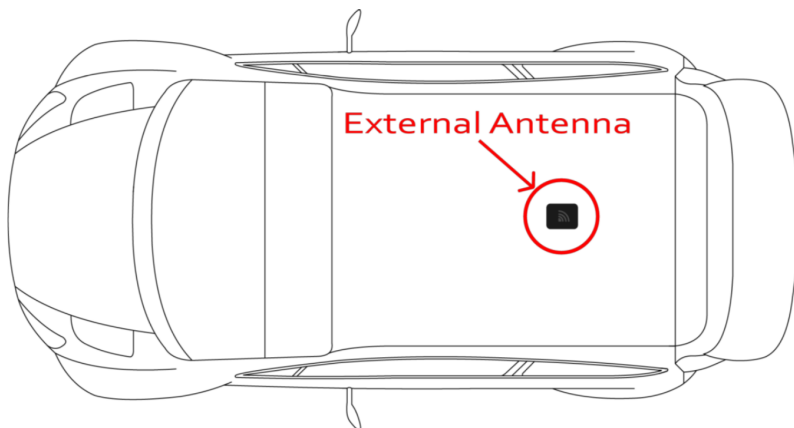

Antenna leads are connected as follows (There may be variations with the type and number of leads).

1. The 2 UHF leads, colour-coded **Blue**, is connected to the terminal labelled "UHF" on the RallySafe unit (Right Hand Thread). Terminals are located at the rear of the unit and/or colour-coded **Blue**.
2. The Satellite Communication antenna lead is connected to the centre or rear terminal labelled "IRI" (Left Hand Thread). It may also be colour-coded **Yellow** (this may be not marked on the 2-in-1 antenna).
3. The GPS antenna lead labelled "GPS", is connected to the terminal labelled "GPS" on the RallySafe unit (Right Hand Thread). Terminals may be on the side or rear of the unit and/or colour-coded **Green**.
4. GSM, has a small stick antenna supplied with the RallySafe unit, and is connected to corresponding terminal labelled "GSM" on the RallySafe unit (Left Hand Thread). The terminal is located on the rear of the unit and/or colour-coded **Red**.

## Internal Antenna:

The Internal Antenna should be placed on the inside of the ROOF in a clear uncluttered area, with a 200mm radius clear of any bar work or solid metal object. The internal antenna has a magnetic base with double-sided tape for adhesion. The cable is then run to the RallySafe unit. **Please keep cable on the inner side of the roll cage pipework so as not to be crushed in the event of an accident.**



*Here the antenna is stuck to the inside centre of the roof (Preferred)*

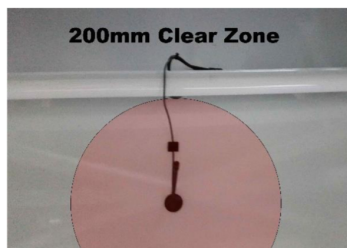

*Please note the internal antenna must be 200mm AWAY from any roll cage components*

## Contact Us

### STATUS AWARENESS SYSTEMS

14 Short St, Ulverstone

Tasmania, 7315

AUSTRALIA

Phone: +61 3 6425 7003

Email: [contact@rallysafe.com.au](mailto:contact@rallysafe.com.au)