



2020

# SUPPLEMENTARY REGULATIONS



## **Index**

1 INTRODUCTION	3
2 ORGANISATION	3
3 PROGRAMME	5
4 ENTRIES	8
5 INSURANCE	12
6 ADVERTISING AND IDENTIFICATION	13
7 TYRES	13
8 FUEL	14
9 RECONNAISSANCE	15
10 ADMINISTRATIVE CHECKS	17
11 SCRUTINEERING	17
12 OTHER PROCEDURES	18
13 IDENTIFICATION OF OFFICIALS	21
14 PRIZES	21
15 FINAL CHECKS AND PROTESTS	22
<b>APPENDICES</b>	
APPENDIX 1 - ITINERARY THURSDAY SHAKEDOWN AND SECTION 1	23
APPENDIX 1 - ITINERARY FRIDAY SECTION 2-3	24
APPENDIX 1 - ITINERARY SATURDAY, SECTION 4-6	25
APPENDIX 1 - ITINERARY SUNDAY, SECTION 7 - 9	26
APPENDIX 2 - RECONNAISSANCE SCHEDULE	27
APPENDIX 3 - COMPETITORS RELATIONS OFFICERS	28
APPENDIX 4 - COMPETITION NUMBERS AND ADVERTISING	29
APPENDIX 5 - OVERALLS, HELMETS AND OTHER SAFETY EQUIPMENT	30
APPENDIX 6 - FIA SAFETY EMERGENCY CONSOLE INSTRUCTIONS	31
APPENDIX 7 - STUDDED TYRES - RECONNAISSANCE	51
APPENDIX 7 - STUDDED TYRES - RALLY	51
APPENDIX 8 - SPECIFIC ITEMS FOR NATIONAL CARS	52
NOTES	

## 1 INTRODUCTION

This rally will be run in compliance with the FIA International Sporting Code and its appendices, the 2020 FIA World Rally Championship Sporting Regulations, the National Sporting Regulations which comply with the FIA regulations and these Supplementary Regulations. Modifications, amendments and/or changes to these Supplementary Regulations will be announced only by numbered and dated Bulletins (issued by the organizer or the Stewards).

Additional information will be published in Rally Guide 2, issued on 16 January. The 2020 FIA World Rally Championship Sporting Regulations can be found at [www.fia.com](http://www.fia.com).

### 1.2 Road Surface

Snow, ice and/or frozen gravel.

### 1.3 Itinerary

SS distance: 300,84 km

Total distances: 1328,14 km

## 2 ORGANISATION

### 2.1 FIA titles for which the rally counts

FIA World Rally Championship for Drivers  
FIA World Rally Championship for Co-Drivers  
FIA World Rally Championship for Manufacturers  
FIA WRC 2 Championship for Drivers  
FIA WRC 2 Championship for Co-Drivers  
FIA WRC 2 Championship for Teams  
FIA WRC 3 Championship for Drivers  
FIA WRC 3 Championship for Co-Drivers  
FIA Junior WRC Championship for Drivers  
FIA Junior WRC Championship for Co-drivers  
FIA Junior WRC Nations Trophy

### 2.2 Visa numbers - FIA and ASN

Swedish ASN visa no: RY-176 issued on: 2019-12-12

Norwegian ASN visa no: ARRA.20528 issued on: 2019-12-11

FIA visa no: 2WRC/1312209 issued on: 2019-12-13

### 2.3 Organisers name and contact details

Rally Sweden AB

Address: Lantvärnsgatan 4  
SE-652 21 Karlstad  
Telephone: +46 (0)5410 20 25  
E-mail: [mailbox@rallysweden.com](mailto:mailbox@rallysweden.com)  
[entry@rallysweden.com](mailto:entry@rallysweden.com) (entry related matters)  
Web site: [www.rallysweden.com](http://www.rallysweden.com)

## **2.4 Organising committee**

Göran Andersson, Håkan Andersson, Vera Bakke Andresen, Kicki Axelsson, Bruno Berglund, Krister Berglund, Stefan Claesson, Hasse Joansson, Stig Rune Kjærnsli, Adam Magnusson, Johan Magnusson, Glenn Olsson, Malin Thorsén, Jennie Skogman, Magnus Östlund, Ann-Louise Pettersson

## **2.5 Stewards of the meeting**

Chairperson (appointed by the FIA): Mr. Iain CAMPBELL  
 FIA Steward: TBC  
 ASN Steward: Mr. Bo SWANER  
 Secretary to the Stewards: Ms Yvonne Gilli

## **2.6 FIA Delegates**

FIA Sporting Delegate:	Mr. Timo RAUTIAINEN
FIA Safety Delegate:	Ms. Michelle MOUTON
FIA Deputy Safety Delegate	Mr. Nicolas KLINGER
FIA Media Delegate:	Ms. Vera DUSSAAUSAYE
FIA Technical Delegate:	Mr. Jerome TOQUET
FIA Technical Delegate:	Mr. Karmo UUSMAA
FIA Assistant Technical Delegate	Mr. Emilio SAGLIA
FIA Assistant Technical Delegate	Mr. Daniel FASANO
FIA Assistant Technical Delegate	Mr. Alberto CASTO
FIA Medical Delegate:	Dr. Cem BONEVAL

## **2.7 Senior Officials**

General Manager:	Glenn Olsson
Clerk of the Course:	Stig Rune Kjærnsli
Deputy CoC/ Route Manager	Johan Magnusson
Assistant CoC/ Technology Manager:	Göran Andersson
Assistant CoC/ Service Park Manager:	Adam Magnusson
Chief Safety Officer:	Magnus Östlund
FIA and Competitors Coordinator / Secretary of the rally:	Vera Bakke Andresen
Chief Medical Officer:	Maria Lannerås
Assistant Chief Medical Officer:	Thorsten Egonsson
Assistant Safety Officer:	Hasse Joansson
Assistant Safety Officer:	Bruno Berglund
Assistant Route Officer:	Krister Berglund
Chief Scrutineer:	Håkan Andersson
Assistant Chief Scrutineer:	Anna Rönnle
Results Officer:	Kicki Axelsson
National Press Officer:	Patrick Johansson
Helicopter Coordinator:	Lars-Gunnar Gustafsson
Sustainability Manager:	Malin Thorsén



## CLOSER TO RALLY.

### 2.8 HQ location

Hotel Selma Spa,  
Sundbergsvägen 3,

SE-686 28 Sunne, Sweden

GPS Coordinates: N59° 49,688, E13° 7,736

Rally Office Phone:

+46 (0) 54 10 20 25

E-mail:

mailbox@rallysweden.com

entry@rallysweden.com (for entry related matters)

### 2.9 Official Notice Board-Location

The official notice board (ONB) will be placed at Rally HQ, Hotel Selma Spa. In addition, all official documents will be published on the "On-line Notice Board" on rallysweden.com and will be available to all users.

## 3 PROGRAMME

### 3.1 Schedule before the rally week

<b>Friday 13 December 2019</b>	
Supplementary Regulations published Opening date for entries	Website
<b>Tuesday 14 January 2020</b>	
Closing date for entries	Website
<b>Wednesday 15 January 2020</b>	
Closing date for National media accreditation	Rally Office
<b>Thursday 16 January 2020</b>	
Road Book, Rally Guide 2 and route map available	Web & Rally Office
<b>Friday 17 January 2020</b>	
Publication of entry list with allocated competition numbers	Website
<b>Tuesday 21 January 2020</b>	
Closing date for international media accreditation Closing date TV and international radio accreditation	FIA WRC Promotor
<b>Wednesday 22 January 2020</b>	
Closing date for International media accreditation	FIA

<b>Thursday 23 January 2020</b>	
Closing date for FIA fuel orders. All competitors	mehmet.basar@total.com
<b>Wednesday 29 January 2020</b>	
Closing date for order of Service Park facilities	Rally Office
Closing date for order of Extra material	Rally Office
Media Safety Book published	Website
Closing date for "reconnaissance only" applications	Rally Office
<b>Thursday 30 February 2020</b>	
Closing date for helicopter and drone registration	Rally Office

### 3.2 Schedule during the rally week

<b>Thursday 6 February 2020</b>		
12:00 - 17:00	Service Park opens for Manufacturers	SP, Torsby
<b>Friday 7 February 2020</b>		
09:00 - 17:00	Service Park opens for Manufacturers	SP, Torsby
<b>Saturday 8 February 2020</b>		
09:00 - 17:00	Service Park opens for Manufacturers	SP, Torsby
<b>Sunday 9 February 2020</b>		
09:00 - 17:00	Service Park opens for Manufacturers and WRC2 entrants	SP, Torsby
<b>Monday 10 February 2020</b>		
08:00-17:00	Service Park opens for Manufacturers and WRC2 entrants	SP, Torsby
09:00	Rally Office opens	Rally HQ
16:00 - 20:00	Registration for reconnaissance	Rally HQ
16:00 - 20:00	Administrative checks and collection of materials	Rally HQ
16:00 - 20:00	Collection of GPS Tracker for reconnaissance	SAS Truck, SP
<b>Tuesday 11 February 2020</b>		
08:00-17:00	Service Park open for all entrants	SP, Torsby
08:00 - 18:00	Reconnaissance of special stages (incl. Shakedown)	Recce schedule
16:00-20:00	Collection of FIA Safety tracking devices	SAS Truck, SP

<b>Wednesday 12 February 2020</b>		
08:00 - 15:00	Reconnaissance of special stages	Recce schedule
09:00 - 12:30	Scrutineering incl. sealing and marking. Manufacturers	SP, Torsby
14:00 - 22:00	Scrutineering incl. sealing and marking. Other entrants	Stjerneskolan, Torsby
15:00 - 18:00	Return of reconnaissance GPS trackers	SAS Truck, SP
16:00	Team Managers Meeting for Manufacturers (P1 and P2)	Rally HQ
17:00	Publication of Start List for Shakedown (P1 and other drivers as requested)	ONB
17:00	FIA Photographers safety briefing	Press Centre
18:00-18:30	Mandatory Drivers Briefing	Rally HQ
<b>Thursday 13 February 2020</b>		
09:01- 10:30	Shakedown P1 + and other drivers as requested	Skalla, Torsby
10:30 - 11:30	Shakedown P1 + P2 + P3	Skalla, Torsby
11:30 - 12:30	Shakedown P4 and Non-Priority drivers	Skalla, Torsby
12:00	FIA Meet the crews Press Conference	SP, Torsby
13:00	FIA Pre-Event Press Conference	Press Centre
15:00	Publication of start list Section 1 + Section 2	ONB
16:00-18:00	Reconnaissance SS 1/15	SSS, Karlstad
19:00	Opening Ceremony incl. presentation of the drivers	SSS, Karlstad
20:04	Rally Start	SSS, Karlstad
<b>Friday 14 February 2020</b>		
21:00	Publication of start list Section 4	ONB
<b>Saturday 15 February 2020</b>		
20:00	Publication of start list Section 7	ONB
<b>Sunday 16 February 2020</b>		
From 13:00	Podium Ceremony and Prize Giving	SP, Torsby
14:00	Final Scrutineering	Stjerneskolan, Torsby
14:00	FIA Post-Event Press Conference	Press Centre,
17:00	Publication of Provisional Classification	ONB

### 3.3. Opening hours HQ and Media

Opening hours		Rally HQ	Media accreditation	Presscenter
Monday	10 February	09:00 - 20:00		
Tuesday	11 February	08:00 - 20:00	14:00 - 20:00	14:00 - 20:00
Wednesday	12 February	07:00 - 20:00	08:00 - 20:00	08:00 - 20:00
Thursday	13 February	07:00 - 22:00	08:00 - 22:00	08:00 - 22:00
Friday	14 February	06:30 - 22:00		07:00 - 22:00
Saturday	15 February	06:30 - 22:30		07:00 - 22:00
Sunday	16 February	06:00 - 20:00		07:00 - 23:00

## 4 ENTRIES

### 4.1 Closing date for entries

The closing date for entries is Tuesday 14 January at 15:00 (CET).

### 4.2 Entry Procedure

Those wishing to take part in Rally Sweden 2020 must register and fill in the electronic entry form published at <https://registrations.fia.com/wrcswe> duly completed before the closing date for entries. The entry will only be accepted if accompanied by the total amount of the Entry Fee. To be accepted, competitors must send a proof of payment of the entry fee by e-mail to the secretary of the event ([vera@rallysweden.com](mailto:vera@rallysweden.com)) by the closing date of entries. Foreign drivers must submit an approval from their ASN in the same e-mail.

Manufacturers, WRC2 and WRC3 entrants who wish to score points, must make their entries by using the electronic standard rally entry form for their championships available in the FIA application at <https://registrations.fia.com>.

### 4.3 Classes

With reference to Art 4 in 2020 FIA WRC Sporting Regulation, the classes will be divided according to table below.

Cars entered in a class with less than 5 entrants will be elevated to the next class.



**CLOSER TO RALLY.**

Classes	Groups	
RC1	World Rally Cars: 1.6 T engine	<p>- World Rally Cars, complying with the 2020 Appendix J, Art. 255A, when driven by a driver who has obtained the approval of the FIA</p> <p>- World Rally Cars homologated before 31.12.2013, complying with homologation extension 100/01 KSR and its WR extension, and with the 2013 Appendix J, Art. 255A. Only WRC cars with an FIA passport issued before 31/12/2016 are allowed</p> <p>- World Rally Cars homologated as from 01.01.2014, complying with homologation extension 200/01 WRC and with the 2016 Appendix J, Art. 255A. Only WRC cars with an FIA passport issued before 31/12/2016 are allowed.</p> <p>- World Rally Cars homologated as from 01.01.2015, complying with homologation extension 300/01 WRC and with the 2016 Appendix J, Art. 255A. Only WRC cars with an FIA passport issued before 31/12/2016 are allowed.</p>
RC2	Group Rally2 Group Rally2 Kit	<p>- Group Rally2 cars conforming to the 2020 Appendix J, Art. 261.</p> <p>- Car fitted with Rally2 Kit cars confirming to the 2020 Appendix J, Art 260 E.</p>
RGT	RGT cars	- Group RGT cars conforming to the 2020 Appendix J, Art. 256.
RC3	R3 (atmo / over 1600cc and up to 2000cc and turbo over 1067cc and up to 1333 cc)	- Group R cars homologated before 31/12/19 and conforming to the 2019 Appendix J, Art. 260
	R3 (turbo / up to 1620cc / nominal)	- Group R cars homologated before 31/12/19 and conforming to the 20 Appendix J, Art. 260D

RC4	RC4A	Rally4 (atmo over 1600cc and up to 2000cc and turbo over 1067cc and up to 1333cc)	- Group Rally4 cars homologated before 01/01/19 and conforming to the 2020 Appendix J, Art. 260D
	RC4B	Rally4 (atmo over 1390cc and up to 1600cc and turbo over 927cc and up to 1067cc)	- Group Rally4 cars homologated from 01/01/19 and conforming to the 2020 Appendix J, Art. 260 - Group R2 cars homologated before 21/12/2018 and conforming to the 2018 Appendix J, Art. 260
RC5		Rally5 (atmo up to 1600cc and turbo up to 1333cc)	- Group Rally5 cars homologated from 01/01/19 and conforming to the 2020 Appendix J, Art. 260
		Rally5 (atmo up to 1600cc and turbo up to 1067cc)	- Group R1 cars homologated before 31/12/2018 conforming to the 2018 Appendix J, Art. 260 (VR1A and VR1B homologated before 31/12/2018)

For groups and classes for National Cars, see SR, Appendix 8.

#### **4.4 Entry fees and entry packages**

##### **4.4.1 Entry fees**

Manufacturers, WRC2 and WRC3:

As per FIA WRC 2020, Appendix VI, with local VAT added (6%), see also Art. 4.5.

Legal entrant: Car entered by a team (not entered in any of the categories above), a company or other legal entity (with competitor licence)

Entry fee: SEK 55 000 + 6 % VAT (Total amount: SEK 58 300,-)

Private entrant: The competing car is entered by the driver or the co-driver.

Entry fee: SEK 35 000 + 6 % VAT (Total: SEK 37 100,-)

Private entrant from Sweden and Norway: Non-priority drivers with the competing car entered by the driver or the co-driver.

Entry fee: SEK 20 000 + 6 % VAT (Total: SEK 21 200,-)

#### **Entry fees for National Cars, NAT 2 and NAT 4, see Appendix 8**

#### 4.4.2 Entry Packages

The entry packages for FIA Championship entrants will be as stipulated by the FIA in the 2020 FIA WRC Sporting Regulations.

Entry packages for legal and private entrants:

	Legal Entrants	Private Entrants
Service Park area approx.	10 x 10 m	10 x 10 m
<b>Car plates</b>		
Service plate	2	2
Auxiliary plate	1	0
<b>Passes</b>		
Team passes	10	6
<b>Documents</b>		
Supplementary Regulations	available only at <a href="http://www.rallysweden.com">www.rallysweden.com</a>	
Road Book sets	3	2
Route Maps	5	3
Official Magazine / Programme	5	2
Rally Guide 1	available only at <a href="http://www.rallysweden.com">www.rallysweden.com</a>	
Rally Guide 2	available only at <a href="http://www.rallysweden.com">www.rallysweden.com</a>	
Results	All results available only at <a href="http://www.rallysweden.com">www.rallysweden.com</a>	

#### 4.5 Payment details

The entry fee must be paid to the following bank account:

Payment in Sweden:

Bankgiro 5070-5169

Payment from abroad:

IBAN: SE85 80000 8156 29 03 0406 772

SWIFT: SWEDSESS

Account holder: Rally Sweden AB

Address to the bank: SWEDBANK, SE-105 34 Stockholm, Sweden

Note! Please mark the payment with the drivers last name.

#### **4.6 Refunds**

Entry fees will be refunded in full:

- a) to candidates whose entry has not been accepted
- b) in case of the rally not taking place

The organisers may refund part of the entry fee to those competitors who, for reason of “force majeure” (duly certified by their ASN), are unable to start in the rally. This must be applied for in writing giving the reason for claim including bank and account details.

### **5 INSURANCE**

Eligible for the rally including Shakedown

#### **5.1 Traffic Insurance**

All cars participating in the rally must have a valid obligatory traffic insurance towards third parties. In Sweden and Norway, the “Green Card” (International Motor Insurance Card) system is applied. For cars coming from countries outside the Green Card system and EEA-countries, a Nordic frontier insurance must be taken at the border. Traffic insurance guarantee competitor’s cover for civil responsibility towards third parties on road sections. The organizer will issue third party insurance cover for foreign registered cars valid on specialstages (incl. shakedown).

#### **5.2 Accident insurance in Norway**

The Norwegian Traffic Damage Act is enforced.

##### **5.2.1 Accident Insurance on special stages**

The organizer will issue third part insurance cover valid on special stages for all cars. Competitors’ and organizers’ property are excluded.

#### **5.3 Insurance amounts**

##### **Sweden**

Maximum compensation in case of damage is SEK 300 000 000.

Maximum compensation regarding organizer liability insurance is SEK 5 000 000.

##### **Norway**

Maximum compensation in case of third part damage is unlimited (personal damage).

Maximum compensation regarding organizer liability insurance is NOK 10 000 000 per each damage (property damage).

#### **5.4 Limitation of Indemnity**

The organizer declines any liability concerning the consequences caused by any fraudulent action taken by the competitor, may this be against the rules and regulations of the rally or against the laws of the country.

Any service vehicles or reconnaissance cars, even those bearing the official identification of the organizer, may under no circumstances be considered as official participants of the rally, hence their insurance policies remain the sole responsibility of the owner.

## 6 ADVERTISING AND IDENTIFICATION

### 6.1 Restrictions

Advertising for tobacco, tobacco products and smokers' requisites is forbidden in Sweden and Norway. Advertising for alcohol is restricted by law and is not allowed on competing cars, service cars, equipment and/or clothing.

### 6.2 The organiser's advertising

The organiser's advertising on the doors, roof and rear window plates will be announced in a bulletin. There will be no organiser's optional advertising.

### 6.3 Identification

Competition numbers and rally plates according to the 2020 FIA WRC Sporting Regulation, art. 28, will be provided by the organiser. See also Appendix 4.

Numbers and plates must be affixed on the rally car before the car is brought to scrutineering and must be visible throughout the duration of the rally.

The following stickers will be affixed to the car by the scrutineers:

- At scrutineering:
  - A check card, size 10 cm wide x 6 cm high (at roll-cage drivers side)
- At the overnight parc fermé for section 2, section 4 and section 7:
  - A "2 minutes" - sticker (on the roof over the wind screen, co-driver side) on cars with a start interval of 2 minutes.

## 7 TYRES

### 7.1 Tyres quantities

In addition to complying with Articles 13, 14 and 15 of the 2020 FIA WRC Sporting Regulations, the following maximum quantities of tyres are confirmed for use:

FIA Nominated Tyre Manufacturer	Tyre	Compound
Michellin	TBC (Bulletin)	Ice
Pirelli	TBC (Bulletin)	Ice

Type of cars	Quantity for the event
World Rally Cars	28
All other cars	26

Tyres used during Shakedown will not count in the overall quantity for the event.

## 7.2 STUDED TYRES FOR RECONNAISSANCE

Studded tyres may be used during reconnaissance. They must be in conformity with the following regulations (see also Appendix 7):

- The studs shall be solid, cylindrical and flatcut
- The length of the stud is limited to 15 millimeters
- The weight of the stud is limited to 2,5 grams
- The maximum overhang is limited to 2,0 millimetres
- The studs must be mounted into the tyre from the outside
- The number of studs must not exceed 250 per tyre
- The body of the stud must be solid

Any infringement to this rule will be reported to the Stewards, who will consider a penalty according to the International Sporting Code Art. 12.

## 7.3 Studded tyres during the event

Studded tyres may be used during the event. They must be in conformity with 2020 WRC Sporting Regulations Appendix V, (C) (see also Appendix 7)

- The studs shall be solid, cylindrical and flatcut
- The cross section of the studs must form a full circle at every point
- The stud is not allowed to be tubular at any point
- The body of the stud must be homogenous and is not allowed, under any circumstances to form a tube or hole.
- Maximum diameter of the flange is 9 millimetres
- Minimum diameter of the metal core in the middle of the stud is 2,5 millimeters. It must be cylindrical, homogenous and flatcut
- The length of the stud is limited to 20 millimeters
- The weight of the stud is limited to 4 grams
- The studs must be mounted in to the tyre from the outside
- The number of studs must not exceed 20 per any decimeter of the wheel circumference.

Any infringement to this rule will be reported to the Stewards, who will consider a penalty according to the International Sporting Code Art. 12.

### 7.3.1 Method for checking the number of studs

Measurement will be carried out with a pattern, on a non-pressured part of the tyre. The length of the pattern is 30 cm, and within the pattern there must not be more than 60 studs. If the number of studs is more than 60 in a 30 cm sections, a further check will be carried out in the next 30 cm section and the total number of studs in both sections must be maximum 120.

## 8 FUEL

All drivers must use FIA fuel as provided by the FIA appointed supplier. See art 61 and 62 of the 2020 FIA WRC Sporting Regulations. For environmental and safety reasons, all competitors must refuel in the designated refuel zones (except as detailed in the regulations for the change of fuel tank).

### **8.1 Ordering procedure**

Competitors must notify their fuel requirements to the sole supplier at the following address (order form available on [www.rallysweden.com](http://www.rallysweden.com)):

Email: [mehmet.basar@total.com](mailto:mehmet.basar@total.com)

The cost of the fuel is € 5,60 + VAT per litre.

### **8.2 Closing date for ordering FIA Fuel**

Closing date for ordering of FIA-fuel is Thursday 23 January 2020.

### **8.3 FIA couplings**

#### **Fuel couplings**

All competitors are required to fit FIA specified refuel couplings.

#### **Fuel-sample couplings**

Cars of priority drivers must be fitted with FIA fuel-sample couplings.

## **9 RECONNAISSANCE**

See also Art. 35 in the 2020 FIA WRC Sporting Regulations

### **9.1 Procedure for reconnaissance registration**

Date and Time: Monday 10 February 16:00 - 20:00

Location: Rally HQ, Sunne

GPS Coordinates: N59° 49,688, E13° 7,736

Administrative checks will be carried out at the same time as registration for recce. Both crew members must therefore be present.

All priority drivers may send a representative (duly assigned by writing) presenting all documents as listed in FIA WRC Regulations Art. 30.

Administrative check for Manufacturers may be carried out by appointment.

At the registration a special ID-form, including details of the car that will be used during the reconnaissance, must be signed.

Identification numbers, given at the registration shall be affixed on the car (windscreen at the top corner, drivers side) and kept visible for the duration of the reconnaissance period.

#### **Participation in reconnaissance only**

Any driver holding an appropriate international license but not entered in the rally may apply to take part in the reconnaissance. The regulations on reconnaissance must be respected in their entirety. A registration form for this purpose will be sent on request.

The final permission for taking part in recce is left to the discretion of the organiser. An administrative fee of € 1200 (+ 6 % VAT) will be charged.

## 9.2 Installation of speed control checking devices

With reference to Article 35.4.4 of the 2020 FIA WRC Sporting regulations, **all cars** must carry recce GPS trackers for speed control during reconnaissance.

Collection of Recce GPS trackers:

Date and Time: Monday 10 February 16:00 - 20:00

Location: SAS Truck, Torsby Service Park

GPS Coordinates: N60 09,138, E12 59,750

Rental costs:

P1/P2/P3 300 € HT

P4 and Non-priority 130 € HT

## 9.3 Specific and national restrictions

### 9.3.1 Passages

Crews are authorised to drive a maximum of 2 times through each special stage in accordance with the schedules given in Appendix 2. The special stages must be driven in the same direction as the rally, at a reduced speed and fully respecting the Traffic Laws. All special stages are run twice during the rally but may only be driven as one stage during recce. All passages through the special stages will be recorded by the marshals and signed by the competitors. Time cards will not be used.

### 9.3.2 Speed limits

Maximum speed allowed during reconnaissance is 70 km/h on special stages, unless another speed limit is indicated by traffic signs or by written instructions in the Road Book (or in bulletins). All crews are reminded of Art. 34.2 in the 2020 FIA WRC Sporting Regulations. For recce of SSS 1/15 see. Art. 9.3.4 below.

### 9.3.3 Tyres

For reconnaissance tyre regulations see Art. 7.2.

### 9.3.4 Reconnaissance SSS 1 and SSS 15 (Karlstad Super Special Stage)

Recce on SSS 1 and SSS 15 will be carried out on Thursday 13 February and may only be driven as one stage during recce. Since this is a Super special stage, cars will run the loop twice from starting position 1 (outer track). There will not be a separate run for starting position 2 (inner track).

The recce must be done with the rally car with rally studded tyres.

The speed limit on this stage during recce is 30 km/h. The speed limit at the trotting course is 20 km/h before the start line and after the finish line.

All crews are reminded of Art. 34.2 in the 2020 FIA WRC Sporting Regulations.



## 10 ADMINISTRATIVE CHECKS

### 10.1 Documents to be presented

The following will be checked at the administrative check:

- Valid Competitor license
- Valid Driver's and co-driver's competition licenses
- Valid Driver's and co-driver's driving licenses
- Valid Driver's and co-driver's passports or identification
- ASN authorisation for all foreign competitors and/or drivers
- Completion of all details on the entry form
- Car registration papers
- Insurance cover (third parties) for the rally car
- Insurance cover for repatriation (non-Swedish crews)

### 10.2 Timetable

Date and Time: Monday 10 February 16:00 - 20:00

Location: Rally HQ, Sunne

GPS Coordinates: N59° 49,688, E13° 7,736

NB! Manufacturers may make their administrative check by appointment.

## 11 SCRUTINEERING

### 11.1 Venue and Timetable

Manufacturers:

Location: Service Park, Torsby. GPS Coordinates: N60 09,138, E12 59,750

Date: Wednesday 12 February

Time: 09:00 -12.30 (individual times to be confirmed in a bulletin)

Other entrants:

Location: Stjerneskolan, Torsby

GPS Coordinates: N60° 8.550' E13° 0.525'

Date: Wednesday 12 February

Time: 14:00 - 22.00 (individual times to be confirmed in a bulletin)

**Note! Rally studded tyres are forbidden in the workshop at Stjerneskolan.**

**3 mechanics can follow the car to scrutineering (2 for the car and 1 for personal equipment).**

**In addition, 2 mechanics may follow the Service car with spare parts.**

### 11.2 Mudflaps

Fitting of transversal mud flaps (all wheels) is mandatory in conformity with Appendix J, Art. 252.7.7.

### 11.3 Windows

The use of silvered or tinted films is not authorized in this rally.

#### **11.4 Drivers safety equipment**

Drivers safety equipment will be checked at scrutineering. For specifications, see App. 5.

#### **11.5 Noise level**

At any time on the road sections, the noise level must be in conformity with Appendix J. See also FIA WRC Sporting Regulations Art. 18.4

#### **11.6 National and specific regulations**

Competing cars must be equipped with two snow shovels, two first aid kits and one reflective triangle. In addition, in Norway one yellow jacket to use if the car stops on a roadsection is mandatory.

#### **11.7 FIA Safety tracking device**

In accordance with Art. 53.2.1 of the 2020 FIA WRC Sporting Regulations, all competitors must make provisions in their rally cars for the installation of the FIA Safety Emergency Console System and the emergency button, and the system must be installed before the car is brought to scrutineering.

For Installation instructions see Appendix 6

Systems may be collected either by the crew or a representative.

A €1200 fully refundable credit card deposit will be collected by STATUS AWARENESS SYSTEM (SAS) from each competitor for the FIA Safety Emergency Console boxes. This will be done with a swipe machine and at the end of the rally the slip will be destroyed when competitors return the equipment in good condition. Deposit must be done by credit card, no other deposit accepted.

The FIA Safety Emergency Console System devices must be removed in the final parc fermé. They must be returned no later than 18.00 hrs on Sunday 16th February to STATUS AWARENESS SYSTEM (SAS) at the Service Park.

#### **11.8 Preparations**

The homologation form of the rally car and certificates on roll cage and fuel tank must be brought to scrutineering. The bodyshell and engine will be marked with a special device and the competitor must prepare their car (on a visible place) in order to fit a wire, a plate and a seal on the engine block.

## **12 OTHER PROCEDURES**

#### **12.1 Start procedure and order**

There will be no ceremonial start in this rally. The official start of the rally will be at TC 1 (before SSS 1 Karlstad Super Special Stage). A start assembly area will be established before the TC 1. All crews and cars are required to be present in the start assembly area at the latest 10 minutes before their start time as announced in the start list for section 1.

The start order for section 1 will be published on Thursday 13 February at 15:00. See also Art. 12.5 Super Special Stage.

## CLOSER TO RALLY.

There will be a pre start show including presentation of cars and drivers starting from 19:00. Further details will be given in Rally Guide 2.

The presence of team mechanics or any work on the rally car (except by the crew) is not permitted at any time inside the arena. 2020 FIA WRC regulations Art. 13.8 will apply in the tyre marking zone.

### **12.2 Permitted early check in**

Crews are authorised to check in early without incurring a penalty at, TC 1A (end of Section 1) TC 8C (end of section 3), TC 16C (end of section 6) and TC 19A (end of section 9)

### **12.3 Change of time card during the rally**

Timecard will be issued at the time control at TC 1, TC 1B, TC 4A, TC 8D, TC 11A, TC 14A, TC 16D, TC 17A and TC 18A

### **12.4 Super Special Stage, procedure and running order**

SSS 1 and 15 (Karlstad Super Special Stage) will be run under Super Special Stage regulations. At this super special two cars will be given start at the same time on parallel positions. The cars will follow the route of the stage, changing lanes in a tunnel/bridge combination and will be crossing the finish line at the same position where they started.

Preceding the Super Special Stage there will be a start assembly area (SSS 1) and a regroup (SSS 15). In these areas competitors will be paired for the Super Special Stage.

The organiser reserves the right, at their own discretion, to pair the cars for SSS 1 on grounds of spectator interest. For SSS 15 the starting order will be according to the current running order. There will not be any media zone prior to the yellow time control board at the regroup before SS15.

The maximum time allowed on SS1 and SS 15 is 5 minutes. Any crew failing to complete SS 1 or SS 15 within the 5 minutes will be considered retired with the possibility to re-start the rally in accordance to Art 54 in the FIA WRC Sporting Regulations.

Should a car stop in SSS 1 or 15 the car will immediately be towed, transported or pushed to the road section after the STOP control by the organiser. Any such car will be penalised as in the 2020 FIA WRC Sporting Regulations Art. 54.2 and will be deemed to re-start from TC 1B or TC 16D, respecting the requirements of WRC Art. 55, unless the competitor notifies the organiser otherwise.

If the running of the SSS 1 and/or SSS 15 is interrupted, this will be signaled to the drivers by red flags. When given this signal, the driver must immediately reduce speed and follow the instructions of any marshals or other officials. Failure to comply with this rule will entail a penalty at the discretion of the Stewards.

The speed limit at the trotting course is 20 km/h before the start line and after the finish line, and all crews are reminded to oblige and follow the speed limit.

### **12.5. Start order section 7**

Reference to Art. 40.2 in the FIA WRC Sporting regulation: The start order for section 7 will be based on the provisional overall classification after SS 14 (i.e both SS 15 Karlstad and SS 16 Torsby Sprint will be considered as super special stages).

**12.6. Organisers promotional activities**

Promotional activities, if any, will be published in a Bulletin

**12.7 Retired cars restarting the rally, Art. 54 regulations**

With reference to Art. 54 in 2020 the FIA WRC Sporting Regulations any crews which fails to complete a section will be assumed to re-start the rally from the start of the next section following the overnight regroup. If not, they must confirm with the clerk of the course by completion of the form located in the road book and lodging it with the organiser as soon as possible before the publication of the re-start list.

Any crew re-starting the rally must present their cars at the overnight parc fermé at the latest four hours before the start of the next section following the overnight regroup. For cars driven by Priority drivers, a special time card will be used for the maximum of 3 hours service.

**12.8 Power Stage**

With reference to Art. 50 in the 2020 FIA WRC Sporting Regulations special stage 19 Torsby will be run as the "Power Stage".

**12.9 Change of on-board camera data**

The change of on-board camera data is allowed as stipulated in Art. 41.8 of the 2020 FIA WRC Sporting Regulations

**12.10 Finish procedure**

The finish of the competition element of the Rally and the podium ceremony will take place at Torsby SP on Sunday 16 February. The finish TC is TC 19A. After the Power stage the prize giving for the top three overall will be broadcast live in TV from the podium at the service park. After finishing the Power Stage and checking in at TC 19A, all cars must immediately proceed to the holding area before the podium at the service park and follow the instructions from the marshals. After the prize giving for the top three overall, the prize giving for all other competitors will follow. After completing the finish ceremony all cars (except cars subject to final checks) must be driven to the parc fermé at the Service Park.

**12.11 Environmental prescriptions**

Teams are obligated to follow the directions and objectives in the organisers environmental policy. Further information will be published in Rally Guide 2.

### **13 IDENTIFICATION OF OFFICIALS**

The post chiefs and other officials will be identified with tabard as follows:

Stage Commander:	Red
Stage Safety Officer:	Orange with white stripe
Safety Marshal:	Orange
Time Control Officer:	Blue
Doctor:	White
Red flag marshal:	Yellow with blue radio point symbol
Media Officer:	Green
Scrutineers:	Black
Competitor Relations Officer:	Red jackets

### **14 PRIZES**

#### **General Classification**

1. Overall winner
2. 2nd overall
3. 3rd overall

#### **Manufacturer**

1. Winning manufacturer

#### **WRC 2 Rally Championship classification:**

1. Winner
2. 2nd
3. 3rd

#### **WRC 3 Rally Championship classification:**

1. Winner
2. 2nd
3. 3rd

#### **FIA Junior WRC**

1. Winner
2. 2nd
3. 3rd

#### **Perpetual Trophies**

- Overall winner
- Colin´s Crest Award
- Best driver from the county of Värmland

## 15 FINAL CHECKS AND PROTESTS

### 15.1 Final checks - attendance and location

The final checks will take place at Stjerneskolan, Torsby on Sunday 16 February. Cars subject to final checks (decision by the Stewards and announced to the competitor concerned at the finish TC) must have one representative of the competitor as well as mechanics (in case of dismantling) present at the final check. Rally studded tyres are forbidden at the workshop at Stjerneskolan and the competitor concerned must prepare for tyre change outside the workshop before the final check.

### 15.2 Protest deposit

The protest deposit is € 1000

#### 15.2.1 Additional fees

If the protest requires dismantling and reassembly of different parts of the car, the claimant must pay an additional deposit

For a protest involving a clearly defined part of the car (engine, transmission, steering, braking system, electrical installation, bodywork etc): € 500

For a protest involving the whole car: € 1000

### 15.3 Appeal deposit

Sum for an international appeal deposit (FIA): € 6 000

## APPENDIX 1 - ITINERARY THURSDAY, SHAKEDOWN AND SECTION 1

SD		THURSDAY 13 FEBRUARY			Sunrise 07:53 Sunset 16:51	Version 2.1 2019-12-04
TC/SS	Location	SS	Distance Liaison	Total	Target Time	First car due
	Service Park Torsby					
TC SD	Shakedown		8,39	8,39		08:56
<b>SD</b>	<b>Shakedown Skalla</b>	<b>7,21</b>				<b>09:01</b>
	Service Park Torsby		12,67	19,88		
<b>SD Totals</b>		<b>7,21</b>	<b>21,06</b>	<b>28,27</b>		

Section 1		THURSDAY 13 FEBRUARY				
TC/SS	Location	SS	Distance Liaison	Total	Target Time	First car due
TC 1	Start Färjestad Trotting Course Karlstad					20:04
<b>SS 1</b>	<b>SSS Karlstad 1 (Live TV Stage)</b>	<b>1,90</b>				<b>20:08</b>
TC 1A	Parc Fermé Torsby IN		102,33	104,23	1:50	21:58
<b>Thursday Totals</b>		<b>1,90</b>	<b>102,33</b>	<b>104,23</b>		

## APPENDIX 1 - ITINERARY FRIDAY, SECTION 2 - 3

Section 2-3		FRIDAY 14 FEBRUARY			Sunrise 07:50 Sunset 16:54	Version 2.1 2019-12-04
TC/SS	Location	SS	Distance Liaison	Total	Target Time	First car due
TC 1B	Parc Fermé Torsby OUT/Service IN					06:05
	<b>Service A (Torsby)</b>	<b>(1,90)</b>	<b>(102,33)</b>	<b>(104,23)</b>	<b>0:15</b>	
TC 1C	Service OUT					06:20
<b>RZ 1</b>	<b>Refuel Service Out (All competitors)</b>		<b>(0,00)</b>			
	<b>Distance to next refuel</b>	<b>(21,26)</b>	<b>(104,72)</b>	<b>(125,98)</b>		
TC 2			92,23	92,23	1:37	07:57
<b>SS 2</b>	<b>Hof-Finnskog 1</b>	<b>21,26</b>				<b>08:00</b>
<b>RZ 2</b>	<b>Remote refuel Namná (All competitors)</b>		<b>(12,49)</b>			
	<b>Distance to next refuel</b>	<b>(39,62)</b>	<b>(90,51)</b>	<b>(130,13)</b>		
TC 3			31,84	53,10	0:58	08:58
<b>SS 3</b>	<b>Finnskogen 1</b>	<b>20,68</b>				<b>09:01</b>
TC 4			22,88	43,56	0:53	09:54
<b>SS 4</b>	<b>Nyckelvattnet 1</b>	<b>18,94</b>				<b>09:57</b>
TC 4A	Regroup and Technical Zone IN		48,28	67,22	1:17	11:14
TC 4B	Regroup OUT/Service IN				0:15	11:29
	<b>Service B (Torsby)</b>	<b>(60,88)</b>	<b>(195,23)</b>	<b>(256,11)</b>	<b>0:40</b>	
TC 4C	Service OUT					12:09
<b>RZ 3</b>	<b>Refuel Service Out (All competitors)</b>		<b>(0,00)</b>			
	<b>Distance to next refuel</b>	<b>(21,26)</b>	<b>(104,72)</b>	<b>(125,98)</b>		
TC 5			92,23	92,23	1:37	13:46
<b>SS 5</b>	<b>Hof-Finnskog 2</b>	<b>21,26</b>				<b>13:49</b>
<b>RZ 4</b>	<b>Remote refuel Namná (All competitors)</b>		<b>(12,49)</b>			
	<b>Distance to next refuel</b>	<b>(48,55)</b>	<b>(92,83)</b>	<b>(141,38)</b>		
TC 6			31,84	53,10	1:03	14:52
<b>SS 6</b>	<b>Finnskogen 2</b>	<b>20,68</b>				<b>14:55</b>
TC 7			22,88	43,56	0:53	15:48
<b>SS 7</b>	<b>Nyckelvattnet 2</b>	<b>18,94</b>				<b>15:51</b>
TC 8			49,64	68,58	1:10	17:01
<b>SS 8</b>	<b>Torsby 1</b>	<b>8,93</b>				<b>17:04</b>
TC 8A	Technical Zone IN		0,96	9,89	0:22	17:26
TC 8B	Technical Zone OUT/Service IN				0:10	(17:36)
	<b>Flexi Service C (Torsby)</b>	<b>(69,81)</b>	<b>(197,55)</b>	<b>(267,36)</b>	<b>0:45</b>	
TC 8C	Service OUT/Parc Fermé Torsby IN					(18:21)
All cars must be returned to Parc Fermé no later than 21:00						
<b>Friday Totals</b>		<b>130,69</b>	<b>392,78</b>	<b>523,47</b>		

Section 2

Section 3



## APPENDIX 1 - ITINERARY SATURDAY, SECTION 4 - 6

Section 4-6		SATURDAY 15 FEBRUARY			Sunrise 07:48	Version 2.1
					Sunset 16:57	2019-12-04
TC/SS	Location	SS	Distance Liaison	Total	Target Time	First car due
TC 8D	Parc Fermé Torsby OUT/Service IN					07:25
	<b>Service D (Torsby)</b>	<b>(0,00)</b>	<b>(0,00)</b>	<b>(0,00)</b>	<b>0:15</b>	
TC 8E	Service OUT					07:40
<b>RZ 5</b>	<b>Refuel Service Out (All competitors)</b>		<b>(0,00)</b>			
	<b>Distance to next refuel</b>	<b>(39,72)</b>	<b>(45,25)</b>	<b>(84,97)</b>		
TC 9			16,36	16,36	0:30	08:10
<b>SS 9</b>	<b>Torntorp 1</b>	<b>19,92</b>				<b>08:13</b>
TC 10			26,64	46,56	0:48	09:01
<b>SS 10</b>	<b>Hagfors 1</b>	<b>19,80</b>				<b>09:04</b>
<b>RZ 6</b>	<b>Remote refuel Hagfors (All competitors)</b>		<b>(2,25)</b>			
	<b>Distance to next refuel</b>	<b>(16,40)</b>	<b>(59,10)</b>	<b>(75,50)</b>		
TC 11			27,73	47,53	0:58	10:02
<b>SS 11</b>	<b>Vargåsen 1 (Live TV Stage)</b>	<b>16,40</b>				<b>10:08</b>
TC 11A	Regroup and Technical Zone IN		33,62	50,02	1:02	11:10
TC 11B	Regroup OUT/Service IN				0:45	11:55
	<b>Service E (Torsby)</b>	<b>(56,12)</b>	<b>(104,35)</b>	<b>(160,47)</b>	<b>0:40</b>	
TC 11C	Service OUT					12:35
<b>RZ 7</b>	<b>Refuel Service Out (All competitors)</b>		<b>(0,00)</b>			
	<b>Distance to next refuel</b>	<b>(39,72)</b>	<b>(45,25)</b>	<b>(84,97)</b>		
TC 12			16,36	16,36	0:30	13:05
<b>SS 12</b>	<b>Torntorp 2</b>	<b>19,92</b>				<b>13:08</b>
TC 13			26,64	46,56	0:48	13:56
<b>SS 13</b>	<b>Hagfors 2</b>	<b>19,80</b>				<b>13:59</b>
<b>RZ 8</b>	<b>Remote refuel Hagfors (All competitors)</b>		<b>(2,25)</b>			
	<b>Distance to next refuel</b>	<b>(16,40)</b>	<b>(96,43)</b>	<b>(112,83)</b>		
TC 14			27,73	47,53	1:03	15:02
<b>SS 14</b>	<b>Vargåsen 2 (Live TV Stage)</b>	<b>16,40</b>				<b>15:08</b>
<b>RZ 9</b>	<b>Remote refuel Deje (All competitors)</b>		<b>(70,95)</b>			
	<b>Distance to next refuel</b>	<b>(4,70)</b>	<b>(135,41)</b>	<b>(140,11)</b>		
TC 14A	Regroup Karlstad IN		99,55	115,95	1:56	17:04
TC 14B	Regroup Karlstad OUT				0:31	17:35
TC 15			1,01	1,01	0:06	17:41
<b>SS 15</b>	<b>SSS Karlstad 2</b>	<b>1,90</b>				<b>17:45</b>
TC 16			104,84	106,74	1:42	19:27
<b>SS 16</b>	<b>Torsby Sprint</b>	<b>2,80</b>				<b>19:30</b>
TC 16A	Technical Zone IN		0,96	3,76	0:20	19:50
TC 16B	Technical Zone OUT/Service IN				0:10	(20:00)
	<b>Flexi Service F (Torsby)</b>	<b>(60,82)</b>	<b>(277,09)</b>	<b>(337,91)</b>	<b>0:45</b>	
TC 16C	Service OUT/Parc Fermé Torsby IN					(20:45)
	All cars must be returned to Parc Fermé no later than					23:00
	<b>Saturday Totals</b>	<b>116,94</b>	<b>381,44</b>	<b>498,38</b>		

Section 4

Section 5

Section 6

## APPENDIX 1 - ITINERARY SUNDAY, SECTION 7-9

Section 7-9		SUNDAY 16 FEBRUARY			Sunrise 07:45 Sunset 16:59	Version 2.1 2019-12-04
TC/SS	Location	SS	Distance Liaison	Total	Target Time	First car due
TC 16D	Parc Fermé Torsby OUT/Service IN					06:25
	<b>Service G (Torsby)</b>	<b>(0,00)</b>	<b>(0,00)</b>	<b>(0,00)</b>	<b>0:15</b>	
TC 16E	Service OUT					06:40
<b>RZ 10</b>	<b>Refuel Service Out (All competitors)</b>		<b>(0,00)</b>			
	<b>Distance to next refuel</b>	<b>(21,19)</b>	<b>(72,33)</b>	<b>(93,52)</b>		
TC 17			53,84	53,84	1:04	07:44
<b>SS 17</b>	<b>Likenäs 1</b>	<b>21,19</b>				<b>07:50</b>
TC 17A	Regroup Ambjörby IN		16,75	37,94	0:40	08:30
TC 17B	Regroup Ambjörby OUT				1:01	09:31
<b>RZ 11</b>	<b>Remote refuel Ambjörby (All competitors)</b>		<b>(1,70)</b>			
	<b>Distance to next refuel</b>	<b>(30,12)</b>	<b>(78,42)</b>	<b>(108,54)</b>		
TC 18			2,74	2,74	0:17	09:48
<b>SS 18</b>	<b>Likenäs 2</b>	<b>21,19</b>				<b>09:51</b>
TC 18A	Regroup Torsby SP IN		66,17	87,36	1:25	11:16
TC 18B	Regroup Torsby SP OUT				0:40	11:56
TC 19			10,76	10,76	0:19	12:15
<b>SS 19</b>	<b>Torsby 2 (Wolf Power Stage)</b>	<b>8,93</b>				<b>12:18</b>
TC 19A	Finish TC and Holding Area		0,49	9,42	0:20	12:38
	Podium Cermony Service Park Torsby					(13:00)
		<b>(51,31)</b>	<b>(150,75)</b>	<b>(202,06)</b>		
<b>Sunday Totals</b>		<b>51,31</b>	<b>150,75</b>	<b>202,06</b>		

TOTALS OF THE RALLY				
	SS	Liaison	Total	%
Thursday 13 february - 1 SS Section 1	1,90	102,33	104,23	<b>0,6%</b>
Friday 14 february - 7 SS Section 2-3	130,69	392,78	523,47	<b>43,4%</b>
Saturday 15 february - 8 SS Section 4-6	116,94	381,44	498,38	<b>38,9%</b>
Sunday 16 february - 3 SS Section 7-9	51,31	150,75	202,06	<b>17,1%</b>
<b>Total - 19 SS</b>	<b>300,84</b>	<b>1027,30</b>	<b>1328,14</b>	<b>22,7%</b>

## APPENDIX 2 - RECONNAISSANCE SCHEDULE

### P1, P2 and P3 Drivers

Version 2.1

2019-12-09

Tuesday 11 February Stage	Allowed Time	SS km	Tot SS km x 2	Finish to Start	To Next Stage	Totals
SS 17/18 Likenäs	08:00-10:00	21,19	42,38	17,95	77,75	138,08
SS 2/5 Hof-Finnskog	10:00-13:00	21,26	42,52	31,15	31,84	105,51
SS 3/6 Finnskogen	11:30-14:45	20,68	41,36	15,14	22,88	79,38
SS 4/7 Nyckelvattnet	12:30-16:15	18,94	37,88	22,22	28,59	88,69
Shakedown Skalla	13:45-17:15	7,21	14,42	5,78	2,89	23,09
SS 8/19 Torsby	14:15-18:00	8,93	17,86	10,96		28,82
<b>Totals</b>		<b>98,21</b>				<b>463,57</b>

Wednesday 12 February Stage	Allowed Time	SS km	Tot SS km x 2	Finish to Start	To Next Stage	Totals
SS 9/12 Torrtorp	08:00-10:00	19,92	39,84	28,55	26,64	95,03
SS 10/13 Hagfors	09:15-11:45	19,80	39,60	14,45	27,73	81,78
SS 11/14 Vargåsen	10:30-13:00	16,40	32,80	7,53	35,04	75,37
SS 16 Torsby Sprint	11:30-14:00	2,80	5,60	3,87		9,47
<b>Totals</b>		<b>58,92</b>				<b>261,65</b>

Thursday 13 February Stage	Allowed Time	SS km	Tot SS km x 2	Finish to Start	To Next Stage	Totals
SS 1/15 SSS Karlstad	17:00-18:00	1,90	3,80	0,00		3,80

### P4 and Non Priority Drivers

Tuesday 11 February Stage	Allowed Time	SS km	Tot SS km x 2	Finish to Start	To Next Stage	Totals
SS 2/5 Hof-Finnskog	08:00-10:00	21,26	42,52	31,15	31,84	105,51
SS 3/6 Finnskogen	09:30-12:00	20,68	41,36	15,14	22,88	79,38
SS 4/7 Nyckelvattnet	10:45-13:30	18,94	37,88	22,22	63,60	123,70
SS 17/18 Likenäs	12:45-16:00	21,19	42,38	17,95	72,68	133,01
Shakedown Skalla	14:45-17:45	7,21	14,42	5,78	2,89	23,09
SS 8/19 Torsby	15:00-18:00	8,93	17,86	10,96		28,82
<b>Totals</b>		<b>98,21</b>				<b>493,51</b>

Wednesday 12 February Stage	Allowed Time	SS km	Tot SS km x 2	Finish to Start	To Next Stage	Totals
SS 11/14 Vargåsen	08:00-10:00	16,40	32,80	7,53	39,49	79,82
SS 9/12 Torrtorp	09:15-12:00	19,92	39,84	28,55	26,64	95,03
SS 10/13 Hagfors	10:45-13:30	19,80	39,60	14,45	65,66	119,71
SS 16 Torsby Sprint	12:30-15:00	2,80	5,60	3,87		9,47
<b>Totals</b>		<b>58,92</b>				<b>304,03</b>

Thursday 13 February Stage	Allowed Time	SS km	Tot SS km x 2	Finish to Start	To Next Stage	Totals
SS 1/15 SSS Karlstad	16:00-17:00	1,90	3,80	0,00		3,80

**APPENDIX 3 - COMPETITORS RELATIONS OFFICERS**



**Janne Rydh**  
**Sweden**  
**(languages: Swedish, English)**



**Jacky Jung**  
**France**  
**(languages: French, English, German)**

## APPENDIX 4 - COMPETITION NUMBERS AND ADVERTISING

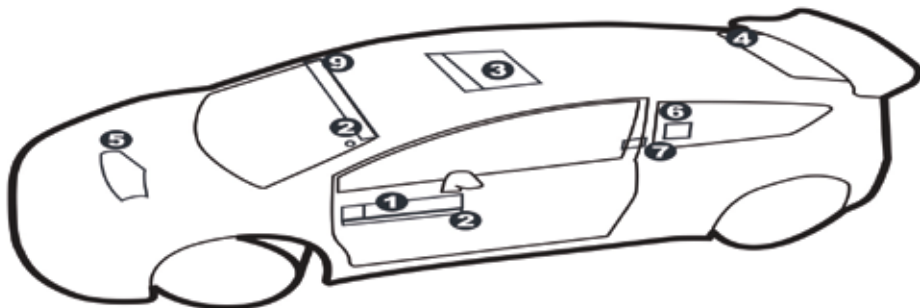

### 1. 2 x Doorplates with competition number

67 cm wide and 17 cm high. The top of the plate shall be placed between 7 cm and 10 cm below the bottom window line. No other signage shall be placed within 10 cm of the plate. Advertising: Will be announced in a bulletin.

2. Each car eligible to score points in the Manufacturers, WRC2, WRC3 or Junior WRC Championships, must affix a specific panel provided by the promotor

### 3. 1 x Roof panel with competition number

50 cm wide and 52 cm high. Placed on the roof with the top towards the front of the car. Advertising: Will be announced in a bulletin.

### 4. 1 x Rear window competition number

14 cm high. Placed at the rear window.

Advertising: Will be announced in a bulletin

### 5. Rally plate with starting number

43 cm wide and 21,5 cm high

### 6. Rear side windows

2 x competition numbers 20 cm high - shall be placed at the top of the rear side windows.

The name of the driver with his/her passport nationality national flag must appear in the rear side window of both sides of the car (under the starting numbers).

For further details see 2020 FIA WRC Sporting Regulations.

### Stickers affixed by the scrutineers at scrutineering:

#### 7. Check card

(10 cm x 6 cm) will be affixed on the car, at roll-cage driver side.

#### 9. 2 minutes sticker

Affixed on the cars (on the roof over the wind screen, codriver side) with a start interval of 2 minutes.

## **APPENDIX 5 - OVERALLS, HELMETS AND OTHER SAFETY EQUIPMENT**

All entrants and drivers are reminded of the Appendix L to the 2020 International Sporting Code, in particular regarding chapter III - Drivers' equipment (helmets, flame-resistant clothing, frontal head restraint (FHR) and safety belts).

These regulations apply to Shakedown as well.

It is permitted that drivers and co-drivers may wear shoes which do not comply with the FIA 8856-2000 standard. Drivers wearing shoes not complying with the standard may wear shoes adapted to the conditions.

**Helmets (Appendix L, Chapter III, Art. 1)**

All crews must wear crash helmets which meet one of the standards listed in FIA Technical List No. 25. Priority 1 drivers must meet the FIA standard 8860-2018 - Advanced Helmet Test Specification (Technical List No. 69).

**Frontal Head Restraint (FHR, Appendix L, Chapter III, Art. 3)** FIA approved systems are mandatory.

The wearing in an international competition of any device intended to protect the head or neck and attached to the helmet is prohibited, unless the device has been homologated according to the FIA 8858 standard. Homologated FHR systems are listed in the FIA Technical List N° 29.

**Flame-resistant clothing (Appendix L, Chapter III, Art. 2)**

All drivers and co-drivers must wear overalls as well as gloves (optional for co-drivers), long underwear, a balaclava, socks and shoes homologated to the FIA 8856-2000 standard (Technical List N°27) or 8856-2018 (Technical List N° 74).

Please pay special attention to the prescriptions of Art. 2 concerning embroidery and printing on flame-resistant clothing (manufacturer certificates etc.)!

**Biometric Devices (Appendix L, Chapter III, Art. 2.1)**

Drivers may wear a device to collect biometric data during racing. - If the biometric device is integrated into a protective garment homologated to FIA Standard 8856, the garment shall be homologated to FIA Standards 8856 and 8868-2018. - If the biometric device is a stand-alone device, then the device must be homologated to FIA Standard 8868-2018 only. This device must be worn in addition to the garment homologated to FIA Standard 8856.

**Wearing of jewellery (Appendix L, Chapter III, Art. 5)**

The wearing of jewellery in the form of body piercing or metal neck chains is prohibited during the competition and may therefore be checked before the start.

## **APPENDIX 6 - FIA SAFETY TRACKING DEVICE - INSTALLATION AND OPERATION INSTRUCTIONS**



### **SAS Fitting Kit Manual – RALLY CAR**



## Welcome

This manual is provided as a guide for the installation of the WRC Tracking System Kit, for competition vehicles only. Care should be taken when considering the location of components with regard to electrical cabling and fire suppression systems already installed in the vehicle. Please check always that the components of your kit are as requested.

## Table of Contents

1. Tracking Unit Kit Components .....	3
2. Power Supply.....	3
3. Connection Diagram .....	3
4. Tracking Unit Dimensions .....	4
5. Tracking Unit Mounting .....	5
6. Antenna Installation .....	6
6.1 External Antenna Installation .....	7
6.2 Internal Antenna Installation .....	8
7. Contact .....	8



## 1. Tracking Unit Kit Components & Steps

The WRC Tracking System Kit includes:

- WRC Tracking Installation and Fitting Kit Instruction Sheet;
- 3-in-1 antenna with leads;
- Internal radio antenna with lead;
- 6 – 24v wiring loom with plug;
- Mount, to be bolted to tunnel;
- Adjustable mount connector/knuckle.



(Contents may differ slightly to image shown)

WRC tracking system fitment steps:

1. Mount WRC tracker;
2. Fit external & internal antennas, running leads to the WRC tracker;
3. Fit wiring loom, ensuring that a solid 9 to 28 volts is supplied;
4. Connect all antenna with plugs, make sure they are tight using an 8mm spanner;
5. Apply power.

## 2. Power Supply

WRC tracking system requires a reliable power supply from 9 to 28 volts DC. We recommend a 5 amp (Max) blade type or similar quality fuse is used at the battery supply end of the WRC tracking system power lead.

Zero volts or battery negative can be picked up at any suitable earthing point providing the isolation switch does not switch the negative side of the battery.

The WRC tracking system unit has an internal battery that is kept charged via the car's power supply. It acts as a reserve supply to power the unit in the case of an accident where a car's power supply is interrupted (e.g. car battery smashed or dislodged).

**Note: The tracking device should only be powered once it is placed in its final position in the vehicle; this ensures accelerometers are calibrated correctly.**

### 3. Connection Diagram

The 6-24v wiring loom, includes five wires. The white blue and grey wires must be stagger cut and heat shrunk or taped back so they cannot short to ground or to each other. Red and black are used as follows:

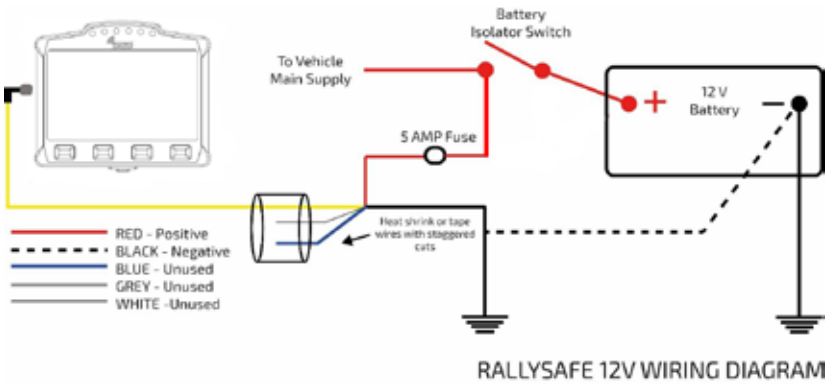

During installation, the wiring loom should be routed away from the engine compartment, Ignition or Alternator wiring.

300 mm of Power Supply Wiring Loom is required to be available for connection to the WRC Tracker Unit at the mounted position.

## 4. Tracking Unit Dimensions

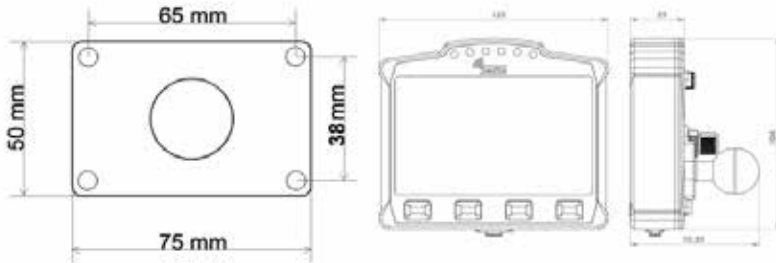

## 5. Tracking Unit Mounting

The preferred location and mounting for the WRC tracking system unit is a RAM style 50mm x 75mm flat base with ball, bolted through the tunnel with four **M6** Bolts.

It should be in a central, protected location on the central tunnel in front of the seats and both easily visible and accessible by both the driver and co-driver/nav.

Care should be taken when considering the location of the Mounting Point with regard to electrical cabling and fire suppression systems installed in the vehicle.

Photographs of mounting and positioning can be seen in Fig.1 and Fig.2 respectively.

Alternatively, the WRC tracking system unit can be mounted in a central protected location on the vehicle dashboard that is easily visible and accessible by both the driver and co-driver.

Mounting is a Ram style 50mm x 75mm flat base with ball, bolted with four **M6** bolts through the dashboard and a compulsory 3mm backing plate measuring no less than 145mm x 120mm



Figure 1. 25mm rubber ball securely attached to the tunnel



Figure 2. The WRC tracking unit mounted onto the 25mm rubber ball mount and connected through the RallySafe connector

## 6. Antenna Installation

All leads on both external and internal antennas must run on the inside of all roll cage bars. This is to stop cable crushing on impact.

Antenna must not be mounted within 200 mm of any high frequency antenna's or cabling

The preferred route is to go down from the antenna, underneath the closest part of the roll cage (roof cross or main hoop), follow that along to the roof hoop, then go down the inside A pillar to the unit. Please allow 200mm clearance of high frequency antenna or cabling

Any excess cable must be run so that the cable is not bent any tighter than a 100mm radius. We recommend running it across the underside of the dash and back (do not coil in tight loops).

Cables must be tied neatly along the whole installation all the way to the unit so they can't be accidentally caught or dislodged.

All this will be checked at scrutineering and you may be required to fix it before your car can pass.

**Note: All antenna connections need to be firmly tightened with an 8mm spanner.**

### 6.1. External Antenna

The antenna is mounted through a 12mm hole in a central location on the ROOF of the vehicle, rear of the main roll bar hoop, allowing the cabling to pass through the roof and follow the cage bars back to the unit location. The antenna is a fully watertight unit, which seals against the roof surface.



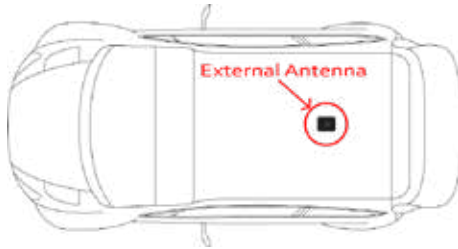

Antenna leads are connected as follows (There may be variations with the type and number of leads).

1. The 2 UHF leads, colour-coded **Blue**, is connected to the terminal labelled "WiFi" on the WRC unit (Right Hand Thread). Terminals are located of the rear of the unit and/or colour-coded Blue.
2. The Satellite Communication antenna lead is connected to the center or rear terminal labelled "IRI" (Left Hand Thread). It may also be colour-coded **Yellow** (this may be not marked on the 2-in-1 antenna).
3. The GPS antenna lead labelled "GPS", is connected to the terminal labelled "GPS" on the WRC unit (Right Hand Thread). Terminals may be on the side or rear of the unit and/or colour-coded **Green**.
4. GSM, has a small stick antenna supplied with the WRC unit, and is connected to corresponding terminal labelled "GSM" on the WRC unit (Left Hand Thread). The terminal is located on the rear of the unit and/or colour-coded **Red**.

## 6.2. Internal Antenna

The Internal Antenna should be placed on the inside of the ROOF in a clear uncluttered area, with a 200mm radius clear of any bar work or solid metal object. The internal antenna has a magnetic base with double-sided tape for adhesion. The cable is then run to the WRC unit. Please keep cable on the inner side of the roll cage pipework so as not to be crushed in the event of an accident.

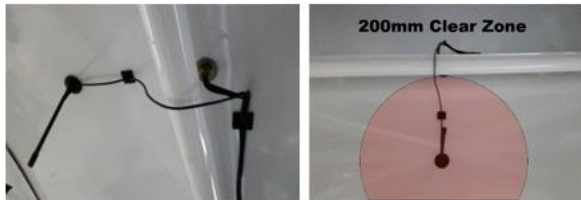

**Figure 3.** The internal antenna must be at least 200mm away from any roll cage components

## 7. Contact Us

For assistance, please contact the RallySafe Support Team by emailing: [support@rallysafe.com.au](mailto:support@rallysafe.com.au)

### \*\*Product Disclaimer\*\*

"This manual, the specifications, and the material contained in it, as released by Status Awareness Systems and RallySafe, is for the purpose of information only. Due to continuous ongoing development, information and specifications may change at any time without notice. SAS, and the companies that have contributed to it, shall not be liable for any use of the manual or information supplied.

The material contained in this manual is protected by copyright and other types of Intellectual Property Rights. The commercial exploitation of the material contained in this specification requires a license to such Intellectual Property Rights.

This manual may be utilised or reproduced without any modification, in any form or by any means, for informational purposes only. For any other purpose, no part of the specification may be utilised or reproduced, in any form or by any means, without permission in writing from SAS.

The word RallySafe and the RallySafe logo are registered trademarks".



## SAS Tracker Competitor User Manual





## Welcome

For your and other competitor’s safety, it is important that you are familiar with the use of the WRC tracking unit, herein referred to as “the unit” or “the WRC tracking unit”.

The SAS System is designed to increase competition safety by providing safety notifications to inform event management, improve response times and provide accurate and reliable event times.

The following document outlines the basic features and functions of the WRC tracking unit. Please note that the WRC Tracking unit must be fitted and connected in all competitor’s car, in accordance with the SAS Fitting Kit Manual – RALLY CAR.

## Table of Contents

1. Powering The Unit On .....	3
2. Stage Modes .....	3
2.1. Transport Mode .....	3
2.2. Stage Mode.....	4
3. Hazard Alerts.....	6
4. Red Flag .....	8
5. Transport Menu .....	9
5.1. Stage Times.....	10
5.2. Manual Hazard.....	11
6. Contact Us.....	11

---

## 1. Powering The Unit On

---

The unit is pre-loaded with all of the stage coordinates and is activated when powered on. Please power the unit on early before the event to give it time to run checks.

When powered on the unit will display the transport mode, the details of which are specified in the Art. 2.1 of this document.

The unit does not need to be powered off at any stage during the event as it will go to sleep within a few minutes of inactivity but can be re-woken by either moving the vehicle or pressing any of the four buttons.

It is recommended that the unit is not powered off during the event, to ensure the internal battery stays fully charged for emergencies.

---

## 2. Unit Modes

---

The unit has two modes:

- When not in a competitive stage, the unit will be in **transport mode**, as described in 2.1.
- When in a competitive stage, the unit will go into **stage mode**, as described in 2.2.

---

### 2.1. Transport Mode

---

**SCREEN 1** – The transport mode displays from the top down the following information: the name of the next point you are travelling to, the time in transit, current time, accumulative and intermediate distances and speed, average speed.

The unit has four physical buttons. Their functions are reported on the screen right above the button's location.

Starting from the far left button to the right, you have the following options:

- **OPTIONS:** Operation described in 5.Transport Menu.
- **BRIGHT:** Increase the screen brightness (Note that the screen must always be clearly readable so full brightness is recommended for daytime).
- **DIM:** Decrease the screen brightness,
- **RESET:** Intermediate trip meter.



SCREEN 1. Transport Mode

## 2.2. Stage Mode

SCREEN 2 – When the start official assigns each individual competitor a due start time, a countdown will display on the unit as shown in the white field below. Also shown in the white field is the stage number and the due start time.



SCREEN 2. Countdown to Stage Start

**SCREEN 3** – Once the start time is reached, the screen will turn green as shown below and the competitor has to proceed into stage.



**SCREEN 3.** Stage Start

**SCREEN 4** – Once the competitor has started the stage, the unit will automatically switch to on stage mode. The unit will start timing.



**SCREEN 4.** Stage mode

**SCREEN 5** – If the start is postponed for whatever reason and the start time is cancelled, the unit will display the Transport Screen. Once it is clear to send cars again the official will re-issue a new start time.



SCREEN 5. Start Time Cancelled

### 3. Hazard Alerts

The unit's primary function is to help alert race control of incidents on the course. The incident is notified to race control with different levels of hazard depending on the severity.

**SCREEN 6** – If a car stops during a stage, the unit will automatically transmit a HAZARD notification; this can either be upgraded to OK or downgraded to SOS by pressing the corresponding button to the text. A timer counts up to 60 seconds as an indication to press the "OK".



SCREEN 6. HAZARD Notification

**SCREEN 7** – If you select OK after the HAZARD alert, then the following screen will appear, showing that you and the car are OK.



**SCREEN 7. OK Acknowledgment**

**SCREEN 8** – If the manual SOS button is pressed, it must be confirmed as either a fire or medical SOS by pressing one of the two middle buttons. It can also be cancelled if pressed by mistake. If a car is involved in a High G impact, an automatic SOS message will display. If no urgent assistance is required, you can downgrade to OK by selecting the corresponding button.



**SCREEN 8. Confirm Fire SOS or Medical SOS**

**SCREEN 9** – When the SOS is confirmed, the screen 9 will display. Even once confirmed, the hazard can be changed to OK. Pressing OK will inform race control that the crew are OK and do not need medical assistance.



SCREEN 9. SOS Notification

## 4. Red Flag

**SCREEN 10** – In the case of a serious incident, a stage may be red flagged from Race Control. The red flag will display a full screen warning until it is acknowledged. To acknowledge the flag the far left button must be pressed.



SCREEN 10. RED FLAG Acknowledge

**SCREEN 11** – Once the red flag has been acknowledged, normal stage functions will display with a warning still at the top of the screen.



SCREEN 11. RED FLAG in Stage Mode

## 5. Transport Menu

**SCREEN 12** – In transport mode, the unit has a menu that can be accessed by pressing the options button.



SCREEN 12. Transport Mode



**SCREEN 13** – The option menu will allow the crew to view stage times “VIEW TIMES” or send a manual hazard/SOS “SEND HAZARD”.



SCREEN 13. Transport Mode – View times/Send Hazard

## 5.1. Stage Times

**SCREEN 14** – By pressing the “VIEW TIMES” button, provisional transit and competitive stage times will display. You can select times for any of the completed stages with the next and previous buttons.



SCREEN 14. Times of completed stages

## 5.2. Manual Hazard

**SCREEN 15** – If manual hazard is sent in transport mode, this can be upgraded or downgraded the same way as a stage hazard. If the hazard is no longer required, it can also be cancelled by pressing either of the two middle buttons “PRESS TO CANCEL”.



SCREEN 15. Manual Hazard in Transport Mode

## 6. Contact us

For assistance, please contact the RallySafe Support Team by emailing: [info@statusas.com](mailto:info@statusas.com)

Please be as descriptive as you can when describing the problem. It would help us if you provide the following information at a minimum:

- Name of event.
- Vehicle or feature affected.
- Stage of incident.
- Time of incident.
- Any additional details.

## APPENDIX 7 - STUDDED TYRES

### RECONNAISSANCE

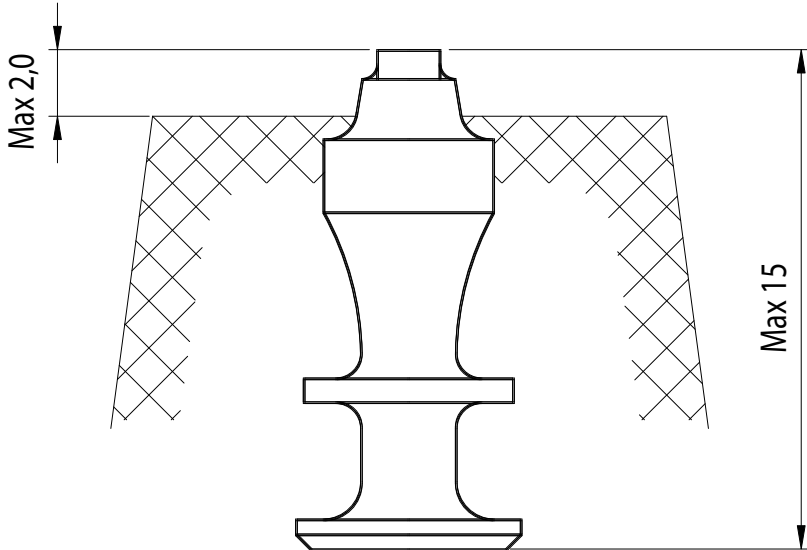

### RALLY

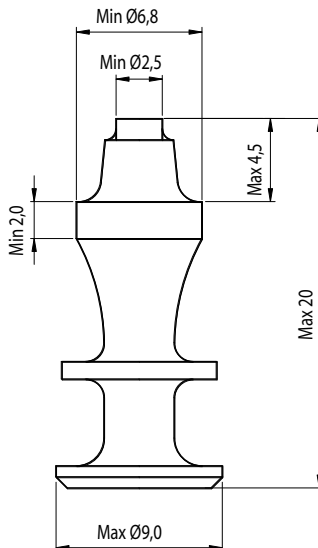

## APPENDIX 8 - SPECIFIC ITEMS FOR NATIONAL CARS

### A8.1 General

Competitors in classes NAT4 and NAT2 must follow all prescriptions of the FIA WRC Sporting Regulations and these Supplementary Regulations (SR), unless stated otherwise or different prescriptions are given in this appendix 8.

National cars may participate in Rally Sweden under the prescriptions of FIA WRC, Art. 12.3, on the following conditions:

- the cars conform with SBF and NBF technical regulations listed below in Art.A8.2.
- the crew and competitor have valid international license's from SBF or NBF
- Noise level must be in conformity with TR 4.

### A8.2 Eligible Cars

The following cars have been accepted for participation by the SBF and NBF:

<b>Class NAT4:</b>		
Homologation No.	Make	Model
NAT 014	Mitsubishi	Mirage
N,A-5660	Mitsubishi	Lancer Evolution VII
N-5673	Mitsubishi	Lancer Evolution VIII MR
N-5688	Mitsubishi	Lancer Evolution IX
N,A-5656	Subaru	Impreza WRX STi (2002), GDB
N,A-5676	Subaru	Impreza WRX STi (2004), GDB
N,A-5695	Subaru	Impreza WRX STi (2005), GDB
A-5729	Ford	Fiesta S2000
A-5721	Skoda	Fabia S2000
A-5705	Peugeot	207 S2000

<b>Class NAT2:</b>		
Homologation No.	Make	Model
N,A-5646	Honda	Civic Type-R
N,A-5881	Ford	Fiesta ST
N,A-5636	Renault	Clio 1.6 16V
N,A-5637	Renault	Clio Sport 2.0 16V
N,A-5659	Renault	Clio RS 2.0 RS

**A8.3 Entries**

Those wishing to take part in Rally Sweden 2020 with a NAT2 or NAT4 must fill in the electronic entry form available at <https://registrations.fia.com/wrcswe>, duly completed before 14 January at 15:00.

The entry will only be accepted if accompanied by the total amount of the Entry Fee. To be accepted, competitors must send a proof of payment of the entry fee by e-mail to the secretary of the event (vera@rallysweden.com) by the closing date of entries. Foreign drivers must submit an approval from their ASN in the same e-mail.

Entry Fee: SEK 20 000 + 6 % VAT (Total: SEK 21 200,-)

Entry package for NAT2 and NAT4 will be the same as for a private entrant, see 4.4.2 in SR

**A8.4 Tyres**

The make and model of tyres for cars in classes NAT4 and NAT2 are free, as long as they are provided with moulded barcode numbers according to FIA WRC, Art. 13.1.4.

The maximum number of tyres permitted to be used during the rally is 26.

When using tyres from an FIA nominated tyre manufacturer as specified in these Supplementary Regulations, Art. 7.1, they must be ordered from the tyre manufacturers no later than 4 weeks before the event with the form given in Rally Guide 2.

**A8.5 Fuel**

All drivers must use FIA fuel as provided by the FIA appointed supplier. All prescriptions of these Supplementary Regulations, Art. 8 apply.

**A8.6 Scrutineering**

All prescriptions of SR, Art. 11 apply, except for sealing and marking, where only turbos and their spare parts will be sealed.

Study carefully the requirements of FIA Safety Tracking Device installation.

National extensions for time limits of any safety equipment (car or driver) do not apply. Extinguishing systems must be installed (Appendix J, Art. 253-7.2).

Anti-torpedo tabs for both mounted systems and manual extinguishers are required.



---

**CLOSER TO RALLY.**

**NOTES**

WARNING MOTORSPORT CAN BE  
**DANGEROUS**

