

2021 26.-28.2.

ARCTIC  
**RALLY®**  
**FINLAND**

POWERED BY Capital Box

# Supplementary Regulations

The logo consists of the word "Capital" in a white sans-serif font, followed by a white square, and then the word "Box" in a white sans-serif font. The background is a blurred image of a blue race car with "Capital Box" and the number "11" visible on its side.

Capital Box

Flexible business financing that helps you

# ACCELERATE YOUR BUSINESS

With CapitalBox business financing you can buy new equipment, hire new employees, increase inventory, or expand the physical business.

- ✓ *Simple online application*
- ✓ *Free early repayment*
- ✓ *Payment holiday privileges*

Learn more at [www.capitalbox.com](http://www.capitalbox.com)  
or visit one of our local pages:

Finland

**[capitalbox.fi](http://capitalbox.fi)**

Sweden

**[capitalbox.fi](http://capitalbox.fi)**

Denmark

**[capitalbox.fi](http://capitalbox.fi)**

Netherlands

**[capitalbox.fi](http://capitalbox.fi)**

Lithuania

**[capitalbox.fi](http://capitalbox.fi)**

# **M. Rautio**

**- absorbent patented  
noise protection  
system**



## **RAUTIO**

**[www.mrautio.fi](http://www.mrautio.fi)**

### **M. Rautio Oy – Installation Contractor**

- Professionals in demanding steel construction and noise abatement systems
- We are a company specializing in steel structures, composite girder bridges and noise barriers
- For over 35 years our enthusiasm for challenges, coupled with our steel structure expertise, has given us extensive experience in noise barrier construction, bridge repair and installation work, and the implementation of various steel structure projects
- Down through the years, we have designed, planned and implemented numerous noise barrier projects across various installation sites.
- We operate on-site where the customer needs our expertise and long experience and we're used to working to tight deadlines. At the construction site, we always try to stay one step ahead, without compromising the work quality
- Founded in Kalajoki in 1983.

# ROVANIEMI

ARCTIC CAPITAL



HOME OF NORTHERN MAGIC

# **Arctic Rally Finland**

## **Powered by CapitalBox**

**26-28 February 2021**

### **Supplementary Regulations**

FIA World Rally Championship for Drivers and Co-Drivers

FIA World Rally Championship for Manufacturers

FIA World Rally Championship for Teams

FIA WRC2 Championship for Drivers and Co-Drivers

FIA WRC2 Championship for Teams

FIA WRC3 Championship for Drivers and Co-Drivers



## Supplementary Regulations

1.	Introduction	7
2.	Organisation and Description	8
3.	Programme	11
4.	Entries	14
5.	Insurance	19
6.	Advertising and Identification	20
7.	Tyres	21
8.	Fuel	22
9.	Reconnaissance	23
10.	Administrative Checks	25
11.	Scrutineering, Sealing and Marking	26
12.	Other procedures	28
13.	Identification of Officials	33
14.	Prizes	34
15.	Final Checks and Protests	35
	Appendix 1 - Itinerary	37
	Appendix 2 - Reconnaissance Timetable	40
	Appendix 3 - Identification Numbers and Advertising	41
	Appendix 4 - Competitors' Relations Officers	42
	Appendix 5 - FIA Safety Emergency Console	44
	Appendix 6 - Drivers' Safety Equipment, Appendix L	44
	Appendix 7 – Studded Tyres	46



**RALLY  
FINLAND**

POWERED BY  
Capital Box





# 1. Introduction

1.1 This rally will be run in compliance with the FIA International Sporting Code (the Code) and its appendices, the 2021 FIA World Rally Championship Sporting Regulations (FIA WRC), the National Sporting Regulations which comply with the FIA regulations and these Supplementary Regulations (SR). In case of any dispute, the English text of these Supplementary Regulations will be binding.

Modifications, amendments and/or changes to these Supplementary Regulations will be announced only by numbered and dated Bulletins (issued by the organiser or the Stewards).

Additional non-regulatory information will be published in Rally Guide (RG), issued on Wednesday 10 February 2021. The 2021 FIA World Rally Championship Sporting Regulations can be found at the FIA website <http://www.fia.com/regulations>.

## 1.2 Road Surface (FIA WRC, Art. 10.1.1)

The special stages will be run on ice and snow.

## 1.3 Overall SS Distance and total distance of the Itinerary (FIA WRC, Art. 10.1.2)

Overall SS distance: 251.08 km

Total distance of the itinerary: 830,88 km

## 1.4 COVID-19 Protocols and Procedures

Due to the on-going pandemic, Finland has closed its borders to all but travel related to essential work and groups with special dispensation. Arctic Rally Finland has been granted such dispensation. In order for us to be able to run the event, the protocols agreed with the Frontier Guard and local Medical Authorities will apply with immediate effect, i.e. also for any travel in conjunction with pre-event testing etc. The following must be adhered to:

- i) All testing protocols concerning entry to Finland and movement within the country (applied to Finnish citizens, too)
- ii) All information must be sent to organiser using the templates given on our website [www.arcticallyfinland.fi](http://www.arcticallyfinland.fi) under Covid-19 section.
- iii) Sufficient time must be reserved for the test results to be valid when entry to event areas is necessary.
- iv) Each participant is responsible for following the Authorities' Covid-19 protocols and recommendations also in their spare time, i.e. staying within their group bubble when in accommodation, eating in their agreed dining areas, using medical masks, keeping social distance and taking care of hand hygiene.



POWERED BY  
Capital Box



Read carefully Art. 2.12 of these regulations and all information given at <https://arcticrallyfinland.fi/en/covid-19/>, any news will be published at this address.



## 2. Organisation and Description

### 2.1 FIA Titles for which the Rally counts (FIA WRC, Art. 5-7)

FIA World Rally Championship for Drivers and Co-Drivers

FIA World Rally Championship for Manufacturers

FIA World Rally Championship for Teams

FIA WRC2 Championship for Drivers and Co-Drivers

FIA WRC2 Championship for Teams

FIA WRC3 Championship for Drivers and Co-Drivers



### 2.2 Visa Numbers - FIA and ASN (FIA WRC, Art. 20)

FIA Visa no.: TBA

ASN Visa no.: 30/R/21 issued on 22 January 2021

### 2.3 Organiser's Name, Address and Contact Details

AKK Sports Ltd.

Postal address:

AKK Sports Ltd.

Arctic Rally Finland

P.O.Box 19

FI-01301 Vantaa

Visitors'/Courier address:

Kellokukantie 7, FI-01300 Vantaa

e-mail rally@autourheilui.fi

internet www.arcticrallyfinland.fi

Organiser's telephone numbers can be found from the event website and from Rally Guide.

### 2.4 Organisation Committee

CEO/Chairman

Chief Scrutineer

Secretary of the Rally

National Press Officer

Assistant Clerk of the Course

Chief Safety Officer

Chief Medical Officer

Route Manager

Mr. Riku Bitter

Mr. Kari Erola

Mr. Henrik Frank

Mrs. Linda Hirvonen

Mr. Heikki Isomaa

Mr. Mika Häyhänen

Dr. Markus Lyyra

Mr. Juha Kenttämää



Event Coordinator  
Deputy Clerk of the Course  
Results Officer  
Clerk of the Course  
Service Park Manager  
Chief Timekeeper  
Chief Rescue Officer

Ms. Tiina Lehmonen  
Mr. Kari Nuutinen  
Ms. Jaana Outila  
Mr. Kai Tarkiainen  
Mr. Tuukka Terva-aho  
Mr. Petri Tilus  
Mr. Jari Wilén

## 2.5 Stewards (FIA WRC, Art. 11.1)

Chairman

Mr. Iain Campbell (GBR)  
Ms. Emilia Abel (EST)  
Mr. Heikki Poranen (FIN)  
Ms. Yvonne Gilli

Secretary of the Stewards

## 2.6 FIA Delegates (FIA WRC, Art. 11.2)

Sporting Delegate  
Media Delegate  
Medical Delegate  
Safety Delegate  
Deputy Safety Delegate  
Technical Delegate  
Deputy Technical Delegate  
Assistant to Technical Delegate  
Assistant to Technical Delegate  
Assistant to Technical Delegate

Mr. Timo Rautiainen  
Ms. Vera Dussausaye  
Dr. Cem Boneval  
Ms. Michèle Mouton  
Mr. Nicolas Klinger  
Mr. Jérôme Toquet  
Mr. Karmo Uusmaa  
Mr. Emanuele Saglia  
Mr. Daniel Fasano  
Mr. Bruno Martinez

## 2.7 Senior Officials

In addition to the members of the Organising Committee (see Art. 2.4):

Assistant Secretary of the Rally  
Safety Officer  
Covid-19 Medical Officer  
Deputy Chief Medical Officer  
Assistant Press Officer  
Radio Communications  
Competitors' Relations Officer  
Competitors' Relations Officer

Mrs. Viivi Firat  
Mr. Mika Häyhänen  
Dr. Risto Kinnunen  
Dr. Niko Neuvonen  
Mr. Timo Korkalainen  
Mr. Matti Heikinoja  
Ms. Jonna Hautala  
Ms. Katriina Keskiniva

## 2.8 Location of Rally HQ

Santasport  
Hiihtomajantie 2, Rovaniemi  
e-mail rally@autourheilu.fi

## 2.9 Official Notice Board location





ARCTIC  
RALLY  
FINLAND

POWERED BY  
Capital Box



## 2.10 General Communication during the event

During the event, individual and general communication between all rally officials (rally control/CoC, rally secretariat, CRO, stewards, technical staff etc.) and the competitors/crew members will primarily and as far as possible be conducted electronically (Cellphone, e-mail, Sportity, WhatsApp). For this purpose, each competitor is required to nominate one official representative authorised for the purpose of receiving any official notifications, along with the respective contact (cellphone, e-mail, WhatsApp). This contact must be notified before Monday 22 February 2021.

This contact will be used both for general and individual communications. Any confirmation of receipt, if required, must mandatorily also be returned by this contact to the Secretary of the Rally:

Henrik Frank, Phone / WhatsApp: +358 40 5349977,  
e-mail: [henrik.frank@autourheilu.fi](mailto:henrik.frank@autourheilu.fi)

As provided for in FIA ISC Art. 11.9.4, the Official Notice Board will be the virtual notice board, published on the Event website. There will be no physical official notice board.

All competitors will be informed by e-mail/WhatsApp about the publication of any documents on the digital notice board.

Additionally, rally documents will also be available in the Sportity app (downloadable for iOS devices on Appstore and for Android devices on Google Play). Password is **ARF2021**.

## 2.11 Restriction on the number of Attendees

Each Stakeholder has been asked to fill in a questionnaire and name all Attendees who need to be accredited for the access to the Rally HQ or Service Park (High Density Areas - Profile 1 Attendees). This list includes everyone that requires the access to these areas. The accreditation is personal and there is no option to grant access to additional guests or sub-contractors. If the person is not on the Stakeholder list, the person would not have any access to High Density Areas. The number of Attendees per team is defined with reference to App. VI of the 2021 FIA WRC Sporting Regulations as follows:

- Manufacturer Team – 3 Cars 71
- Manufacturer Team – 2 Cars 60
- WRC Team 15
- WRC2 Team – 2 Cars 25
- WRC2 Team – 1 Car 12
- WRC3 Team 8
- Other RC1 Car 10

- Other Private Team of Legal Competitor 12
- Other Private Team 8

The above numbers include also the crews, ie. drivers/co-drivers

There will be a separate list of attendees to be accredited to the Low Density Areas ( Profile 2 Attendees) of the event. Based on the health and safety regulations agreed with Finnish authorities, all attendees to the event, no matter what their role or location is, must be accredited according to the criteria given in the Event Covid-19 Code, which will be published at a later date.

## 2.12 Process for documentation submission for the Arctic Rally Finland (COVID-19 Code Art. 6.5)

All Stakeholders/Attendees are required to submit;

1. an FIA Attendee List to the rally organiser and FIA (template on rally website)
2. signed Attendee FIA Commitment form from all Attendees (template on rally website)
3. a pdf copy of the PCR test taken before leaving home, sent to the organiser (covid-19@autourheilu.fi) and it must not be more than 72 hours old on arrival to border
4. an individual online form giving all the data necessary for the Frontier Guard and Health & Safety authorities
5. a proxy for the delivery of test results from Organiser's nominated Test Provider (filled and returned to organiser and kept with when arriving to the test)
6. themselves to a new test (can be Antigen or PCR) on arrival to Finland (border or Rovaniemi), more info on event website

The required Attendee list(s), Attendee Commitment forms and online forms described above must be submitted by 16:00 on Fri 12th February 2021, either online or by email to:

covid-19@autourheilu.fi and copied to covid19\_WRC@fia.com

## 2.13 Medical face masks (ISC, App. S, Art. 2.1)

The wearing of a medical face mask is mandatory in all High Density areas.

## 3. Programme

### Monday 1 February 2021

Opening date of Entries.

Opening date of online application for International Media accreditation (print, radio, electronic)

### Monday 8 February 2021 at 18:00 (17:00 CET)

18.00 Closing date for entries, closing date for co-driver details  
Closing date for tyre orders



POWERED BY  
Capital Box



### Wednesday 10 February 2021

18.00 Rally Guide, Road Book and Route Map available

### Thursday 11 February 2021

Closing date for International Media Accreditation

Closing date for National Media Accreditation (print, radio, electronic)

### Friday 12 February 2021

16.00 Closing date for submitting Covid-19 documents

Publication of Draft Entry List (Subject to FIA approval)

Closing date for FIA fuel orders

Closing date for radio license application

All service area requests must reach the organiser

Helicopter registration forms must reach the organiser

### Tuesday 16 February 2021

Publication of Media Safety Guide

Website

### Monday 22 February 2021

08.00 Service Park opens for Manufacturers/Teams

SP Santasport

Virtual Official Notice Board (VONB) available

Website

### Tuesday 23 February 2021

08.00 Service Park starts to operate under High Density Area rules

08.00 Service Park opens for all competitors

SP Santasport

10.30-14.00 Promotional event for invited drivers

Arctic Circle

14.00 Media accreditation opens

Rally HQ

14.00 Media Centre opens

Rally HQ

14.00-21.00 Rally Office open

Rally HQ

14.00-21.00 Collection of reconnaissance GPS trackers (all drivers)

Rally Office

(By appointment)

14.00-21.00 Collection of ALL documents and materials (all drivers)

Rally Office

(By appointment)

### Wednesday 24 February 2021

07.30-20.00 Rally Office open by appointment

Rally HQ

(please contact Secretary of the Rally by phone)

08.00-18.00 Day 1 of reconnaissance, Group A (details in Appendix)

08.00-19.00 Day 1 of reconnaissance, Group B (details in Appendix)

16.00 Team Managers' Meeting (invitation link to be sent)

16.00-20.00 Collection of FIA Safety Emergency Console SAS Workshop in  
Service Park



## Thursday 25 February 2021

07.30-21.00	Rally Office open by appointment (please contact Secretary of the Rally by phone)	Rally HQ
08.00-14.00	Day 2 of reconnaissance, Groups A and B (details in Appendix)	
08.00-11.00	Technical sealing, WRC Manufacturers	SP Santasport
11.00-12.00	Scales available, WRC Manufacturers	SP Santasport
12.00-14.00	Collection of FIA Safety Emergency Console	SAS Workshop in SP
14.00-22.00	Scrutineering, sealing and marking	REDU, Marttiintie
15.00-17.00	Return of reconnaissance trackers	SAS Workshop in SP
16.00	Helicopter pilots' briefing (invitation link to be sent to attendees)	
18.00	Drivers' Safety Briefing, summoned by the COC (invitation link to be sent to attendees)	
19.00	Publication of Start List for Shakedown	VONB
19.00	FIA Pre-Event Press Conference (By video conference - Link to be sent to participants)	



## Friday 26 February 2021

08.00-22.30	Rally Office open	Rally HQ
08.31-09.30	Shakedown for P1 and nominated drivers	Vennivaara
09.31-11.00	Shakedown for all Priority drivers (Optional)	Vennivaara
10.00	Publication of start list for Section 1	VONB
11.01-12.30	Shakedown for non-priority drivers (Optional)	Vennivaara
13.30	Start of the rally	SP Santasport
21.33	Overnight Parc Fermé	Sampokeskus
22.00	Publication of start list for Section 3	VONB

## Saturday 27 February 2021

07.00-22.30	Rally Office open	Rally HQ
07.30	Start Section 3	Rally HQ
21.23	Overnight Parc Fermé	Sampokeskus
22.00	Publication of start list for Section 5	VONB

## Sunday 28 February 2021

08.15-18.30	Rally Office open	Rally HQ
08.45	Start Section 5	Rally HQ
13.18	Start of Wolf Power Stage Podium - Prize-giving	Aittajärvi Aittajärvi
15.30	FIA Post-Event Press Conference (By video conference - Link to be sent to participants)	
15.30	Final scrutineering	REDU
18.00	Publication of provisional classification	VONB
20.00	All cars must be removed from the final parc fermé	

SP Santasport  
(provided that the Stewards have authorised the opening of  
the parc fermé)



POWERED BY  
Capital Box



## 4. Entries

### 4.1 Close of Entries (FIA WRC, Art. 23)

Close of entries is Monday 8 February 2021 at 18.00 (17.00 CET).

### 4.2 Entry Procedure (FIA WRC, Art. 22)

Any non-priority driver wishing to take part in Arctic Rally Finland 2021 must fill in the electronic entry form published on the FIA website :

<https://registrations.fia.com/wrcarc> at the same time with Supplementary Regulations. Please note that as the FIA system requires a user ID and a password to access the entry system, leave time for the FIA to open your user account. The user account application can be found through a link from the registration page as given above.

Competitors in the FIA Manufacturers/Teams, WRC2 and WRC3, who wish to enter our event to collect points in their respective championships must use the standard FIA electronic entry form available at <https://registrations.fia.com>. Any driver in the WRC3 Championship wishing to enter Arctic Rally Finland, but not wishing to collect points for the championship, must use the non-priority entry form as detailed above.

By sending an electronic form, the competitor undertakes to abide by the rules and regulations of the competition, as well as the prescriptions of FIA WRC, Art. 22.5. Competitors will sign the entry form at the Administrative Checks.

The entry application will be accepted only if accompanied by:

- The total amount of the entry fee
- Scanned pdf copy of the entry fee payment
- Scanned pdf copies of the competitor, driver and co-driver valid competition licenses
- Scanned pdf copies of the driver and co-driver valid driving licenses
- One passport photo for each member of the crew
- Scanned pdf copy of the first page of the car's homologation form with the number, group and cylinder capacity
- Scanned pdf copy of a Signed Entry Form (rally secretariat will send dedicated entry form to all competitors by e-mail, and the signed and scanned copy must be returned including competitor, driver and co-driver signatures before the administrative checks)

Photocopies and photos must be sent via survey form, which address will be published at the event website.

If a competitor cannot make the entry on the internet, he must contact the rally secretariat



before close of entries for further instructions.

Competitors and drivers who wish to take part in an international competition organised abroad can only do so with the approval of their own ASN.

## 4.3 Number of competitors accepted and Classes (FIA WRC, Art. 12.4)

### 4.3.1 Number of competitors accepted

There is no limit to the number of competitors. However, should the number of entries effect a safe running of the event according to the planned itinerary, the organiser reserves the right to select the competitors accepted. Competitors will be divided into Priority drivers (in accordance with FIA WRC, Art. 9) and non-priority drivers.

### 4.3.2 Classes

Classes will be as follows (for details, see FIA WRC, Art. 12.4):

Classes		Groups
RC1	<b>World Rally Cars:</b> 1.6 T engine	<ul style="list-style-type: none"> <li>• World Rally Cars, complying with the 2021 Appendix J, Art. 255A, when driven by a driver who has obtained the approval of the FIA</li> <li>• World Rally Cars homologated before 31.12.2013, complying with homologation extension 100/01 KSR and its WR extension, and with the 2013 Appendix J, Art. 255A. Only WRC cars with an FIA passport issued before 31/12/2016 are allowed</li> <li>• World Rally Cars homologated as from 01.01.2014, complying with homologation extension 200/01 WRC and with the 2016 Appendix J, Art. 255A. Only WRC cars with an FIA passport issued before 31/12/2016 are allowed.</li> <li>• World Rally Cars homologated as from 01.01.2015, complying with homologation extension 300/01 WRC and with the 2016 Appendix J, Art. 255A. Only WRC cars with an FIA passport issued before 31/12/2016 are allowed.</li> </ul>
RC2	Group <b>Rally2</b>  Group <b>Rally2 Kit</b>	<ul style="list-style-type: none"> <li>• Group Rally2 cars conforming to the 2021 Appendix J, Art. 261.</li> <li>• Car fitted with Rally2 Kit cars confirming to the 2021 Appendix J, Art. 260E</li> </ul>

RGT	<b>RGT cars</b>	<ul style="list-style-type: none"> <li>• Group RGT cars conforming to the 2019 Appendix J, Art. 256.</li> <li>• Group RGT cars conforming to the 2021 Appendix J, Art. 256</li> </ul>
RC3	<b>Rally3</b> (atmo over 1390cc and up to 2000 cc and turbo over 927cc and 1620cc)	<ul style="list-style-type: none"> <li>• Group Rally3 cars homologated from 01/01/2021 and conforming to the 2021 Appendix J, Art. 260</li> </ul>
RC4	<b>Rally4</b> (atmo over 1390cc and up to 2000cc and turbo over 927cc and up to 1333cc)	<ul style="list-style-type: none"> <li>• Group Rally4 cars homologated from 01/01/2019 and conforming to the 2021 Appendix J, Art. 260</li> <li>• Group R2 cars homologated before 31/12/2018 and conforming to the 2018 Appendix J, Art. 260</li> </ul>
	<b>R3</b> (atmo/over 1600cc and up to 2000cc and turbo over 1067cc and up to 1333cc)	<ul style="list-style-type: none"> <li>• Rally4 (atmo over 1390cc and up to 1600cc and turbo over 927cc and up to 1067cc)</li> </ul>
	<b>R3</b> (turbo/up to 1620cc/nominal)	<ul style="list-style-type: none"> <li>• Group R cars homologated before 31/12/2019 and conforming to the 2019 Appendix J, Art. 260D</li> </ul>
RC5	<b>Rally5</b> (atmo up to 1600cc and turbo up to 1333cc)	<ul style="list-style-type: none"> <li>• Group Rally5 cars homologated from 01/01/19 and conforming to the 2021 Appendix J, Art. 260</li> </ul>
	<b>Rally5</b> (atmo up to 1600cc and turbo up to 1067cc)	<ul style="list-style-type: none"> <li>• Group R1 cars homologated before 31/12/2018 and conforming to the 2018 Appendix J, Art. 260</li> </ul>



**ARCTIC**  
**RALLY**  
**FINLAND**

POWERED BY  
Capital Box



#### 4.4 Entry Fees (FIA WRC, Art. 24) and Packages for Private Competitors

Entry fees for the various categories are as described below. For information on payment of Finnish Value Added Tax (VAT), see Rally Guide.

##### Service Park Area:

Competitors must indicate the size of the Service Park area in their FIA website entry form by attaching a PDF area lay-out with measurements under "Document files".

## Manufacturers/Teams, WRC 2 and WRC 3:

As per FIA WRC 2021, Appendix VI, and local VAT added (24%), see also Art. 4.5.

## Further RC1 Cars:

As per FIA WRC 2021, Appendix VI, and local VAT added (24%), see also Art. 4.5.

Other entries by legal entities (Classes RC1-RC5, RGT):

- a. Legal entity carrying the optional Rally organiser's advertising:  
 $6\,700\text{ €} + 24\% \text{ VAT} = 8\,308\text{ €}$
- b. Legal entity not carrying the optional Rally organiser's advertising:  
 $8\,700\text{ €} + 24\% \text{ VAT} = 10\,788\text{ €}$

## Private entries (Classes RC1-RC5, RGT):

Entry fee for one car (competitor must be the driver or the co-driver):

- a. Private competitor carrying the optional Rally organiser's advertising:  
 $3\,700\text{ €} + 24\% \text{ VAT} = 4\,588\text{ €}$
- b. Private competitor not carrying the optional Rally organiser's advertising:  
 $5\,700\text{ €} + 24\% \text{ VAT} = 7\,068\text{ €}$

## Legal entity as competitor:

- ASN, Company, Team or a Sporting Association holding a Competitor's Licence, who enters one or more cars.
- A person holding a Personal Competitor's Licence, but who is not a member of the crew, and who enters one or more cars.

## Private competitor:

- A member of the crew holding a Personal Competitor's License, who enters his own car and competes under his/her own name.

Contents of entry packages for Manufacturers/Teams, RC1 cars and Support Championship entries (WRC 2 and WRC 3): See Appendix VI of FIA WRC 2021 Regulations.

The following table describes the contents of the package for competitors.



Product	Legal entity as competitor	Private competitor
Vehicle Plates		
Service Plates	2	2
Auxiliary Plates	2	-
Passes		
Service Passes	6	6
Driver Passes	2	2
Administration		
Supplementary Regulations	Only available at event website.	
Route Maps	4	2
Road Books	3	2
Official Programmes	Only available at event website.	
Rally Guide	Only available at event website.	
Results	Only available at event website.	
Service Park Area	15x10 m	10x10 m



**ARCTIC**  
**RALLY**  
**FINLAND**

POWERED BY  
Capital Box



Before the event, all materials available only at event website. Hard copies of Road Books and Maps are provided at material collection.

Cost for additional service space in Service Park area is 45 € + VAT 24% /m<sup>2</sup> = 55.80 €/m<sup>2</sup>. Requests received after 12th of February will only be considered for a doubled price, if at all.

#### 4.5 Payment details

The entry fee must be paid by bank transfer to the organiser's bank account:

Name of the bank: Nordea Pankki Suomi  
Address: 1555 Nordea Järjestöpankki  
BIC/SWIFT code: NDEAFIHH  
IBAN account no: FI90 1454 3000 1039 71

Please note that foreign payments are only accepted if the IBAN account number is used! All expenses for the bank transfer are payable by the competitor. Cheques are not accepted. Please note that the amount is payable in Euros only.

## 4.6 Refunds (FIA WRC, Art. 24.3-4)

Entry fees will be refunded in full

- a. to candidates whose entry has not been accepted
- b. in case of the rally not taking place
- c. in case a competitor cannot enter Finland due to pandemic travel restrictions beyond their control

If a competitor is denied entry to Finland due to missing travel documents or inadequate or missing Covid-19 documentation, the organiser may keep a minimum 50% of the entry fee to cover any costs incurred.

Organisers may refund 50% of the entry fee to those competitors who, for other reasons of *force majeure* (duly certified by their ASN), were unable to start in the rally. With the request of entry fee refund the competitor must send the organiser a certificate of force majeure given by his own ASN.

## 5. Insurance (FIA WRC, Art. 21)

### 5.1 Traffic Insurance (obligatory)

All cars participating in the rally must have a valid obligatory traffic insurance towards third parties. In Finland the 'Green Card' (International Motor Insurance Card) system is applied. For cars coming from countries outside the Green Card system and EEA-countries, a Nordic frontier insurance must be taken at the Danish, Finnish, Norwegian or Swedish border. Traffic insurance guarantees competitor's cover for civil responsibility towards third parties. The organiser will issue third party insurance cover for foreign drivers valid on special stages for cars registered abroad. Insurance certificate together with a special sticker will be handed to the teams before the start of the Shakedown. For this purpose, a temporary import declaration must be made to the Finnish Inland Revenue, for details see Rally Guide.

All competitors **MUST** be able to show their Green Cards at the administrative checking. The burden of proof for a valid insurance rests solely on the competitor.

### 5.2 Insurance Coverage

Cover per each instance

- property damages                      max. € 10 000 000
- bodily injuries    no limit of indemnification

### 5.3 Limitation of Indemnity (FIA WRC, Art. 21.3)

The organiser declines any liability concerning the consequences caused by any fraudulent action taken by the competitor, may this be against the rules and regulations of the rally or against the laws of the country.



RALLY  
FINLAND

POWERED BY  
Capital Box



WRC  
CHAMPIONSHIP

Any service vehicles or reconnaissance cars, even those bearing the official identification of the organiser, may under no circumstances be considered as official participants of the rally, hence their insurance policies remain the sole responsibility of the owner.



POWERED BY  
Capital Box



## 6. Advertising and Identification (FIA WRC, Art. 27-29)

### 6.1 National Restrictions on Advertising

#### **Tobacco**

Advertising of tobacco, tobacco products and imitations, as well as smokers' requisites is forbidden according to the Finnish legislation on cars, competition/service equipment and on the team members' outfits.

#### **Alcohol**

The advertising of alcoholic beverages is limited according to the Finnish legislation to mild alcoholic beverages with maximum 22% alcohol in volume. For detailed limitations and more information, see:

<http://www.valvira.fi/web/en/alcohol/advertising>.

#### **Gambling**

All gambling in Finland is regulated by the Lotteries Act from 2002. Only company allowed to run lotteries or gambling in Finland (and to advertise such services) is Veikkaus. All other advertising is forbidden. For more information, please contact [arpajaishallinto@poliisi.fi](mailto:arpajaishallinto@poliisi.fi) (responsible department at the National Police Board).

### 6.2 Organiser's Advertising

On the competition numbers the advertising will be CAPITAL BOX. The Rally organiser's optional advertising below the rear side window on both sides of the competing car will be ROVANIEMI Arctic Capital (see Art. 4.4).

### 6.3 Identification

Competition numbers are as per FIA WRC, Art. 27 and Appendix 3 of these Supplementary Regulations. These must be visible through the whole duration of the rally. Pay attention to FIA WRC, Art. 29.5 on Championship identification.

The following stickers will be placed on the car by the officials:

- at scrutineering: "Scrutineered" sticker below the left rear side window.
- before start: a "3 min" sticker on the front right-hand corner of the roof for competitors with a start interval of 3 minutes.



## 7. Tyres (FIA WRC, Art. 13-15)

### 7.1 Tyres specified for Use during the Rally

In addition to complying with Art. 13, 14 and 15 of FIA WRC sporting regulations, the types of tyres accepted for use in Arctic Rally Finland are given in the table below.

In accordance with FIA WRC, Art. 15.1, the maximum number of tyres used during the rally is 20 for WRC cars and 18 for all other cars. Additional 4 tyres will be allowed for any car taking part in the Shakedown.

Pirelli		
Tyre	List 1 Tyres (WRC) FIA WRC Art. 13.2.1	List 2 Tyres (Other 4WD) FIA WRC Art. 13.2.1
First Choice	205/65R15 RFID J1A left 205/65R15 RFID J1A right	205/65R15 RFID J1A left 205/65R15 RFID J1A right
Alternative Choice	N/A	N/A

All competitors are reminded of the prescriptions of FIA WRC, Art. 13.1.4. Study carefully the prescriptions of Art. 13 of FIA WRC. All 4WD cars may only use tyres from the FIA-nominated tyre company (as above).

#### 13.1.4 BARCODE NUMBER

Each tyre must have either:

- Two identical moulded barcode numbers (one on each side of the tyre / each barcode having a different colour as defined by the FIA) supplied by the 2021 FIA-approved barcode supplier, or:
- A single moulded barcode number supplied by the 2021 FIA-approved barcode supplier. These barcodes will be used to check that the same tyres remain fitted to a particular car between tyre changes and that competitors are not exceeding the maximum quantities allowed. The tyre barcode must always be visible from outside the car.

### 7.2 Tyres for Reconnaissance (FIA WRC, Art. 35.2)

Studded tyres may be used during reconnaissance. They must be M+S type and in conformity with the Finnish Road Traffic Law (see Finlex 408 / 2003). No special tyres are permitted during the reconnaissance. Any infringement to this rule will be reported to the Stewards, who will consider a penalty according to the International Sporting Code Art. 12.

### 7.3 Studded tyres during the event

Studded tyres may be used during the event. They must be in conformity with 2021 WRC

- The studs shall be solid, cylindrical and flatcut
- The cross section of the studs must form a full circle at every point
- The stud is not allowed to be tubular at any point
- The body of the stud must be homogenous and is not allowed, under any circumstances to form a tube or hole.
- Maximum diameter of the flange is 9 millimetres
- Minimum diameter of the metal core in the middle of the stud is 2,5 millimeters. It must be cylindrical, homogenous and flatcut
- The length of the stud is limited to 20 millimeters
- The weight of the stud is limited to 4 grams
- The studs must be mounted in to the tyre from the outside
- The number of studs must not exceed 20 per any decimeter of the wheel circumference

Any infringement to this rule will be reported to the Stewards, who will consider a penalty according to the International Sporting Code Art. 12.

### 7.3.1 Method for checking the number of studs

Measurement will be carried out with a pattern, on a non-pressured part of the tyre. The length of the pattern is 30 cm, and within the pattern there must not be more than 60 studs. If the number of studs is more than 60 in a 30 cm section, a further check will be carried out in the next 30 cm section and the total number of studs in both sections must be maximum 120.

## 7.4 Tyres for drivers entered with a 2WD car

Tyres for a non-priority driver with a 2WD car must conform with the 2021 FIA WRC SR Art. 13.3.

At pre-rally scrutineering, the tyre manufacturer will be recorded by the FIA. For a given rally, all tyres used by a driver must come from the same tyre supplier.

## 7.5 Tyres for Overnight Parc Fermé

Non-registered pattern road-homologated M+S tyres (with or without studs) may be used by all competitors for the road sections Service Park – Parc Fermé – Service Park. Competitors are reminded of the prescriptions of FIA WRC, Art. 13.7 concerning the make of such tyres. Cars may enter the Parc Fermé also with tyres used in the rally.

# 8. Fuel (FIA WRC, Art. 61-62)

## 8.1 Ordering Procedure and Price per Litre

Use of FIA Fuel is mandatory for all drivers. The supplier appointed by the FIA for 2021 is TOTAL Additif et Carburants Speciaux, which will carry out fuel ordering, supply and refuel services.

Non-Priority drivers must use FIA fuel following the same conditions and rules as the Priority drivers. For environmental and safety reasons no refuelling is allowed in the Service Park (no refuel from cans, drums or similar).

To execute the fuel order, the completed registration form must be e-mailed to [mehmet.basar@total.com](mailto:mehmet.basar@total.com).

The order form issued by TOTAL Additifs et Carburants Speciaux is available on the event website at [www.arcticrallyfinland.fi](http://www.arcticrallyfinland.fi).

The cost of the fuel and refuel services is € 5.60 € + VAT per litre, dispensed into rally cars. It is a condition of supply that payment must be received in full before delivery can be made. The balance of non-used fuel will be credited after the rally.

## 8.2 Closing date for ordering FIA fuel

All competitors must place their fuel order with payment directly with TOTAL no later than Friday 12 February 2021.

## 8.3 Refuel during the Rally

FIA fuel will be available in the service park refuel zone after TC 0, 2G, 5C and 8G, and in remote locations according to the itinerary of the rally (Appendix 1).

# 9. Reconnaissance (FIA WRC, Art. 35)

## 9.1 Procedure for Registration

There is no physical registration as such. All reconnaissance and rally materials may be collected by the nominated competitor representative, holding a written proxy and following Event Covid-19 Code, as follows:

Date and time: Tuesday 23 February 2021 14.00-21.00

Place: Rally HQ, Santasport

The competitor must send the organiser in advance an information sheet (see Website/ Rally Guide) including details of the reconnaissance car, mobile phone number and place where the competitor is accommodated.

Priority groups are as follows:

**Group A:** All priority drivers

**Group B:** non-priority drivers

Should the groups after the close of entries prove unproportionate, the organiser reserves the right to change this in a Bulletin.



POWERED BY  
Capital Box



The reconnaissance car identification must be attached as follows and kept visible for the whole duration of the reconnaissance period:

1. Priority group identification (yellow or white) on the left and the right rear side windows
2. Competitor numbers (orange) both on the windscreen and the rear window (top centre)

After the end of reconnaissance as scheduled in Appendix 2, all reconnaissance identification must be removed from the reconnaissance vehicles.

## 9.2 Specific and National Restrictions

### A. General Running of the Reconnaissance

Provision is made for a maximum of two passages through each special stage for each entered crew during the reconnaissance. This regulation concerns also the special stages which are driven more than once, either in their entirety or in part.

The crews are not allowed to drive in the opposite direction of the rally on the special stages, unless given particular instructions to do so by the organiser, their representative or the police.

Each car must carry two snow shovels, a tow rope and warm clothes, hats, mittens and shoes for driver and co-driver. In case of an accident with a reindeer, the police must immediately be informed at tel. 112. See Rally Guide for more information.

The progress of the crews will be followed on the special stages by officials, who mark the time and competitor number to a check sheet at each stage arrival and STOP control. Cars must stop at these locations and the marking on the check sheet will be shown to them through the car window.

### B. Traffic and Reconnaissance Vehicles

A maximum speed limit of 80 km/h is imposed on all special stages during reconnaissance unless a lower limit is indicated by traffic signs or by signs placed by the organiser.

The competitors must drive in a manner that does not endanger or inconvenience other traffic or people living near the stages. The organiser will control speeds used as well as the manner of driving during reconnaissance. The police will penalise traffic infringements according to Finnish Traffic Law.

It is emphasised that reconnaissance is not practice. All the Road Traffic Laws of Finland must be strictly adhered to and the safety and rights of other road users must be respected and reconnaissance cars have to be covered by insurance as required by the law, no responsibility being imputable to the organisers.



All reconnaissance operations, for all crews, may only be carried out using cars complying with the specifications defined in FIA WRC, art. 35.1.

In Finland the use of radar detectors is forbidden and if a competitor is found using a detector during the reconnaissance or the competition, he will be refused to start or disqualified.

## 9.3 Installation of Speed Control Checking Devices

As per FIA WRC Art. 35.4.4, the installation of GPS recorders is mandatory.

### FIA Speed Control Checking Devices

All drivers must carry a GPS recorder provided by the FIA nominated supplier. An OBD2 power connection must be made available in the reconnaissance car.

SAS will be charging a rent for this equipment as follows:

P1 & P2 & P3 Drivers	€300
Non-priority	€130

Payment must be made online and well in advance on the SAS website at <https://wrc.statusas.com/> (for collection and return details, see SR, Art. 3).

## 10. Administrative Checks (FIA WRC, Art. 30)

### 10.1 Documents to be Presented

Administrative checks will be done online, before the event and without contact between competitors and organiser representatives. All competitors must send all required documents as per these regulations to organiser.

Competitors are required to return signed entry form when collecting all event materials (reconnaissance and rally) as per schedule, given in Art. 3 Programme.

Documents must be sent to organiser by using the form in following address: [www.arcticrallyfinland.fi](http://www.arcticrallyfinland.fi)

At the virtual Administrative Checks the following documents will be checked:

- valid drivers' competition and driving licences
- valid competitor's licence
- drivers' identification cards/passports
- drivers' medical certificates of aptitude (if separate from competition licence)
- authorisation for the drivers by their ASN to take part in the rally
- rally car's insurance cover towards the third parties (Green Card)
- rally car's registration papers



POWERED BY  
Capital Box



- accuracy and completion of all information given on the entry form
- signatures of entry forms from all drivers



## 11. Scrutineering, Sealing and Marking (FIA WRC, Art. 31)

### 11.1 Scrutineering Venue and Timetable

Venue: Lapin Koulutuskeskus REDU, Marttiintie, Rovaniemi

P1 drivers not entered by a Manufacturer, P2, P3 and non-priority drivers:

Thursday 25 February 2021 at 14.00-22.00

Individual scrutineering times will be given in a bulletin.

**Covid-19 note!** A limited number of competitor representatives will be allowed in the scrutineering venue (one or two per car, plus one for the drivers' equipment – more information in Rally Guide). Face masks must be worn at all times.



### 11.2 Windows/Nets

Silvered or tinted films are allowed on rear and rear side windows only (Appendix J, Art. 253.11). Anti-shatter film must be used according to the same article. Window nets are not allowed.



### 11.3 Drivers' Safety Equipment (FIA WRC, Art. 31.1.2)

At scrutineering competitors must produce all items of clothing including helmets and head restraints intended to be used. Condition of the equipment and compliance with Appendix L, Chapter III will be checked. Also, see Appendix 6 of SR for safety information.

Co-drivers' shoes do not have to comply to FIA Standard 8856-2000 or 8856-2018, but equipment more suitable for the arctic conditions may be used. However, the outer layer of shoes must be made of a non-flammable material, such as leather, felt or equivalent.

**Covid-19 note!** The competitor representative in charge of each crew's equipment will place them on a table reserved for this purpose. After this, the scrutineer will come to the other side of the table (thus creating a natural distance of 1.5 - 2 metres to the competitor representative). The competitor representative will present each piece of equipment, the scrutineer will not be touching the equipment. When the inspection has been done, the competitor representative will pack up the equipment and leave. The table in question will then be disinfected and the scrutineer will clean his/her hands with hand sanitiser.

### 11.4 Noise level

There will be a mandatory noise check at the scrutineering (maximum 103 dB at 3500 rpm). Any vehicle over this limit will not pass scrutineering.



## 11.5 Special National Requirements

Each competing car must be equipped with a first aid kit and 1 reflecting triangle, under pain of refusal to start. Each car must also carry two snow shovels and warm clothes, hats, mittens and shoes for driver and co-driver (for more information, see Rally Guide).

Competitors are also reminded that in addition, two belt cutters must be carried on board at all times. They must be easily accessible to driver and co-driver when seated with their harnesses fastened (the Code, Appendix J, Art. 253, 6.1).

Contrary to the prescriptions of FIA WRC, Art. 55.1.2, all retired cars driven by a non-priority driver must be brought to the re-start parc fermé in the Service Park of the rally (as shown on the Rally Guide Service Park lay-out) before taken to service, unless given permission by the Clerk of the Course to act otherwise.

Each competing car must carry an oil spill kit capable of absorbing the total amount of oil-based fluids contained in the car's systems. The kit should include oil absorbent material, plastic bags and gloves as a minimum. Please contact organiser for more information.

All competitors must have a minimum 6 kg fire-extinguisher per each competing car available at their service area at all times.

## 11.7 Installation of Safety Tracking System (FIA WRC Art. 18.2 and 53.2.1)

All competitors must make provision in their rally cars for the installation of the FIA Safety Emergency Console. Installation and operation instructions can be found as Appendix 5.

The functioning of the equipment will be checked at the scrutineering. Should a crew retire, the equipment must be returned immediately to SAS (exact location given in Rally Guide). Should there be any damage to the equipment, SAS will invoice the competitor after the rally.

## 11.8 Sealing (FIA WRC, Art. 16-17)

Sealing of the cars will be carried out according to FIA WRC Art. 16-17. It is reminded that sealing of the transmissions (including spare parts) with wire and tag applies to all cars (16.3.2), including non-priority drivers' cars. Therefore, all underbody protection must be removed for scrutineering, but must be kept with the car for weight checks.

Car's chassis and cylinder block will also be marked (FIA WRC, Art. 31.1.6). Sealing wires must be installed according to the instructions given at a later date.

## 11.9 Homologation forms (FIA WRC, Art. 31.1.4)

All cars must have a complete certified homologation form (the Code, Appendix J, Art.



POWERED BY  
Capital Box



251.2.1.8) available at scrutineering. In addition, homologation forms for the catalytic converter and rollage (if homologated), and any certificate for the safety fuel cell must be with the car at scrutineering.



**RALLY  
FINLAND**

POWERED BY  
Capital Box



**WRC**  
CHAMPIONSHIP

## 11.10 On-board Cameras (FIA WRC, Art. 18.1)

The competitor of any car which carries an on-board camera must have the prior agreement of the Promoter. Authorised cameras will be identified by an adhesive decal and must be mounted in the car at the time of scrutineering.

The fixings of camera and camera recorder must be able to withstand a deceleration of 25 g.

Competitors wishing to use a camera must supply the following information to the Promoter ([accreditation@wrc.com](mailto:accreditation@wrc.com)) at least one week before the start of reconnaissance: competitor's name, car number, competitor's address and use of footage.

## 12. Other Procedures

### 12.1 Drivers' Safety Briefing

Drivers' Safety Briefing at 18.00 on Thursday 25 February 2021 held as Video Conference is mandatory for all invited drivers and co-drivers. The list of names will be published later in a bulletin.

**NB!** On stages run in darkness, the red flag in SOS radio points is replaced by a red light.

### 12.2 Shakedown (FIA WRC, Art. 36)

All P1 and other requested drivers will be required to complete their first passage (FIA WRC, Art. 36.2.2) of Shakedown in order of Championship classification, and at an interval defined by the Clerk of the Course in consultation with FIA and WRC Promoter.

A start list for this first passage will be published at 19.00 on Thursday, 25 February 2021.

At the conclusion of these fixed passages, P1 and other requested drivers will be able to continue their shakedown runs.

There will be a technical zone included in the 5 minutes between the TC and the start of the shakedown.

Notwithstanding WRC Art. 36.4, no passengers other than the co-driver of the entered crew are allowed inside the rally car during Shakedown.

### 12.3 Start Order and Intervals (FIA WRC, Art. 41)

For any Live TV stages starting intervals other than those given in the Start List for the

Section in question may be used (FIA WRC, Art. 41.3.3). Should the Live TV stage not be followed by a regroup, these starting intervals may remain for other special stages until the next regroup or overnight halt.



Live TV stages are as follows:

- SS1 Sarriojärvi 1
- SS2 Sarriojärvi 2
- SS4 Kaihuavaara 1
- SS7 Kaihuavaara 2
- SS9 Aittajärvi 1
- SS10 Aittajärvi 2 (Wolf Power Stage)

## 12.4 Start of the Rally

The cars will start from TC 0 on Friday 26 February 2021 from 13.30 according to the starting list published at 10.00 on the same day.

The crews are requested to be in the start area max. 10 minutes before each car's individual starting time.

## 12.5 Permitted Early Check-In at Time Controls (FIA WRC, Art. 44.2.11)

The crews may report before their due time at the following Time Controls without incurring a penalty:

- 2C Service OUT
- 2D Finish Day 1/Parc Fermé
- 8C Service OUT
- 8D Finish Day 2/Parc Fermé
- 10A Holding Area OUT
- 10B Finish - Technical Zone/Parc Fermé IN

## 12.6 Official Time used during the Rally

Official time during the rally will be that of the GPS (UTC plus offset to local time).

## 12.7 Control Procedures and Time Card Handling

### GENERAL

- a. The following procedures apply and have priority over all the related provisions in the 2021 FIA WRC Sporting Regulations as far as they are in conflict. Some of the conflicting article numbers are quoted below, but without claiming to be exhaustive.
- b. Any irregularity or discrepancies regarding the below procedures will result in the application of 2021 WRC Sporting Regulations, Art. 19.3.4 and 44.2.12. It is to be noted that, as a principle, the entries recorded on the timing marshals' check- sheets shall be decisive.

- c. The complete set of Time Cards for the whole rally (including the Shakedown time cards for all drivers affected under 2021 WRC Sporting Regulations, Art. 36.2.2) will be delivered with the rally materials at administrative checks. It is imperative for all crews to carry at least all the Time Card sets for a whole day inside the car (cf. for example procedures at regrouping controls).

### **PASSAGE CONTROLS** (2021 WRC Sporting Regulations, Art. 43)

At these controls, the marshal will simply mark the car number on his check sheet as soon as the car stops at the control, without mentioning the time of passage, and show the check sheet to the co-driver.

### **TIME CONTROLS**

- a. The check-in procedure begins at the moment as stipulated in Art. 44.2.1 of the 2021 WRC Sporting Regulations.
- b. The check-in time corresponds to the moment at which the co-driver shows their Time card to the timekeeper through the side window (2021 WRC Sporting Regulations, Art. 44.1 and Art. 44.2.4).
- c. The appropriate timekeeper will then enter the actual time at which the card was shown on the timing tablet and write it on the check sheet (2021 WRC Sporting Regulations, Art. 44.2.5).
- d. They will then show the recorded check-in time and, in case of a Time Control followed by a special stage, the provisional special stage start time to the co-driver. The co-driver shall then enter this time on their time card (2021 WRC Sporting Regulations, Art. 44.2.5).

### **SPECIAL STAGE START**

- a. At the start line, the co-driver shows the timekeeper the time card through the side window. The timekeeper then either confirms this provisional start time or shows a different start time on his check sheet.
- b. This new time, if any, shall then be recorded as actual start time on the time card by the co-driver (2021 WRC Sporting Regulations, Art. 48.2.3). This actual start time will also be shown on the electronic start count-down display.

### **SPECIAL STAGE STOP POINT**

- a. The timekeeper at the stop point will show the finish time (time of the day: hour, minute, second, tenth of a second and thousands for the Power Stage) and the calculated stage time to the crew (co-driver).
- b. The co-driver shall record this time on their time card.



POWERED BY  
Capital Box



## **REGROUPING CONTROLS** (2021 WRC Sporting Regulations, Art. 46)



- a. There is no need to hand in the Time Card used for the Section concerned.
- b. For regroupings during a day, the crews shall themselves record their re-start time from the regroup as instructed by the timing marshal on their new time card for the following Section of that day.
- c. In case of an overnight regroup, the crew shall themselves record their re-start time of the following day on their time card, following the publication of the start list for the section after the overnight regroup.
- d. Point b. above shall likewise be applied by the drivers concerned for the Shakedown TC/start time.

## **FLEXI-SERVICE**



- a. Flexi-Service P1 drivers: The rally official in attendance at the allocated bay will keep a check sheet and record the start of the permitted service time. The rally official at the exit of the Service Park will keep a check sheet and record the time of the car leaving service. The rally official at the entrance to the overnight Parc Fermé will also keep a check sheet to record the time of the car entering the Parc Fermé.
- b. Flexi-Service P2, P3 and non-priority drivers: The rally official in attendance at the control Technical Zone OUT/Service IN will keep a check sheet and record the start of the permitted service time. The rally official at the exit of the Service Park will keep a check sheet and record the time of the car leaving service. The rally official at the entrance to the overnight Parc Fermé will also keep a check sheet to record the time of the car entering the Parc Fermé.

## 12.8 Running of Flexi-Service

### **12.8.1 Running of 30-minute Flexi-Service**

Contrary to the prescriptions of FIA WRC, Art. 57.2.2, the midday service on Saturday will be run as a 30-minute flexi-service for P1 crews.

At TC5A all P1 crews are shown their due time at TC5C (Service OUT), all other crews are shown their due time at TC5B (Regroup and Technical Zone OUT – Service IN). After having completed the checks at the Technical Zone, P1 crews will pass TC5B without stopping and immediately drive their cars into their service bays where the start and the end of the allowed 30' service time will be controlled by rally officials. After servicing, the car shall (again) be isolated by ropes until it is driven to TC5C by the crew. Any service in excess of the single, uninterrupted, 30' will be reported to the Stewards, who will apply time penalties even if the crew checks in at TC5C on their due time.

All other drivers shall leave their car in the Regroup/Flexi Parc Fermé area to be collected

for service at their due time. At any time, the car may only be driven by the crew entered. Time entry shown at TC 5B will mark the start of service.

### 12.8.2 Running of 45-minute Flexi-Service (FIA WRC, Art. 59)

The flexi-service parc fermé at the end of Sections 2 and 4 will include a 10-minute Technical Zone. The procedures described in FIA WRC, Art. 59 and above in Art. 12.7 apply for all drivers.

### 12.9 Promotional Activities with Drivers (FIA WRC, Art. 38)

On Tuesday 23rd February all drivers entered to collect Manufacturer points, all Priority 2 drivers and selected other drivers will be invited to an exclusive Lapland experience at the Arctic Circle. The programme includes ice karting, short Siberian Husky safari, meeting with Santa Claus himself and a possibility to hop on his reindeer sleigh to complete your very own reindeer driving license. This adventure will be organised between 10:30 – 14:00 (max 1,5 hrs experience/team). Each team will have their individual schedule and Group distancing will be applied. A detailed timetable will be shared closer to the event.

### 12.10 Power Stage (FIA WRC, Art. 50)

With reference to FIA WRC, Art. 50, SS 10 Aittajärvi 2 will be run as the Power Stage.

If determined by the FIA in conjunction with the WRC promoter, crews will contest SS 10 with different start intervals than the interval given at the start of Section 5 and/or in a different order than the order at TC 9A (FIA WRC, Art. 50.3).

All crews must be at organiser's disposal in the regrouping area between TC 9A and TC 9B, in order to be able to receive information of their starting time from TC 9B, should this information deviate from that available at their time of arrival to TC 9A. The adjustment of tyre pressure is allowed inside the regroup.

For the purpose of Live TV there will be interviews and podium ceremony after the STOP control of the stage (FIA WRC, Art. 50.5). For details of the combined Power Stage and Finish Podium procedures, see SR, Art. 12.12.

### 12.12 Finish procedure (FIA WRC, Art. 66.1 and Appendix IV)

The Power Stage Holding Area starts at the STOP control and ends at TC10A. In this area cars are under parc fermé rules (FIA WRC, Art. 63.1.4). Between the STOP control and TC10A all cars are neutralised and the crews must follow marshals' orders. At TC10A each crew will be given their actual start time for the last road section to the final time control, TC10B.

Maximum time for the Power Stage, from the start to the STOP control, is 30 minutes after which the crew will accrue penalties for lateness as stipulated in FIA WRC Art. 44.2.10. Thus any crew exceeding 60 minutes from Power Stage start to STOP will be considered to





have exceeded their maximum permitted lateness and to have retired as per WRC Art. 45.1.

Contrary to the prescriptions of FIA WRC, Appendix IV, a combined procedure for the Power Stage finish and the rally prize-giving will be followed.

Exhibition driving under FIA WRC, Art. 34.1.3 is not permitted due to lack of suitable space.

The first car to go over the podium will be the winner of the rally, who will drive on to the podium directly from the STOP control, provided the winner is the crew anticipated as such when deciding the start order for the Power Stage. The winners will be joined by the crews in position 2 and 3 for the traditional champagne spray and prize-giving.

This will be followed by a similar ceremony for the Top Three crews of WRC 2 and WRC 3, to be followed by other drivers. When released by officials, Priority 1 drivers not receiving any prize may advance directly to TC 10A and the following road section towards the final parc fermé if they so wish.

More details of the ceremonies will be given in RG.

### 12.13 Final Parc Fermé

Final Parc Fermé is located in the Service Park area. Provided the Stewards have authorised the opening of the final Parc Fermé, cars must be removed by 20.00 hrs on Sunday 28 February 2021.

## 13. Identification of Officials

The post officials and other officials will be identified as follows:

SS Commander	red tabard
SS Safety Officer	green tabard
SS Chief Marshal	dark green tabard
Post Chief	blue tabard
Timekeepers	yellow tabard
Scrutineers	black tabard 'SCRUTINEER'
TC Officials	green tabard 'OFFICIAL'
SS Doctor	white tabard 'DOCTOR'
Competitors' Relations Officer	CRO labelled orange tabard
Section Chief Marshal	orange tabard
Safety Marshal	yellow tabard
Red Flag Marshal	yellow tabard with blue radio symbol

## 14. Prizes

### 14.1 General classification

1. Cup
2. Cup
3. Cup

### 14.2 FIA WRC 2 Championship (for drivers & co-drivers)

1. Cup
2. Cup
3. Cup

### 14.3 FIA WRC 3 Championship (for drivers & co-drivers)

1. Cup
2. Cup
3. Cup

### 14.5 Classification in Classes RC2-RC5, RGT

Prizes will only be dealt out in case the winners are different from those of WRC 2 or WRC 3.

1. Cup
2. Cup (only when 5 or more starters in class)
3. Cup (only when 5 or more starters in class)

### 14.6 Cups

- \* Winning Manufacturer
- \* Winning Team in WRC 2

## 15. Final Checks and Protests

### 15.1 Final Checks (FIA WRC, Art. 33)

The final checks will take place on Sunday, 28 February 2021 at 15.30 at Lapin Koulutuskeskus REDU, Marttiinintie, Rovaniemi.

Notice to attend the final inspection will be given to the competitors chosen by the Stewards. The cars will be taken after TC 10B to the scrutineering by the driver or a team representative duly designated in writing, accompanied by a representative of the organiser. A sufficient number of mechanics, observing any Covid-19 protocols, with tools must follow each chosen car, should the scrutineers wish to dismantle the car.

### 15.2 Protest Deposits

Sum of the protest deposit set in FIA WRC, Art. 65.2: € 1000

If the protest requires the dismantling and the reassembly of a clearly defined part of the car (engine, transmission, steering, braking system, electrical installation, bodywork, etc.),



an additional deposit may be specified by the stewards on a proposal from the FIA technical delegate or the chief scrutineer (the Code, Art. 13.4.3).

The expenses incurred by the work and by the transport of the car shall be borne by the claimant if the protest is unfounded, or by the competitor against whom the protest is lodged if the claim is upheld.

If the protest is unfounded, and if the expenses incurred by the protest (scrutineering, transport, etc.) are higher than the deposit amount, the difference shall be borne by the claimant. Conversely, if the expenses are less, the difference shall be returned to them.

### 15.3 Appeal Deposit Fees

Sum for an international appeal fee (FIA WRC, Art. 65.5): € 6 000



# Appendices

Appendix 1 - Itinerary	37
Appendix 2 - Reconnaissance Timetable	40
Appendix 3 - Identification Numbers and Advertising	41
Appendix 4 - Competitors' Relations Officers	43
Appendix 5 - FIA Safety Emergency Console	44
Appendix 6 - Drivers' Safety Equipment, Appendix L	44
Appendix 7 - Studded Tyres	46

# Appendix 1

## Itinerary of the Rally - Shakedown and Sections 1 & 2

ver. 1.3 - 31012021

Sunrise 7:44

Sunset 17:15

Shakedown				Friday 26.2.2021		
TC	Location	SS	Liaison	Total	Target	First
SS		dist.	dist.	dist.	time	car due
	Santasport, Rovaniemi					
	Shakedown TC		11,85	11,85		8:26
SD	<i>Shakedown Vennivaara</i>	5,69				8:31
	Santasport		12,68	18,37		
<b>Totals</b>		<b>5,69</b>	<b>24,53</b>	<b>30,22</b>		

Shakedown

Start ( Sections 1 & 2 )				Friday 26.2.2021		
TC	Location	SS	Liaison	Total	Target	First
SS		dist.	dist.	dist.	time	car due
0	<b>Start ( Santasport, Rovaniemi )</b>					13:30
RZ	Refuel Santasport		[0.03]			
1	Distance to next refuel	(31.05)	(109.36)	(140.41)		
1			77,79	77,79	01:32	15:02
SS 1	<i>Sarriojärvi 1 (Live TV)</i>	31,05			00:06	15:08
1a	Regroup & Technical Zone IN		31,57	62,62	01:20	16:28
	Regroup Salorantie 1, Kemijärvi				01:40	
1b	Regroup OUT					18:08
RZ	Refuel Salorantie 1, Kemijärvi		[0.02]			
2	Distance to next refuel	(31.05)	(80.38)	(111.43)		
2			10,23	10,23	00:24	18:32
SS 2	<i>Sarriojärvi 2 (Live TV)</i>	31,05			00:06	18:38
2a	Parc Fermé & Technical Zone IN		64,62	95,67	01:30	20:08
2b	Parc Fermé & Technical Zone Santasport				00:10	20:18
SPA	<b>Flexi Service A Santasport</b>	<b>62,10</b>	<b>184,21</b>	<b>246,31</b>	<b>00:45</b>	
2c	Service OUT					21:03
2d	Finish DAY 1 /Parc Fermé 1 Sampokeskus		2,83	2,83	00:30	21:33
	All cars must be in Parc Fermé no later than					24:00
<b>Friday totals</b>		<b>62,10</b>	<b>187,04</b>	<b>249,14</b>		

Section 1

Section 2

# Appendix 1

## Itinerary of the Rally - Sections 3 & 4

ver. 1.3 - 31012021

Sunrise 7:40

Sunset 17:19

Start ( Sections 3 & 4 )					Saturday 27.2.2021	
TC	Location	SS dist.	Liaison dist.	Total dist.	Target time	First car due
2e	Parc Fermé OUT					07:30
2f	Service IN		2,70	2,70	00:20	07:50
<b>SPB Service B Santasport</b>		<b>5,53</b>	<b>5,53</b>	<b>5,53</b>	<b>00:15</b>	
2g	Service OUT					08:05
RZ	Refuel Santasport		[0.03]			
3	Distance to next refuel	(44.34)	(77.01)	(121.35)		
3			37,03	37,03	01:00	09:05
SS 3	<b>Mustalampi 1</b>	<b>24,43</b>			00:03	09:08
4			28,96	53,39	01:24	10:32
SS 4	<b>Kaihuavaara 1 (Live TV)</b>	<b>19,91</b>			00:06	10:38
RZ	Refuel Vanttauskoski		[10.23]			
4	Distance to next refuel	(27.68)	(77.25)	(104.93)		
5			50,79	70,70	01:27	12:05
SS 5	<b>Siikakämä 1</b>	<b>27,68</b>			00:03	12:08
5a	Regroup & Technical Zone IN		37,57	65,25	01:12	13:20
5b	Regroup & Technical Zone OUT - Service IN				00:45	14:05
<b>SPC Flexi Service C Santasport</b>		<b>72,02</b>	<b>154,35</b>	<b>226,37</b>	<b>00:30</b>	
5c	Service OUT					14:35
RZ	Refuel Santasport		[0.03]			
5	Distance to next refuel	(44.34)	(77.01)	(121.35)		
6			37,03	37,03	01:00	15:35
SS 6	<b>Mustalampi 2</b>	<b>24,43</b>			00:03	15:38
7			28,96	53,39	01:24	17:02
SS 7	<b>Kaihuavaara 2 (Live TV)</b>	<b>19,91</b>			00:06	17:08
RZ	Refuel Vanttauskoski		[10.23]			
6	Distance to next refuel	(27.68)	(77.25)	(104.93)		
8			50,79	70,70	01:27	18:35
SS 8	<b>Siikakämä 2</b>	<b>27,68</b>			00:03	18:38
8a	Parc Fermé & Technical Zone IN		37,57	65,25	01:20	19:58
8b	Parc Fermé & Technical Zone Santasport				00:10	20:08
<b>SPD Flexi Service D Santasport</b>		<b>72,02</b>	<b>154,35</b>	<b>226,37</b>	<b>00:45</b>	
8c	Service Out					20:53
8d	Finish DAY 2 /Parc Fermé 2 Sampokeskus		2,83	2,83	00:30	21:23
All cars must be in Parc Ferme no later than						24:00
<b>Saturday totals</b>		<b>144,04</b>	<b>311,53</b>	<b>455,57</b>		



ARCTIC  
RALLY  
FINLAND

POWERED BY  
Capital Box



Section 3

Section 4

# Appendix 1

## Itinerary of the Rally - Sections 5 & 6

ver. 1.3 - 31012021

Sunrise 7:36

Sunset 17:22

Start (Sections 5 & 6)					Sunday 28.2.2021	
TC	Location	SS dist.	Liaison dist.	Total dist.	Target time	First car due
8e	Parc Fermé OUT					08:45
8f	Service IN		2,70	2,70	00:15	09:00
<b>SPE</b>	<b>Service E Santasport</b>		5,53	5,53	00:15	
8g	Service OUT					09:15
<b>RZ</b>	Refuel Santasport		[0.03]			
7	Distance to next refuel	(44,94)	(83,10)	(128,04)		
9			29,50	29,50	00:47	10:02
<b>SS 9</b>	<b>Aittajärvi 1 (Live TV)</b>	22,47			00:06	10:08
9a	Regroup & Technical Zone IN		21,00	43,47	01:00	11:08
	Regroup Santasport				01:17	
9b	Regroup OUT					12:25
10			29,50	29,50	00:47	13:12
<b>SS 10</b>	<b>Aittajärvi 2 (Wolf Power Stage)</b>	22,47			00:06	13:18
	Podium					
<b>10a</b>	<b>Holding Area OUT</b>					
<b>10b</b>	<b>Finish - Technical Zone/Parc Fermé IN Santasport</b>		(21,00)	(21,00)	00:50	
<b>Sunday totals</b>		<b>44,94</b>	<b>103,70</b>	<b>126,17</b>		

Section 5

Section 6



TOTALS OF THE RALLY				
	SS	Liaison	Total	%
Friday 26 February - 2 SS				
Section 1 & 2	62,10	187,04	249,14	24,93 %
Saturday 27 February - 6 SS				
Sections 3 & 4	144,04	311,53	455,57	31,62 %
Sunday 28 February - 2 SS				
Sections 5 & 6	44,94	103,70	126,17	35,62 %
<b>Total - 10 SS</b>	<b>251,08</b>	<b>602,27</b>	<b>830,88</b>	<b>30,22 %</b>

## Appendix 2

### Reconnaissance timetable



ARCTIC  
RALLY  
FINLAND®

POWERED BY  
Capital Box



#### Reconnaissance Day 1 Wednesday 24 Feb. 2021

Group A	Allowed Time	SS km	Total SS km (x2)	Finish 1 / Start 2	To Next SS	Total km
Service Park, Santasport					37,03 SS 3/6	37,03
SS 3/6 Mustalampi	8:00 - 11:00	24,43	48,86	56,80 SS 3/6	28,96 SS 4/7	134,62
SS 4/7 Kaihuvaara	10:00 - 13:00	19,91	39,82	6,20 SS 4/7	50,79 SS 5/8	96,81
SS 5/8 Siikakämä	11:30 - 15:00	27,68	55,36	24,70 SS 5/8	59,45 SS 9/10	139,51
SS 9/10 Aittajärvi	14:00 - 18:00	22,47	44,94	43,00 SS 9/10	21,00 SP	108,94
Total						516,91

Group B	Allowed Time	SS km	Total SS km (x2)	Finish 1 / Start 2	To Next SS	Total km
Service Park, Santasport					60,70 SS 5/8	60,70
SS 5/8 Siikakämä	8:00 - 11:00	27,68	55,36	24,70 SS 5/8	59,45 SS 9/10	139,51
SS 9/10 Aittajärvi	10:30 - 14:00	22,47	44,94	43,00 SS 9/10	54,50 SS 3/6	142,44
SS 3/6 Mustalampi	13:00 - 17:00	24,43	48,86	56,80 SS 3/6	28,96 SS 4/7	134,62
SS 4/7 Kaihuvaara	15:00 - 19:00	19,91	39,82	6,20 SS 4/7	63,20 SP	109,22
Total						586,49

#### Reconnaissance Day 2 Thursday 25 Feb. 2021

Group A	Allowed Time	SS km	Total SS km (x2)	Finish 1 / Start 2	To Next SS	Total km
Service Park, Santasport					77,79 SS 1/2	77,79
SS 1/2 Sarriöjärvi	8:00 - 11:00	31,05	62,10	22,50 SS 1/2	71,00 SD	155,60
SD Vennivaara	10:30 - 14:00	5,69	11,38	19,50 SD	12,68 SP	43,56
Total						276,95

Group B	Allowed Time	SS km	Total SS km (x2)	Finish 1 / Start 2	To Next SS	Total km
Service Park, Santasport					11,85 SD	11,85
SD Vennivaara	8:00 - 10:30	5,69	11,38	19,50 SD	108,50 SS 1/2	139,38
SS 1/2 Sarriöjärvi	10:30 - 14:00	31,05	62,10	22,50 SS 1/2	64,62 SP	149,22
Total						300,45

ver. 31012021



## Appendix 3 (FIA WRC, Art. 27-29)

### Identification Numbers and Advertising

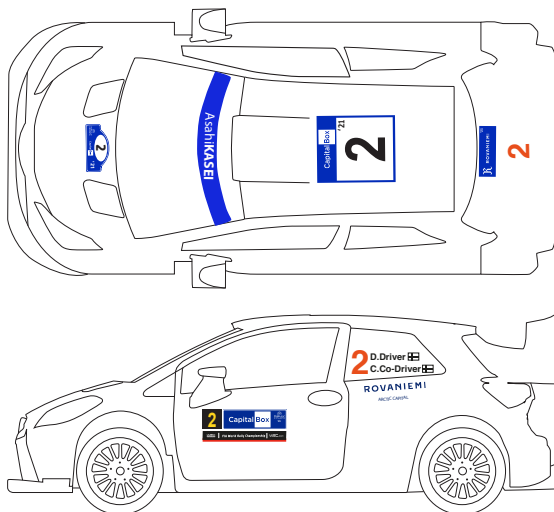

#### Obligatory:

1. Competition number, 1 / car 50 x 52 cm (CapitalBOX)  
- one rectangular panel placed on the roof with the top towards to front of the car
2. Competition number, 2 / car 67 x 17 cm (CapitalBOX)  
- two rectangular panels placed on both front doors of the car (7 to 10 cm of the bottom line of the side window) with the number to the front of the car
3. Competition number, 2 / car 20 cm high  
- two competition numbers for both rear side windows
4. Rally Plate, 1 / car 43 x 21.5 cm (CapitalBOX)  
- one plate placed on the bonnet of the car
5. Competition number, 1 / car 15 x 15 cm  
- one competition number for the rear window, to be placed at the bottom in the centre of the rear window, above the rear window panel
6. Rear window panel, 1 / car 30 x 10 cm (Rovaniemi)  
- one rectangular panel for the rear window, to be placed up at the bottom in the centre of the rear window (below the competition number)
7. Organiser's optional advertisement, 2/car 40 x 15 cm (Rovaniemi Arctic Capital)  
- rectangular panel below the rear side window on both sides of the competing car

8. Driver and Co-driver name stickers, 2 / car
- in white Helvetica font
  - initial(s) and first letter of each name must be in upper case, the remainder in lower case
- 6 cm high, stroke width 1 cm
- the driver's name must be the upper one on both sides of the car
  - names followed by national flags of passport country
9. Championship Windscreen Identification
- 15 cm high windscreen sticker from WRC Promoter (FIA WRC, Art. 29.5.1)
10. Championship door plates 67 x 6 cm
- two rectangular panels on both front doors, immediately under the competition number, with Championship identification from WRC Promoter as per FIA WRC, Art. 29.5.1
11. Dashboard space 20 x 10 cm
- within view of the on-board camera of the Championship Promoter (FIA WRC, Art. 29.5.1)



RALLY  
FINLAND

POWERED BY

Capital Box



WRC  
CHAMPIONSHIP

## Appendix 4

### Competitors' Relations Officers



Ms. Katriina Keskiniva  
Tel. +358 50 408 6680



Ms. Jonna Hautala  
Tel. +358 440 490 681



## Competitors' Relations Officers Schedule

Thursday 25 February - Sunday 28 February

During this period, Competitors' Relations Officers can be reached via phone, SMS, WhatsApp and e-mail. E-mail addresses will be published at Rally Guide.

## Appendix 5

### FIA Safety Emergency Console

Please find the FIA Safety Emergency Console installation and operation instructions at [www.arcticrallyfinland.fi](http://www.arcticrallyfinland.fi)

Note: These instructions must be considered as integral parts of these Supplementary Regulations.

## Appendix 6

### Drivers' Safety Equipment - FIA ISC, Appendix L

All competitors are reminded of Appendix L of the FIA International Sporting Code, in particular its Chapter III - Drivers' Equipment. These regulations apply to Shakedown as well.

#### Helmets (Appendix L, Chapter III, Art. 1)

Priority 1 drivers and their co-drivers must wear helmets according to the FIA standard 8860-2018 or 8860-2018-ABP. All other crews must wear crash helmets homologated to one of the following FIA standards:

- |                              |                          |
|------------------------------|--------------------------|
| - 8858-2002 or 8858-2010     | (Technical List N°41),   |
| - 8859-2015                  | (Technical List N°49),   |
| - 8860-2004 or 8860-2010     | (Technical List N°33) or |
| - 8860-2018 or 8860-2018-ABP | (Technical List N°69)    |

Drivers and co-drivers who wear full-face helmets must contact the FIA Medical Delegate or the Chief Medical Officer in order to carry out a test before the start of the event. This test is described in Appendix L, Chapter III, Art. 1.3.

#### Frontal Head Restraint (Appendix L, Chapter III, Art. 3)

All crews must use FIA approved FHR systems homologated to FIA standard 8858. Approved FHRs, anchorages and tethers are listed in Technical List N° 29. See also helmet compatibility chart in Appendix L, Chapter III, Art. 3.3.

#### Flame-resistant clothing (Appendix L, Chapter III, Art. 2)

All drivers and co-drivers must wear overalls as well as gloves (optional for co-drivers), long underwear, a balaclava, socks and shoes homologated to the FIA 8856-2000 standard (Technical List N°27) or 8856-2018 (Technical List N° 74). Also, see Art. 11.3 of these Supplementary Regulations.

For Priority 1 drivers and their co-drivers, the wearing of equipment homologated to the FIA 8856-2018 standard is obligatory.



RALLY  
FINLAND

POWERED BY  
Capital Box



Please pay special attention to the prescriptions of Art. 2 concerning embroidery and printing on flame-resistant clothing (manufacturer certificates etc.) as well as concerning the correct wearing of the clothing elements! See also the 2021 FIA WRC Sporting Regulations, Article 53.1.

### **Biometric Devices (Appendix L, Chapter III, Art. 2.1)**

Drivers may wear a device to collect biometric data during racing.

- If the biometric device is integrated into a protective garment homologated to FIA Standard 8856, the garment shall be homologated to FIA Standards 8856 and 8868-2018.
- If the biometric device is a stand-alone device, then the device must be homologated to FIA Standard 8868-2018 only. This device must be worn in addition to the garment homologated to FIA Standard 8856.

### **Wearing of jewellery (Appendix L, Chapter III, Art. 5)**

The wearing of jewellery in the form of body piercing or metal neck chains is prohibited during the competition and may therefore be checked before the start.

#### **LINKS:**

FIA International Sporting Code and appendices:

<https://www.fia.com/regulation/category/123>

FIA Technical Lists:

<https://www.fia.com/regulation/category/761>



POWERED BY  
Capital Box



## Appendix 7

### Studded Tyres

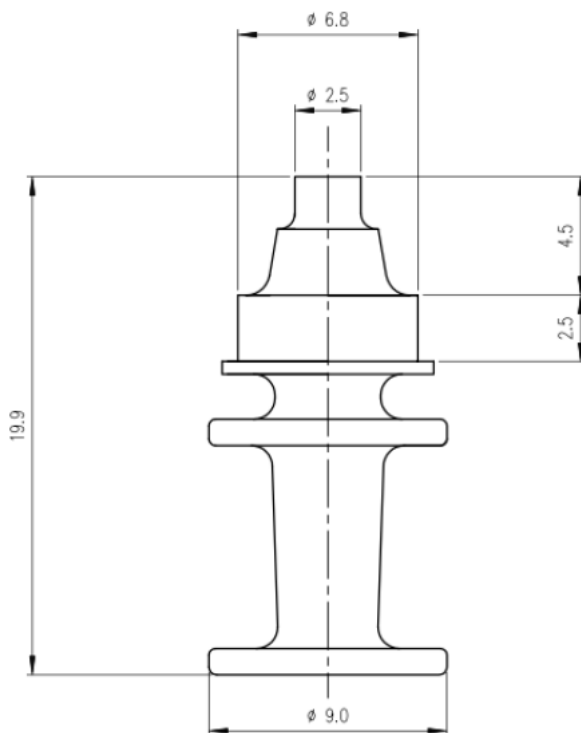

ARCTIC  
RALLY  
FINLAND

POWERED BY

Capital Box



WRC  
CHAMPIONSHIP



Capital Box



R ROVANIEMI

