

RALLY GUIDE



BAUHAUS ROYAL RALLY OF SCANDINAVIA

BAUHAUS

MAY 22-24 2026

BAUHAUS ROYAL RALLY OF SCANDINAVIA

ERCROYALRALLY.COM

MAJOR PARTNER



OFFICIAL CAR



HOSTING CITY





22 – 24 May 2026

RALLY GUIDE

FIA European Rally Championship for Drivers and Co-Drivers

FIA European Rally Championship for Teams

FIA European Rally Championship for Tyre Suppliers

FIA ERC3 Championship for Drivers and Co-Drivers

FIA ERC4 Championship for Drivers and Co-Drivers

FIA Junior ERC Championship for Drivers

FIA Master ERC Championship for Drivers

ERC Fiesta Rally3 Trophy

1. WELCOME AND INTRODUCTION

Welcome to the fourth edition of BAUHAUS Royal Rally of Scandinavia. The rally will take place 22-24 May in the region of Värmland and in the city of Karlstad. We continue to bring the rally into the heart of Karlstad and have a start ceremony at the mail square, like in the old Rally Sweden days.

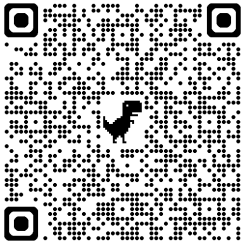

Following by and a spectacular opening stage, SS1 Bråtebäcken, a new stage close to Karlstad on Thursday evening.

Locations

The Rally Village will be at Färjestad (near the throttle track) known from SSS Karlstad i Rally Sweden for many years. Here you will find the Headquarter, Media centre, Service park and start/finish podium.

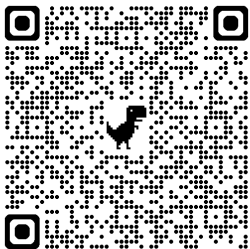

Route

The total length of the route is 982,89 km and the special stage length is 185,94 km. A complete itinerary is enclosed in Appendix 1. The competing part starts with the qualifying stage, Träfors on Thursday at 14:01. And special stage 1 Bråtebäcken will be running after the start ceremony at 18:33. Friday morning the rally will go west and north of Karlstad and Saturday morning the rally is going east of Karlstad. Both days with a loop of two stages two times before coming back to Karlstad for a midday service, before two new stages two times in loop at the afternoon. On Friday the classic stage Vargåsen (now called Colin's) with the famous Colin's Crest will go at 15:10 and then at 17:13 in the afternoon. On Saturday Stage 14 Ölme will go as Live TV stages at 14:05 and as Stage 16 Power stage at 17:05.

This document has no regulatory power – for information only !!

TABLE OF CONTENTS

1. Introduction/ Welcome	2
2. Contact details	4-5
3. Programme	5-6
4. Entry details	7
5. Service park	7-10
6 Two-way radio	10
7. Fuel / Tyres	10-12
9. Helicopters	12
10. Hospitality arrangements	13
11. Hotel / Accommodation reservation	13
12. Reconnaissance	13
13. Scrutineering, sealing and marking	13
14. Shakedown / Free Practice and Qualifying	13-14
15. Start procedure	14
16. Finish Procedure	14
17. PR activities	14
18. Media	14-15
17. Medical and Safety Service	15
18. List of useful facts and services	16-17

Appendixes

Appendix A - Itineraries	
Appendix A - Compare to previous year	
Appendix B - Recce applications for Entrants	
Appendix B - Recce applications for non- Entrants	
Appendix B - Recce schedule	
Appendix B - Recce and Stage Map	
Appendix C - Service Park facilities order form	
Appendix C - Service Park Layout	
Appendix C - Trailer Parking	
Appendix C - Media Parking	
Appendix C - Starting area Layout	
Appendix C - Finishing area Layout	
Appendix C - Scrutineering Layout	
Appendix D - City Map	
Appendix E - Rally HQ Layout	
Appendix F - Hospitality	
Appendix G - Additional Material order form	
Appendix H - FIA WRC Tracking System- Installation and operating Instructions	
Appendix I - Road Book and overview map	

2. CONTACT DETAILS

2.1 ADDRESS AND TELEPHONE PERMANENT CONTACT DETAILS

Postal and visitors' addresses:

Royal Rally Scandinavia AB

Nasta Gård

SE-702 27 Örebro

Telephone: +46 (0) 54 200 200

E-mail: info@ercroyalrally.com and competitor@ercroyalrally.com (all matters for competitors)

Web: ercroyalrally.com

Rally HQ contact details

Visiting address:

Färjestads travbana, Norra Infarten 79, SE-651 08 Karlstad, Sweden

The Rally Office at Rally HQ in Karlstad will be open from Wednesday 20 May to Sunday 24 May. All official documents will be published on the [Official Notice Board \(ONB\)](#).

2.2 OFFICIAL NOTICE BOARD

All official documents will be published on the [Official Notice Board \(ONB\)](#) on our website,

www.ercroyalrally.com. and will also be accessible in the Sportity app (downloadable for iOS devices on Appstore and for Android devices on Google Play). On phones and tablets.

Password is **ERCRR26**.

Push notifications will show if any new document is posted.

2.3 MEDIA CONTACT DETAILS

FIA ERC Press Officer [Richard Rodgers](#) +44 7503 871 575

National Press Officer [Sebastian Bourghardt](#) +46(0)76-357 12 28
media@ercroyalrally.com

2.4 OFFICIALS OF THE EVENT

CEO	Anna Nordqvist	+46 (0)72 06 070 60
Clerk of the Course	Stig Rune Kjernsli	+47 906 34 632
Deputy Clerk of the Course	Erik Åström	+46 (0)70-388 80 70
Assistant Clerk of the Course	Göran Andersson	+46 (0)70-538 09 04
Secretary of the Rally	Anna Öbrand	+46 (0)70-339 26 40
Chief Safety Officer	Mattias Berg	+46 (0)70-208 94 18
Chief Spectator/ National Press Officer	Sebastian Bourghardt	+46 (0)76-357 12 28
Service Park Manager	Mikael Johansson	+46 (0)70-372 95 11
Ass. Service Park Manager	Andreas Magnusson	+46 (0)73-983 36 95
Route Manager	Kristers Berglund	+46 (0)70-511 43 76
Chief Scrutineer	Jakob Ekström	+46 (0)73-635 21 02
Assistant Chief Scrutineer	Peter Björklund	+46 (0) 73-083 80 99
Results officer	Kicki Axelson	
Competitors' Relations Officer	Anders Guldbarndsson	+46 (0)70-646 07 62
Environmental Coordinator	Sverker Carlsten	+46 (0)70-342 99 19

3. PROGRAMME

3.1 SCHEDULE BEFORE THE RALLY WEEK

Friday 1 May		
	Closing date for international media accreditations	ercroyalrally.com
Thursday 7 May		
	Closing date for entries	See Art. 4
	Closing date for co-driver details	competitor@ercroyalrally.com
	Final date to email the required documentation to the organiser	See Art. 4.2
	Closing date for order of Service Park facilities	ercroyalrally.com
	Closing date for order of extra material and documents	ercroyalrally.com
	Media Safety Book published	ercroyalrally.com
Monday 11 May		
	Publication of Road Book, route map, recce videos and kmz-file,	ercroyalrally.com
Wednesday 13 May		
	Publication of the entry list	Digital Notice Board (DNB)
	Closing date for reconnaissance only	competitor@ercroyalrally.com
Sunday 17 May		
	Deadline for all drivers and co-drivers to have completed the FIA e-learning course on the FIA Safety Tracking system (mandatory for all drivers and co-drivers participating in ERC 2026).	FIA e-learning

3.2 SCHEDULE DURING THE RALLY WEEK

Wednesday 20 May		
12:00	Service Park open for all competitors	Service Park
12:00-21:00	Rally HQ and Rally Office open	Rally HQ
18:00	Administrative checks and collection of materials.	Rally HQ
Thursday 21 May		
07:00-16:30	Reconnaissance of special stages	Recce schedule, App. 2
14:00	Media accreditation open	Media Centre, HQ
12:00-15:00	Collection of FIA Safety Emergency System	SAS tent, Service Park
14:00-	Scrutineering incl. sealing and marking	Nobelgymnasiet
18:00	PR activities will be taking place for selected drivers	BAUHAUS, Karlstad
17:00-20:00	Mandatory Promoter Portrait photos for all ERC registered competitors contesting their first ERC event in 2026	Rally HQ
19:30	Junior ERC Family Photo	Service Park
20:00	Compulsory Drivers' Briefing (RRSR 34.1.2)	Rally HQ
Friday 22 May 2026		
07:00-10:30	Reconnaissance of special stages	Recce schedule, App. 2
08:00-09:30	Re-scrutineering	Service Park
08:00-08:30	Pre-event Media Safety Briefing (mandatory for tabard media)	Media Centre
10:00	Publication of Start List for Qualifying Stage	DNB
11:00-13:00	Free Practice for FIA and ERC1 priority drivers	Träfors

14:01	Qualifying Stage for FIA and ERC1 priority drivers	Träfors
~14:45	Qualifying Stage winner presentation, photocall and interview	Träfors, stopline area
15:10-16:00	Shakedown for all drivers	Träfors
16:00	Publication of the QS Provisional classification	DNB
16:30	Publication of Start List for Section 1	DNB
16:30	Publication of Start List for Section 2	DNB
17:30	FIA ERC Meet the Crews (invited drivers only)	Karlstad City square
17:30	Opening ceremony	Karlstad City square
18:00	Start of the Rally	TC 0
18:48	Finish of Leg 1 (Section 1) – TC 1 A	Parc Fermè IN
Saturday 23 May 2026		
06:45	Start of Section 2	TC 1B
~19:00	Meet the Crews	Service Park
19:53	Finish of Leg 1 (Section 3) – TC 8C	Parc Fermè IN
23:00	Publication of Start List for Section 4	DNB
Sunday 24 May 2026		
06:30	Start of Section 4	TC 8D
17:05	Start of Power Stage	SS 16 Ölme 2
18:15	Finish of the rally	Karlstad City square
19:00	Podium Ceremony and Prize Giving	Karlstad City square
19:15	Final Scrutineering	Nobelgymnasiet
19:15	FIA ERC Meet the Crews	Karlstad City square
21:00	Publication of the Provisional Classification	DNB
Before 22:00	Return of the FIA Safety Emergency Console	SAS, Rally HQ
21:30	All cars must be removed from the final Parc Fermé (provided that the Stewards have authorised the opening of the Parc Fermé)	Karlstad City square

4. ENTRY DETAILS

4.1 TITLES FOR WHICH THE RALLY COUNTS

- FIA European Rally Championship for Drivers and Co-Drivers
- FIA European Rally Championship for Teams
- FIA European Rally Championship for Tyre Suppliers
- FIA ERC3 Championship for Drivers and Co-Drivers
- FIA ERC4 Championship for Drivers and Co-Drivers
- FIA Junior ERC Championship for Drivers
- FIA Master ERC Championship for Drivers
- ERC Fiesta Rally3 Trophy

5. SERVICE PARK

5.1 Location and Service Park

GPS Coordinates: N59°24 439, E13°30 314

The service park will be established at Löfbergs Arena/Färjestads Travets Södra parkering, Norra Infarten 79, 651 08 Karlstad Karlstad (see city map in Appendix D)

A provisional drawing of the service park is enclosed in Appendix C (Maps and drawings). ERC Priority entrants will be allocated a designated space in accordance with 2025 FIA Regional Rally Sporting Regulations. Non priority legal and private entrants are allocated an area of 10 m x 10 m.

Extra Space

Cost for additional service space in Service Park area: 350 SEK + 25 % VAT /m².

Requests for extra space are sent to: andreas@ercroyalrally.com

All additional space requests are subject to availability and organiser agreement. The organiser cannot guarantee any service space exceeding those given above and in the 2025 FIA Regional Rally Sporting Regulations, Requests received after 8 May will only be considered for a doubled price, if at all.

A provisional drawing of the service park is enclosed in Appendix C (Maps and Drawings)

Team Area Layout

A layout of each competitors/teams service area must be sent to andreas@ercroyalrally.com by 7 May.

Multiple Competitors

If a competitor has multiple competition cars to be located together in Service Park, the application for consecutive Service Areas must be sent to andreas@ercroyalrally.com by Thursday 7 May. Applications after 7 May cannot be guaranteed.

A provisional drawing of the service park is enclosed in Appendix C (Maps and Drawings)

5.2 Restrictions at the Service Park

Teams and competitors are asked to bring weights for tents and others that need to be fastened.

Mandatory for all competitors to use ground sheets for ground protection under competing car during the service. This ground sheet must be sufficiently strong, i.e., impermeable to oil, fuel, cooling, brake fluid and battery acid. Teams and competitors are responsible for the occurrence of no leakage of fuel or other liquids on the ground. Smoking is forbidden in the refuelling-zones.

5.3 Service Vehicles

Service cars are only allowed to set-up at times according to Art. 5.11. Only vehicles with service plates (issued by the organizer) are allowed to enter the Service Park. The sticker plate must be affixed inside the vehicle, on the upper side of the windshield.

To enter the Service Park during the rally all vehicles must carry a service plate and use the access road according to map of the Service Park (enclosed in Appendix 2 Maps and drawings). The vehicles must be parked fully inside the designated area. If the vehicles do not fit in the competitors designated area, they must be parked at the Auxiliary parking. Please respect service times to avoid congestion.

The number of service plates allowed is included in the entry fee (see 3.5. Entry Packages)

Recce cars

Recce cars can enter the service park until Thursday 21 May. From this date, all recce cars are considered as a service/auxiliary vehicle. If recce cars do not fit within the competitors designated area, they must be parked at the Auxiliary parking.

5.4 Auxiliary Vehicles

The auxiliary parking, is at the Service Park.

For access to the Auxiliary parking area the vehicles must carry an Auxiliary plate or Service plate. The sticker plate must be affixed inside the vehicle, on the upper side of the windshield.

5.5 Trolley Parking

There is parking for transport-trolleys or small vans at Kalvholmen Motor Stadium (see appendix C)

5.6 Medical Unit

A medical unit will be established at the service park, see service park drawing in appendix C

Opening hours:

Friday 22 May	06:00-20:00
Saturday 23 May	06:00-20:00
Sunday 24 May	06:00-20:00

5.7 Water Supply

Fresh water will be available from a big water tank, see service park drawing.

There is no running water at the service park, so teams and competitors are asked to bring barrels to collect freshwater from the big water tank.

5.8 Security

The organiser has arranged marshals for the over-view control at the service park during the nights.

From Tuesday 19 May until Sunday 24 May.

5.9 Internet access

You can order WIFI at the service park. Order by using the order form in appendix C

Closing date for order is 7 May

5.10 Electricity

You can order power at the service park. Order by using the order form in appendix C

Team and competitor are asked to bring cable up to 50m to connect to the electrical cabinets.

Closing date for order is 7 May

5.11 ACCESS TIMES FOR SET-UP

Contact Service Park Manager Mikael Johansson +46 (0)70-372 95 11, mikael.johansson@ercroyalrally.com for directions to your allocated service area.

Wednesday 20 May	12:00 - 21:00	For all competitors
Thursday 21 May	09:00 - 20:00	

5.12 OPENING HOURS SERVICE PARK

Thursday 21 May - Sunday 24. May 05:00 - 23:00

Access times for setup according to 5.11

All service buildings, tents, cars, trailers etc must be removed from the Service Park area at the latest at 14:00 on Monday 25 May. Any team/competitor not obeying this time limit will be charged a penalty fee at 10 000 SEK .

5.13 FACILITIES

The following services will be arranged by the Organiser at Service Park (without charge):

- Waste collection
- Public Toilets
- Water supply

The following may be ordered:

- Private Toilets (Including emptying and cleaning)
- Electricity
- WIFI

To be ordered by using the order form in Appendix C. Closing date for order is 7 May. Orders after 7 May cannot be guaranteed and will be considered with a 25% increased cost.

5.14 RECYCLING / ENVIRONMENTAL REQUIREMENTS

For environmental reasons we kindly ask teams and competitors to use the recycling areas arranged at the service park (marked on the Service Park drawings). Garbage containers will also be available for combustible waste. Oil, drums, spare parts etc may not be left on the service park under any circumstances. A special container for Hazardous Waste will be put in the Service area marked Eco-Simplex, in which the teams can place oil, fluids, lamps, electronic waste, absorbents etc. Empty drums and spare parts can also be put in or close to this container.

Any team/competitor who does not use recycling areas-garbage containers and leave waste at the service bay will be charged a penalty fee of 10 000 SEK

5.15 CAR WASH

For environmental reasons, it is strictly forbidden to wash cars or trucks at the service park.

For trucks we recommend the following company for this purpose:

Lecab Lastbilar AB (Scania Dealer)

www.lecablastbilar.se

GPS: N 59 23.324E1328.713

Contact Christian Haglund to order a Washcard

E-mail: christian.haglund@lecab.se

Opening times:

Monday 10 June July 07:00-16:00

Tuesday 11 June July 07:00-16:00

Wednesday 12 June 07:00-16:00

Price: 945 SEK self service (paid on site with card)

6. TWO-WAY RADIO

Permission for the use of radio transmitter in Sweden must be applied for at the Swedish authority in charge:

Post & Telestyrelsen

Phone: +46 (0)8 678 55 00

e-mail: pts@pts.se

web site: www.pts.se

7. FUEL / TYRES

7.1 FUEL

Fuel must be in compliance with Appendix J art. 252.9 (RRSR art 62)

For environmental and safety reasons, all competitors must refuel in the designated refuel areas. Except as detailed in the regulations for the change of fuel tank, RRSR art 58.

7.2 REFUELLING

7.2.1 REFUELLING AREAS

Except as detailed in Art. 58 of FIA RRSR, competitors may refuel only in the designated Refuelling Areas.

7.2.2 REFUELLING PROCEDURE

Solely for the purpose of assisting with the refuelling procedure of their car, two team members of each crew with the team passes may access the Refuelling Area. In order to access the Refuel area, all personnel involved in refuelling operations must wear clothing that provides adequate protection against fire and includes at least: long trousers, long-sleeved top, closed shoes, gloves and a balaclava.

Engines must be switched off throughout the refuelling operation. It is required that the crew remain outside the car during refuelling. At the Refuel area, the competitor is responsible to protect the ground with an Environmental Mat which shall be composed of an absorbent upper part and an impermeable lower part.

7.3 COMMERCIAL FILLING STATIONS

There will not be any options to use commercial filling stations during this rally.

7.4 REFUELLING DURING THE RALLY

Refuel area will be as follows:

Friday 22 May	Service park 09:30 – 17:30
Saturday 23 May	Service park (after TC 1C and 4C) Remote refuel Malsjö after SS 2 and after SS 3 Remote refuel Sunne after SS 6
Sunday 24 May	Service park (after TC 8E and 12C) Remote refuel Molkom after SS 10 Remote refuel Väse after SS 14

7.5 TYRES

All tires must comply with Art. 13 of the RRSR in conjunction with Appendix V of the RRSR.

7.5.1 TYRES FOR ALL ERC1, ERC3 AND ERC4 PRIORITY COMPETITORS

Tyres must be supplied by an FIA-nominated tyre company. A list of nominated tyre manufacturers for the 2026 FIA European Rally Championship is published on <https://www.fia.com/regulation/category/117>

However, competitors are reminded to comply with:

- 2026 FIA Regional Rally Sporting Regulations, Art. 13.1.4; Each tyre must have barcode numbers supplied by the 2026 FIA-approved barcode supplier.
- 2026 FIA European Rally Championship Regulations, Art. 13.3.1.
 - Competitors must declare at administrative checks which nominated tyre supplier (as defined in Art. 14.1) they will use for the whole rally.

7.5.2 TYRE SPECIFIED FOR USE ALL ERC1 COMPETITORS ENTRED WITH A RALLY2 OR RALLY2-KIT CAR ACCORDING TO 2026 RRSR V1A 13.3.2

Tyre Manufacturer	Allowed compounds
Michelin	G70, G80
Pirelli	AT6, AT8
Hankook	G54, G74
MRF	ZG4 G4MB, ZG4 G4SSD

7.5.2 TYRE FOR JUNIOR ERC CHAMPIONSHIP

For the Junior ERC Championship, only Hankook tyres, sold at the rallies by the Junior ERC Championship tyre supplier, are eligible.

Competitors registered for the Junior ERC Championship must use the following type of tyres:

Tyre Manufacturer	Size	Name	Usage	Max usage
HANKOOK	175/70R15	G33	Hard	12
	175/70R15	G73	Soft	6

7.6 QUANTITIES OF TYRE

The quantities of tyres for use during the rally by all drivers are as follows:

Class	Quantity
RC2 and RGT	16
RC3, RC4, RC5 and RC6	12

For Free Practice and Shakedown tyres will not count for the overall quantity.

7.7 TYRE MARKING

Only tyres marked by the Scrutineers may be used. Any infringement to this rule will be reported to the Stewards.

7.7.1 TYRE MARKING LOCATIONS

- At the Qualifying stage (Technical Zone between the TC and Start)
- After TC 0
- After TC 1C, 4C 8E and 12C (before the refuel)

7.2 TYRES CHECKING

Tyres will be checked for their conformity during the rally.

7.8 TYRES FOR USE ON reconnaissance

Free tyres for gravel.

8. IMPORT OF VEHICLES AND SPARE PARTS

FROM THE EUROPEAN UNION.

Competitors from the European Union do not need to make any special custom clearance for temporary import of cars and equipment on arrival in Sweden.

FROM OUTSIDE THE EUROPEAN UNION

If you are importing the rally car, service cars and/or spare parts/equipment from outside the European Union you must report to the customs on arrival in Sweden. Please contact the Custom authorities in Sweden in advance, phone +46 771 520 520, website: www.tullverket.se, for current information and procedure.

9. HELICOPTERS

Only helicopters following the instructions of the Swedish Transport Agency, are allowed to operate in this area.

Note! All foreign Aerial Work operators must obtain permission for flying in Sweden from the Swedish Transport Agency. For further information please contact:

Swedish Transport Agency Civil Aviation Department.

Phone: +46 (0)771 503 503, e-mail: luffart@transportstyrelsen.se

Attention! The use of drones (UAV) in the rally area, i.e. special stages, service parking and in the start and the finish area is strictly prohibited.

10. HOSPITALITY ARRANGEMENTS

VIP Colins Crest

Just a few metres from one of the world's most spectacular rally experiences, you'll find our VIP area. Here, you can enjoy a unique festival atmosphere at one of rally's most iconic locations – the legendary Colin's Crest.

For more information and bookings, please contact anna.laurentinsson@ercroyalrally.com, call +46 (0) 72 064 8906, or visit ERCROYALRALLY.COM. You can also find further details in Appendix F.

Restaurant at Rally HQ

Race Course (2nd floor, Rally HQ) will serve lunch and dinner buffet during the week of the rally.

Lunch: 11:30–14:00. Dinner: 17:00–19:00.

Pub menu served in the lounge 20:00–22:30. Full bar service 11:00–24:00.

Takeaway food is available.

You can pre-order meals and pick up coupons in the restaurant — email your order to johanna@racecourse.se

For call +46(0)732–622672 or +46(0)54-292025.

11. HOTEL / ACCOMMODATION RESERVATION

Contact the hotels in the rally area for accommodation possibilities.
The local tourist offices in the area may also help with reservations.

Visit Värmland: <https://visitvarmland.com/boende>

12. RECONNAISSANCE

All competitors must make one IOS or Android smartphone available and equip their reconnaissance cars with a smartphone-based application RS Lite developed by the FIA official supplier STATUS AWARENESS SYSTEM (SAS). SAS will distribute individual event access codes during the reconnaissance registration.

13. SCRUTINEERING, SEALING AND MARKING

Date, place and time-windows (individual times in bulletin)

Preparations to be made before the car is brought to scrutineering

- Underrun protection must be removed. but included for control of weight

- Parts to be sealed must be prepared with the correct wire

Important!

- Only three mechanics allowed to accompany the car. One for rally car, one for sealing spare parts and one for personal equipment"

Collection / return points for safety tracking system are same place as collecting in SAS office rally HQ first floor.

Final scrutineering at same place as pre scrutineering.

14. SHAKEDOWN / FREE PRACTICE AND QUALIFYING

Shakedown/Free practice and Qualifying stage Träfors is 29,09 km from the service park and is 6,42 km long

See Appendix B

15. START PROCEDURE

The official start of the rally will be at TC 0.

A start holding area at Karlstad City Square will be established before TC 0, and the crews are requested to be in this area 30 minutes before each car's individual start time.

There will be a prestart show including presentation of selected cars and drivers starting from 17:30. Further details will be given in a Bulletin.

16. FINISH PROCEDURE

The finish of the competition element of the rally is at TC 16A, the holding area at the podium.

Thereafter crews must follow the instructions of officials during the podium ceremony. From the podium, crews are obliged to drive their competing car to the final parc fermé following the route described in the road book.

Between TC 16A and parc fermé, competitors will be under parc fermé conditions and will be observed by marshals. Recovery of any competing car which fails to arrive under its own power at the final parc fermé shall be the responsibility of the competitor. The permission of the Clerk of the Course must be obtained before any recovery arrangements are made.

All cars selected for the final checks must be driven without delay to the parc fermé and then to the scrutineering.

17. PR ACTIVITIES

PR activities will take place Thursday at 18:00 AT BAUHAUS in Karlstad (selected drivers will be announced later)

18. MEDIA

CONTACT BEFORE THE RALLY

FIA ERC Press Officer	Richard Rodgers	+44 7503 871 575	richard.rodgers@fiaerc.com
National Press Officer	Sebastian Bourghardt	+46 (0)76 357 12 28	sebastian@ercroyalrally.com

ACCREDITATION PROCEDURE / CRITERIA AND DEADLINE

Application through Eventhos platform. Information, links and criteria can be found at our website
<https://ercroyalrally.com/en/media/>.

ACCREDITATION DESK AND PRESS ROOM – LOCATION AND OPENING HOURS

Detailed information will be broadcasted to accredited media and relative parties.

Address: Färjestads travbana, Norra Infarten 79, SE-651 08 Karlstad, Sweden

Directions: , [59.40867 N 13.50063 E](#)

Media Center and Accreditation Opening Hours

		Media Accreditation	Media Centre
Thursday	21 May	14:00 - 18:00	Closed
Friday	22 May	08:30 - 20:00	07:45 - 20:00
Saturday	23 May	08:30 - 20:00	08:30 - 21:00
Sunday	24 May	Closed	07:00 - 21:00

19. MEDICAL AND SAFETY SERVICE

Medical information for Sweden

Citizens from the EU/EEA - countries will receive emergency medical care paying the same patient charge as Swedish citizens. Competitors from these countries must provide a European Health Insurance Card verifying that the person is covered by health insurance, when medical care is required, and should obtain this form before leaving their home country. Citizens from the Nordic countries are not required to provide the European Health Insurance Card.

Besides the EU/EEA-countries Sweden has an agreement with the following countries which guarantees the citizens emergency medical care at the same patient charge as Swedish citizens: Algeria and Australia.

Competitors from these countries must also provide a European Health Insurance Card, EU card or corresponding document verifying that the person is covered by health insurance. Citizens in other countries than mentioned above must pay the total cost of treatment plus the patient charge.

When competing outside their countries, crews must have taken out an international insurance policy covering their repatriation, if necessary, after an accident.

Emergency number: 112

To ambulance, Fire Brigade or Police: Your call is free from any telephone.

Medical Care

In urgent cases call **112**

In non-urgent cases, contact the 24 hour telephone service for medical care assistance: **1177**

Your phone call will be answered by experienced nurses, who will help you to find the best treatment or book a doctor appointment.

Hospitals in the area Phone (switchboard)

Centralsjukhuset Karlstad +46 (0)10-831 50 00

Police

In urgent cases call 112

In non-urgent cases, contact the 24 hour telephone service: 11414

Towing Service Sweden

Assistancekåren Phone: +46 (0)20 912 912

Pharmacias

Karlstad	Apoteket Örnen	Järnvägsgatan 2
	Apoteket Vargen	Karlstad Hospital
	Apoteket Mitt i City	Järnvägsgatan 10
	Kronans Apotek	Drottninggatan 16
	Apoteksgruppen	Petersbergsgatan 17
	Apoteket Hjärtat	ICA Maxi Stormarknad Bergvik
	Kronans Apotek	Bergvik
	Apoteket Välsviken	Rävbergsvägen 13

20. LIST OF USEFUL FACTS AND SERVICES

General facts about Sweden

Geography

Size:	449 964 km ² (54 % forested, 16 % mountainous, 8% agricultural land and 9% water)
Length:	1574 km
Width:	499 km
Highest peak:	Kebnekaise 2111 metres
Time zone:	GMT + 1 hour
Sunrise in Karlstad 22 May 2026:	04:19
Sunset in Karlstad 22 May 2026:	21:48

Helicopter companies

Arlanda Helicopter	www.arnheli.se	+46(0)70 455 55 81
JONAIR	jonair.se	+46(0)90 12 12 00
Storm Heliworks	stormheliworks.se	+46 (0)63 510 909
HeliAir Sweden	heliairsweden.com	+46(0)8 659 10 00
Proflight	proflight.se	+46 (0)176 184 66
Airlift	firmapost@airlift.no	+47 57 71 81 00
Helitrans	ordre@helitrans.no	+47 483 13 000
Roslagens Helikopterflyg	info@roslagenshelikopterflyg.se	+46(0)176 184 66
Kallax Flyg	kallaxflyg.se	+46(0)980 81 000
Fjällflygarna	fjallflygarna.se	+46(0)961 230 40
Artic Air	arcticair.se	+46(0)954 103 15
Heli	heli.se	+46(0)961 612 40

Rental Cars

Europcar	europcar.com	+46(54) 18 23 20
Avis	avis.se	+46(54) 15 26 60
Mabi	mabi.se	+46(54) 18 01 51
Hertz	hertz.se	+46(54) 21 08 00
Sixt	sixt.se	+46(54) 15 60 30

Climate

Sweden enjoys a temperate climate thanks to the Gulf stream. The climate varies considerably because of the length of the country. During end of May, the average temperature is around 15°.

Other

Currency: Swedish krona / Svenska kronor - SEK
Credit Cards: American Express, MasterCard and Visa is widely accepted
Water: The tap water is safe for drinking
Health: No vaccinations are required
Power: 240 V (volts)

Telephone: The international prefix when you call from Sweden is 00

More facts about Sweden on www.visit-sweden.com

APPENDIX

Appendix A – Itineraries

Appendix A – Compare to previous year

Appendix B - Recce applications for Entrants

Appendix B - Recce applications for non- Entrants

Appendix B - Recce schedule

Appendix B - Recce Map

Appendix B - Stage Map

Appendix C – Service Park facilities order form

Appendix C – Service Park Layout

Appendix C – Trailer Parking

Appendix C – Media Parking

Appendix C – Starting area Layout Karlstad City square

Appendix C - Finishing area at Karlstad City square

Appendix C - Scrutineering Layout

Appendix D - City Map

Appendix E - Rally HQ Layout

Appendix F - Hospitality

Appendix G - Additional Material order form

Appendix H - FIA WRC Tracking System- Installation and operating Instructions

Appendix I – Road Book and Overview map

APPENDIX A

Itinerary

QS					FRIDAY 22 MAY		Sunrise 04:19 Sunset 21:48		Vers 2.1 2026-04-24	
TC/SS	Location	Distance			Target	First				
		SS	Liaison	Total	Time	car due				
TC FP	Start of Free Practice					11:00				
FREE PRACTICE CLOSSES AT 13:00										
TC QS						13:56				
QS	Qualifying Stage Träfors	6,42				14:01				
TC TZ	Technical Zone IN (Early Check In Permitted)		29,77	36,19	0:49	14:50				
QS Totals		6,42	29,77	36,19						

Qualifying

SD										
TC/SS	Location	Distance			Target	First				
		SS	Liaison	Total	Time	car due				
	Service Park Karlstad		29,09	29,09						
SD	Shakedown Träfors	6,42				15:00				
	Service Park Karlstad IN		29,77	36,19						
SHAKEDOWN 15:00 - 16:00										
SD Totals		6,42	58,86	65,28						

Shakedown

Section 1										
TC/SS	Location	Distance			Target	First				
		SS	Liaison	Total	Time	car due				
TC 0	Karlstad City					18:10				
TC 1			11,79	11,79	0:20	18:30				
SS 1	Bråtebäcken 1	3,18				18:33				
TC 1A	Parc Fermé Karlstad IN		9,04	12,22	0:25	18:58				
Section 1 Totals		3,18	20,83	24,01						

Section 1

Section 2-3		SATURDAY 23 MAY			Sunrise 04:17 Sunset 21:50	Vers 2.1 2026-04-24
TC/SS	Location	SS	Distance Liaison	Total	Target Time	First car due
TC 1B	Parc Fermé Karlstad OUT / Service IN					06:45
	Service A (Karlstad)	(3,18)	(20,83)	(24,01)	0:15	
TC 1C	Service OUT					07:00
RA 1	Refuel Service Out (All competitors)		(0,00)			
	Distance to next refuel	(14,46)	(51,18)	(65,64)		
TC 2			44,76	44,76	1:00	08:00
SS 2	Värmskog 1	14,46				08:03
RA 2	Remote refuel Malsjö (All competitors)		(6,42)		-	
	Distance to next refuel	(19,30)	(99,66)	(118,96)	-	
TC 3			67,49	81,95	1:30	09:33
SS 3	Stensjön	19,30				09:36
RA 3	Remote refuel Malsjö (All competitors)		(38,59)		-	
	Distance to next refuel	(14,46)	(52,36)	(66,82)	-	
TC 4			52,41	71,71	1:20	10:56
SS 4	Värmskog 2	14,46				10:59
TC 4A	Regroup and Technical Zone IN		38,54	53,00	1:00	11:59
TC 4B	Regroup OUT / Service IN				0:20	12:19
	Service B (Karlstad)	(48,22)	(203,20)	(251,42)	0:30	
TC 4C	Service OUT					12:49
RA 4	Refuel Service Out (All competitors)		(0,00)		-	
	Distance to next refuel	(17,82)	(119,34)	(137,16)	-	
TC 5			66,54	66,54	1:25	14:14
SS 5	Gårdsjö 1	11,39				14:17
TC 6			30,27	41,66	0:50	15:07
SS 6	Colins 1	6,43				15:10
RA 5	Remote refuel Sunne (All competitors)		(22,53)		-	
	Distance to next refuel	(17,82)	(125,79)	(143,61)	-	
TC 7			32,24	38,67	1:07	16:17
SS 7	Gårdsjö 2	11,39				16:20
TC 8			30,27	41,66	0:50	17:10
SS 8	Colins 2	6,43				17:13
TC 8A	Technical Zone IN		85,81	92,24	1:45	18:58
TC 8B	Technical Zone OUT / Service IN				0:10	(19:08)
	Flexi Service C (Karlstad)	(35,64)	(245,13)	(280,77)	0:45	
TC 8C	Service OUT / Parc Fermé Karlstad IN					(19:53)
All cars must be returned to Parc Fermé no later than						22:30
Saturday Totals		83,86	448,33	532,19		

Section 2

Section 3

Section 4-6		SUNDAY 24 MAY			Sunrise 04:15 Sunset 21:52		Vers 2.1 2026-04-24	
TC/SS	Location	SS	Distance Liaison	Total	Target Time	First car due		
TC 8D	Parc Fermé Karlstad OUT / Service IN					06:20		
	Service D (Karlstad)	(0,00)	(0,00)	(0,00)	0:15			
TC 8E	Service OUT					06:35		
RA 6	Refuel Service Out (All competitors)		(0,00)					
	Distance to next refuel	(32,63)	(68,88)	(101,51)				
TC 9			44,82	44,82	1:02	07:37		
SS 9	Bäckelid 1	19,58				07:40		
TC 10			15,12	34,70	0:46	08:26		
SS 10	Ängbäckstorp 1	13,05				08:29		
RA 7	Remote refuel Molkom (All competitors)		(8,94)					
	Distance to next refuel	(32,63)	(68,57)	(101,20)				
TC 11			24,41	37,46	1:00	09:29		
SS 11	Bäckelid 2	19,58				09:32		
TC 12			15,12	34,70	0:46	10:18		
SS 12	Ängbäckstorp 2	13,05				10:21		
TC 12A	Regroup and Technical Zone IN		37,98	51,03	1:03	11:24		
TC 12B	Regroup OUT / Service IN				0:15	11:39		
	Service E (Karlstad)	(65,26)	(137,45)	(202,71)	0:30			
TC 12C	Service OUT					12:09		
RA 8	Refuel Service Out (All competitors)		(0,00)					
	Distance to next refuel	(16,82)	(94,17)	(110,99)				
TC 13			32,84	32,84	0:50	12:59		
SS 13	Lövhöjden 1	8,91				13:02		
TC 14			35,60	44,51	0:57	13:59		
SS 14	Ölme 1 (Live TV)	7,91				14:05		
RA 9	Remote refuel Väse (All competitors)		(25,73)					
	Distance to next refuel	(16,82)	(96,17)	(112,99)				
TC 15			35,86	43,77	0:59	15:04		
SS 15	Lövhöjden 2	8,91				15:07		
TC 15A	Regroup Väse IN		20,76	29,67	0:38	15:45		
TC 15B	Regroup Väse OUT				0:56	16:41		
TC 16			14,82	14,82	0:21	17:02		
SS 16	Ölme 2 (Power Stage)	7,91				17:05		
TC 16A	Finish Holding Area - Rally Finish		50,46	58,37	1:10	18:15		
	Podium Ceremony Karlstad					19:00		
		(33,64)	(190,34)	(223,98)				
	Sunday Totals	98,90	327,79	426,69				

TOTALS OF THE RALLY				
	SS	Liaison	Total	%
Friday 22 May - 1 SS Section 1	3,18	20,83	24,01	13,2%
Saturday 23 May - 7 SS Section 2-3	83,86	448,33	532,19	15,8%
Sunday 24 May - 8 SS Section 4-6	98,90	327,79	426,69	23,2%
Total - 16 SS	185,94	796,95	982,89	18,9%

APPENDIX A

Compared to previous year

Stage	Location	New	2025	Total
SS 1	Bråtebäcken	0,41	2,77	3,18
SS 2	Värmskog 1	0,00	14,46	14,46
SS 3	Stensjön	19,30	0,00	19,30
SS 4	Värmskog 2	0,00	14,46	14,46
SS 5	Gårdsjö 1	0,00	11,39	11,39
SS 6	Collins 1	1,02	5,41	6,43
SS 7	Gårdsjö 2	0,00	11,39	11,39
SS 8	Collins 2	1,02	5,41	6,43
SS 9	Bäckelid 1	19,58	0,00	19,58
SS 10	Ängebäckstorp 1	1,73	11,32	13,05
SS 11	Bäckelid 2	19,58	0,00	19,58
SS 12	Ängebäckstorp 2	1,73	11,32	13,05
SS 13	Lövhöjden 1	9,91	0,00	8,91
SS 14	Ölme 1	7,91	0,00	7,91
SS 15	Lövhöjden 2	8,91	0,00	8,91
SS 16	Ölme 2 (Power Stage)	7,91	0,00	7,91
Totals		99,01	87,93	185,94
New SS km		54,2 %		

Stage	Distance	Modifications from 2025
Shakedown / Qualifying	Träfors	0,00 - 6,42 km New stage
SS 1	Bråtebäcken	0,00 - 2,77 km Identical route as SS 1
		2,77 - 3,18 km New part in the quarry
SS 2/4	Värmskog	0,00 - 14,50 km Identical route as SS 3/5
SS 3	Stensjön	0,00 - 19,30 km New stage
SS 5/7	Gårdsjö	0,00 - 11,39 km Identical route as SS 6/8
SS 6/8	Collins	0,00 - 1,02 km New stage
		1,02 - 6,43 km Identical SS 7/9 (3,61-9,01 km)
SS 9/11	Bäckelid	0,00 - 19,58 km New stage
SS 10/12	Ängebäckstorp	0,00 - 11,32 km Identical route as SS 10/12.
		11,32 - 13,05 km New stage
SS 13/15	Lövhöjden	0,00 - 8,91 km New stage
SS 14/16	Ölme	0,00 - 7,91 km New stage (same as SS 15/17 but in opposite direction)

APPENDIX B

start no:

RECCE REGISTRATION FORM

Please Submit this form to the organiser latest Wednesday 13 May 23:59 2026.
competitor@ercroyalrally.com

CREW	
Driver	
Mobile phone	
Co-Driver	
Mobile phone	
Team contact person during recce	
Mobile phone	
RECCE CAR	
Make & model	
Registration No	
Colour	

ACCOMMODATION DURING RALLY	

RECCE APPLICATION FORM FOR NO-ENTRANTS

Please Submit this form to the organiser latest Wednesday 13 May 23:59 2026. competitor@ercroyalrally.com

Applicant: (if other then crew)	
Driver Family Name, First Name	
Nationality (as passport)	
Street Address, Postal Code, City	
Country	
Competition Licence Number Issuing ASN	
Driving Licence Number Country of Issue	
Co-Driver Family Name, First Name	
Nationality (as passport)	
Street Address, Postal Code, City	
Country	
Competition Licence Number Issuing ASN	
Driving Licence Number Country of Issue	

APPLICATION FEE 6.500 SEK + VAT (6%)

Payment in Sweden: Bankgiro 5914-1333
Payment from abroad: IBAN: SE83 6000 0000 0004 2275 5311
SWIFT: HANDSESS
Account holder: Royal Rally Scandinavia AB
Address of the bank: SVENSKA HANDELSBANKEN AB, Kungsträdgårdsgatan 2, STOCKHOLM

Note: Please mark the payment with the driver's last name. Send a proof of payment of the entry fee by e-mail to competitor@ercroyalrally.com by the closing date of entries.

RELEVANT RESULTS

RESULTS	YEAR	EVENT	OVERAL POS.	CLASS POS.
INTERNATIONAL				
NATIONAL				
OTHER				

I hereby declare that I take part of Bauhaus Royal Rally of Scandinavia at my own risk. I will not hold the Organiser, it's Officials, the Stewards, the Swidish Automobile Sport Federation or the FIA responsible for any accident, injuries etc occurring during the recongnesens. I have knowledge of and undertake to follow regulations and roubles governing the reconnaissance, as well as instructions and decisions of the organiser.

Signature _____ Date: _____

Applicant other then members of the crew: _____
Signature

Driver: _____
Signature

Co-Driver: _____
Signature

APPENDIX B

Recce schedule

Thursday 21 May Stage	Allowed Time	Tot SS		Finish to Start	To Next Stage	Totals
		SS km	km x 2			
Service Park					34,22	34,22
SS 14/16 Ölme	07:00 - 09:00	7,91	15,82	18,55	20,75	55,12
QS/SD Träfors	07:45 - 09:30	6,42	12,84	14,19	14,50	41,53
SS13/15 Lövhöjden	08:30 - 10:30	8,91	17,82	11,88	69,51	99,21
SS 5/7 Gårdsjö	10:00 - 12:30	11,39	22,78	19,26	30,27	72,31
SS 6/8 Colins	11:00 - 13:00	6,43	12,86	9,08	41,37	63,31
SS 3 Stensjön	12:00 - 15:30	19,30	38,60	33,00	50,33	121,93
SS 2/4 Värmskog	14:00 - 16:30	14,46	28,92	19,78	46,24	94,94
SS 1 Bråtebäcken	15:30 - 17:30	3,18	6,36	6,31	9,04	21,71
Service Park						
Totals		78,00				604,28

Friday 22 May Stage	Allowed Time	Tot SS		Finish to Start	To Next Stage	Totals
		SS km	km x 2			
Service Park					44,82	44,82
SS 9/11 Bäckelid (and) SS 10/12 Ängbäckstorp (in loop)	07:00 - 10:00	32,63	65,26	40,60	37,98	143,84
Service Park						
Totals		32,63				188,66

APPENDIX B

Recce Maps and Stages Maps are available in the rally website,

<https://ercroyalrally.com/en/competitors/protected-documents>

These documents must be considered as integral part of the Rally Guide.

This will be available from 11 May.

You will get in logging details in your confirmation of entry

APPENDIX C

Service Park layout

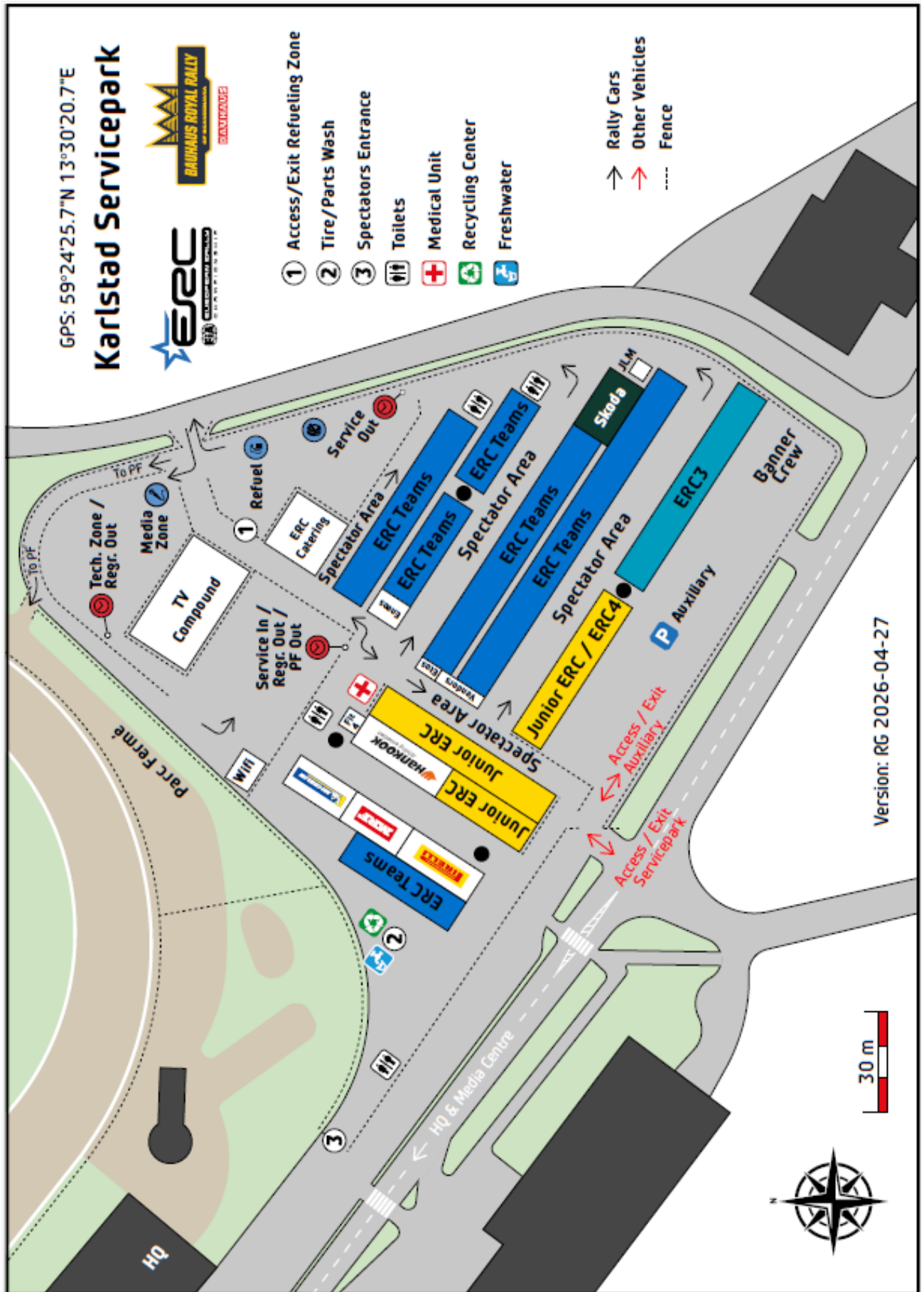

APPENDIX C

Service Park facilities order form is available in the rally website,
https://ercroyalrally.com/en/competitors/other_documents

APPENDIX C

Trailer parking

Trailer parking will be inside Kalvholmen Motor Stadium.

Please do not park your trailer in front of another trailer so you blocking them.

We recommend that the trailer are being locked.

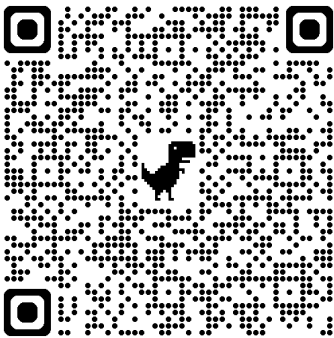

APPENDIX C

Media parking

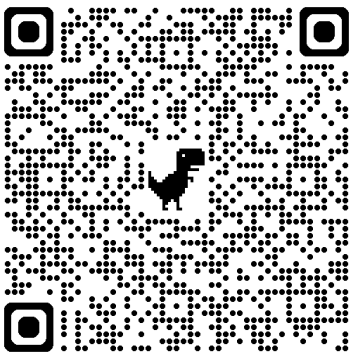

APPENDIX C

Scrutineering layout

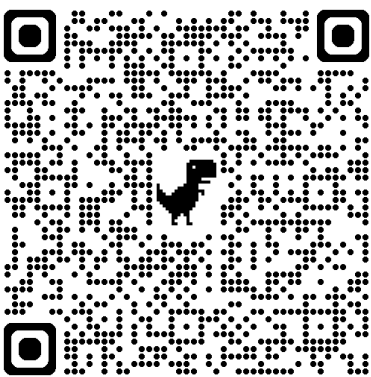
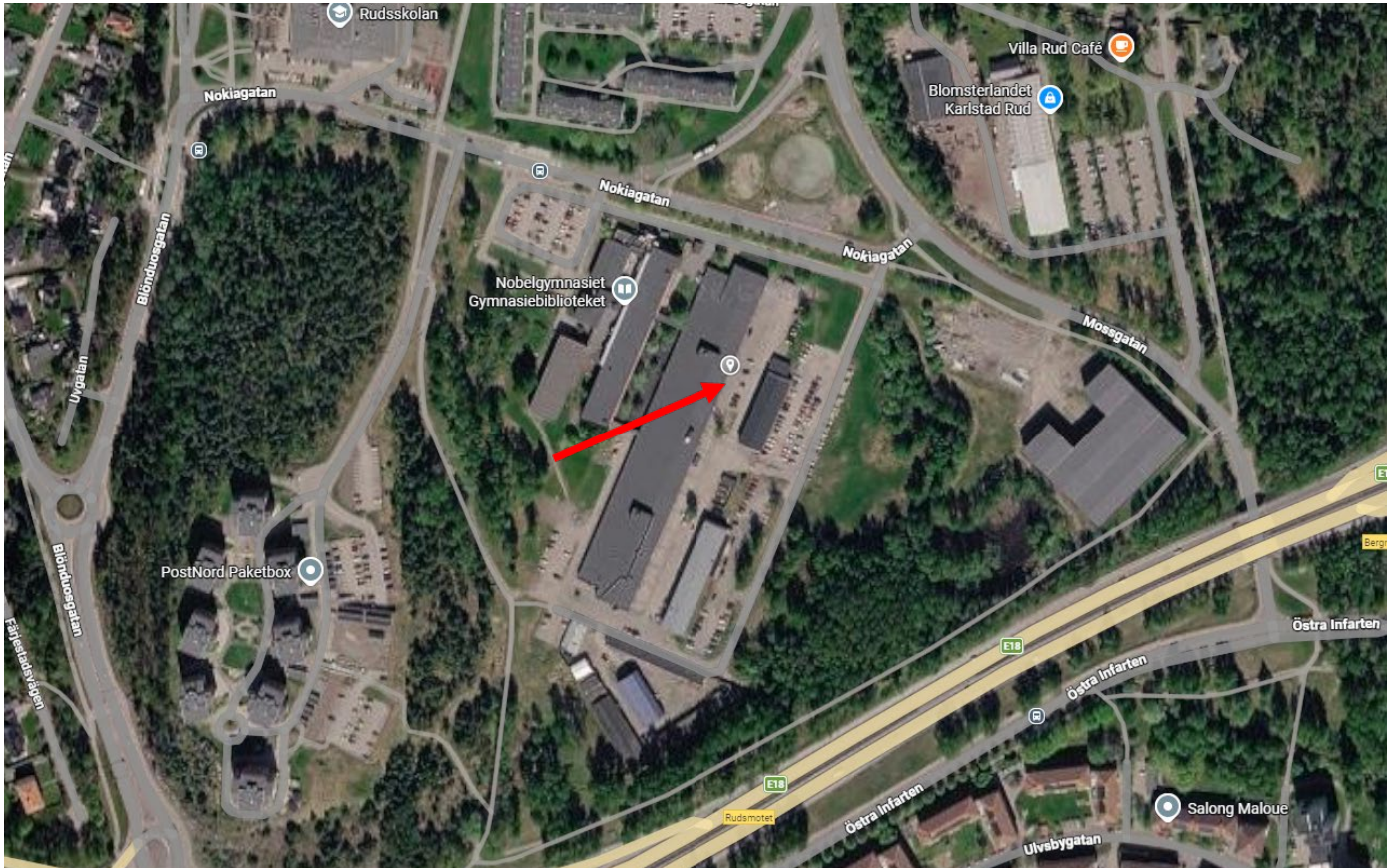

APPENDIX D

City Map

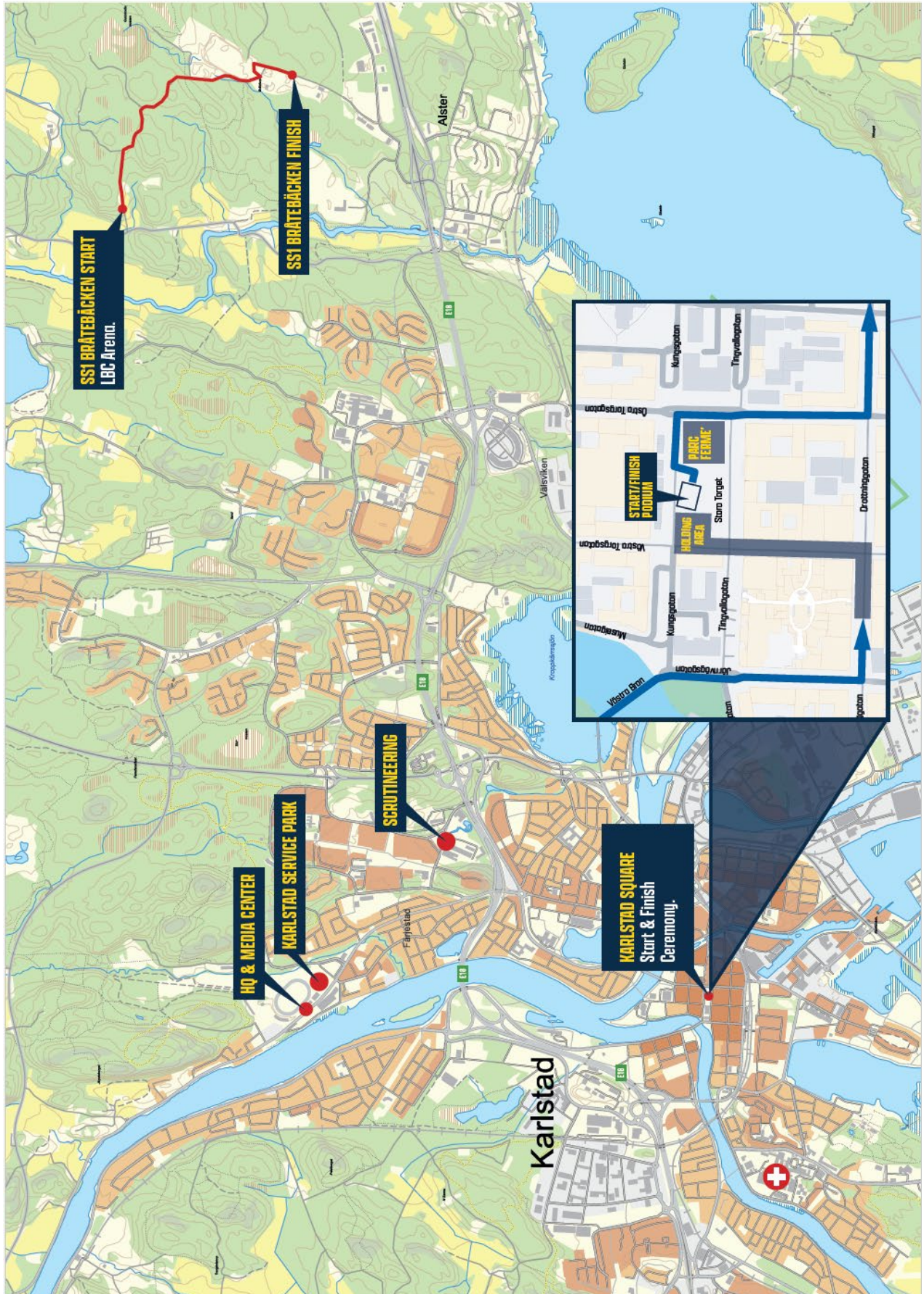

APPENDIX C

Layout Karlstad City main square START

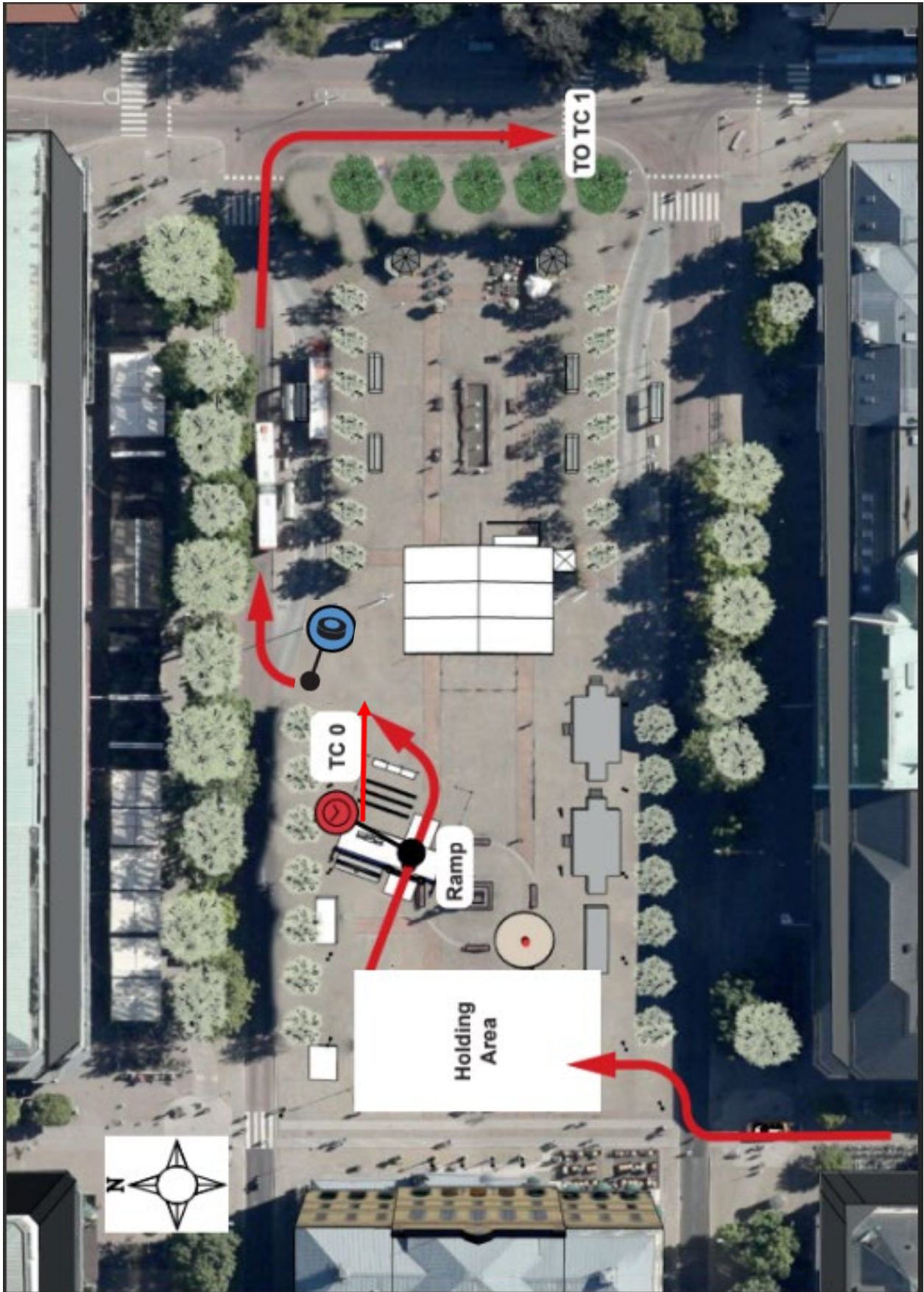

APPENDIX C

Layout Karlstad City main square FINISH

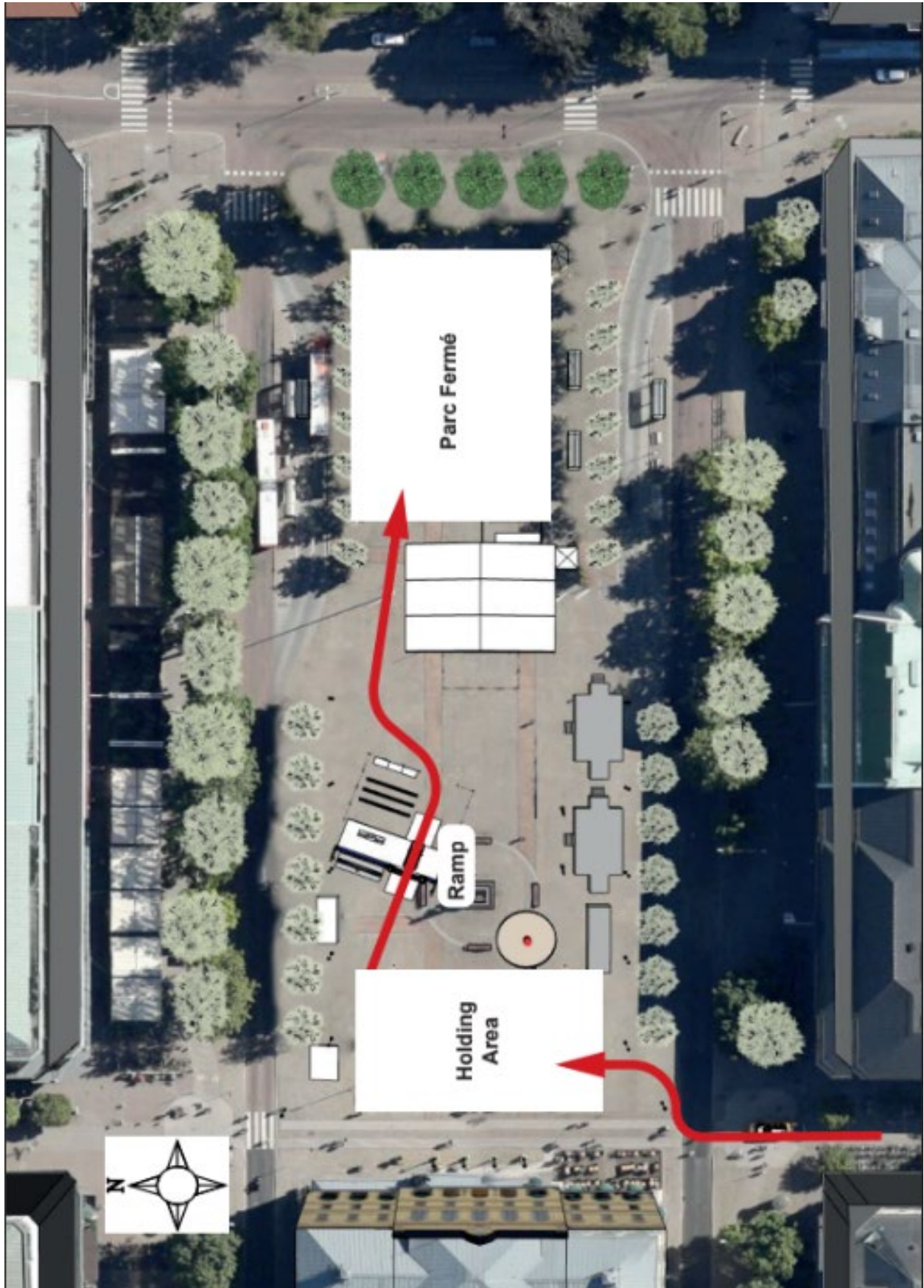

APPENDIX D

City Map

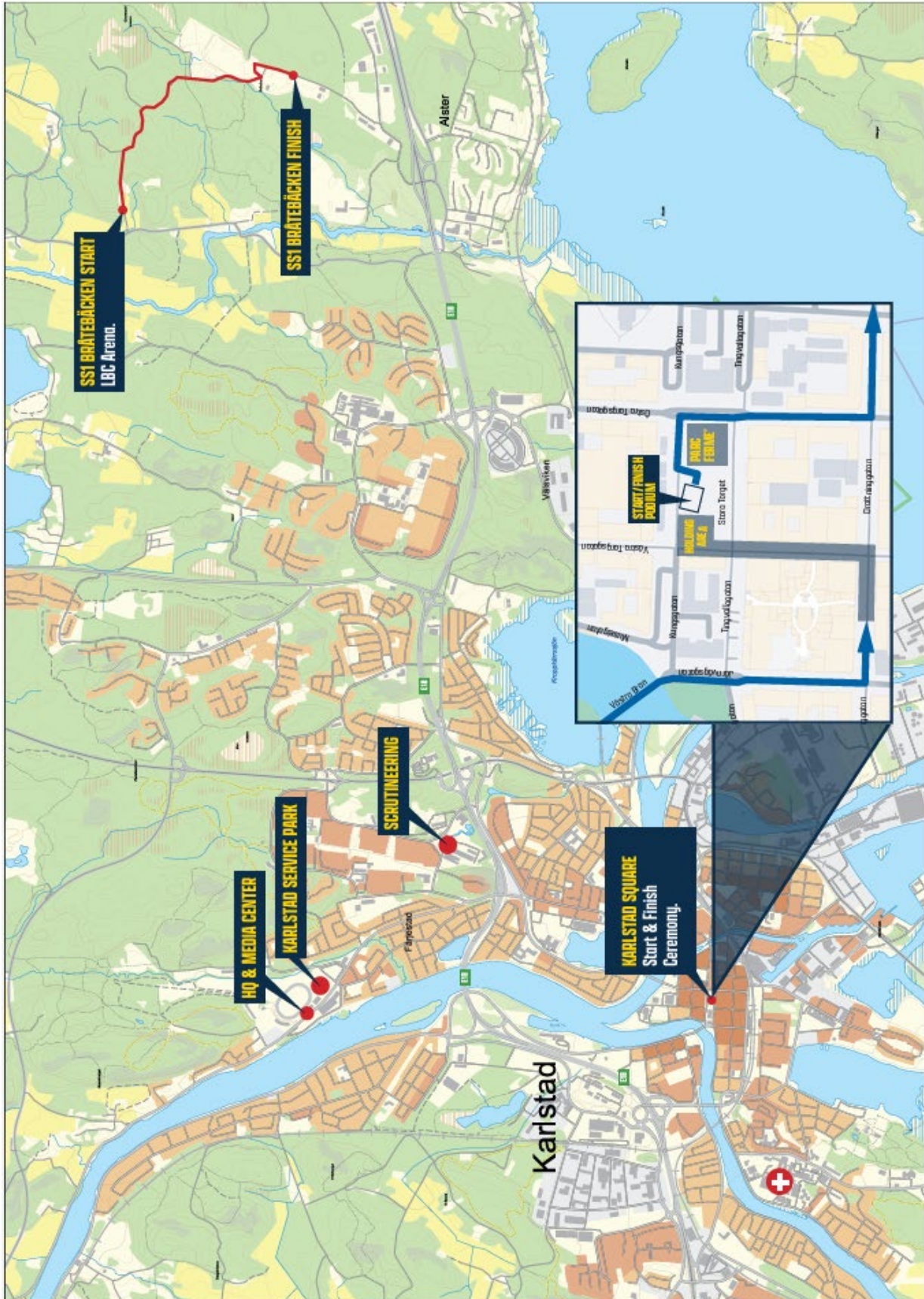

APPENDIX E

Rally HQ Layout and Information



BAUHAUS Royal Rally Of Scandinavia 2026 HQ Maps

Rally HQ - First Floor

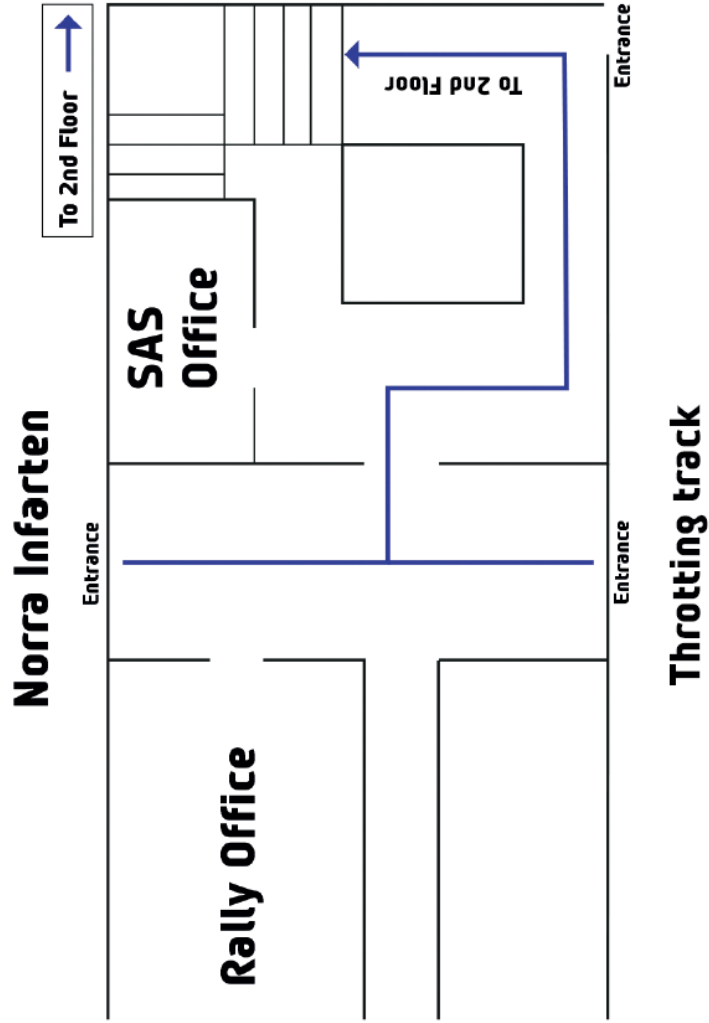

Rally HQ - Second Floor



Norra Infarten

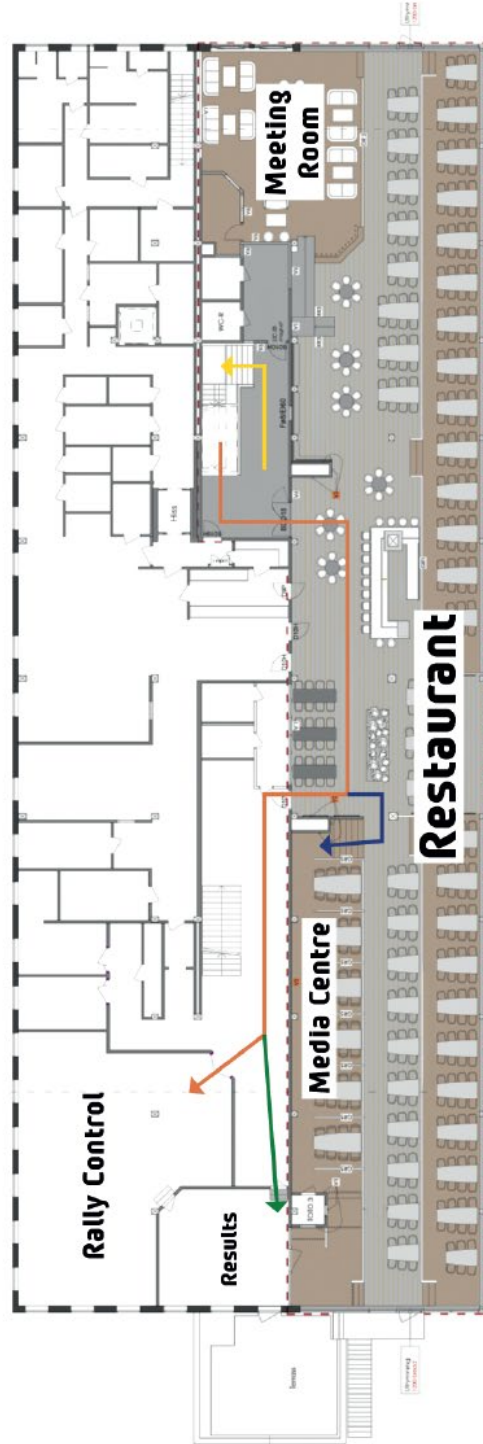

Service Park

Throtting Track

Rally HQ - Third Floor

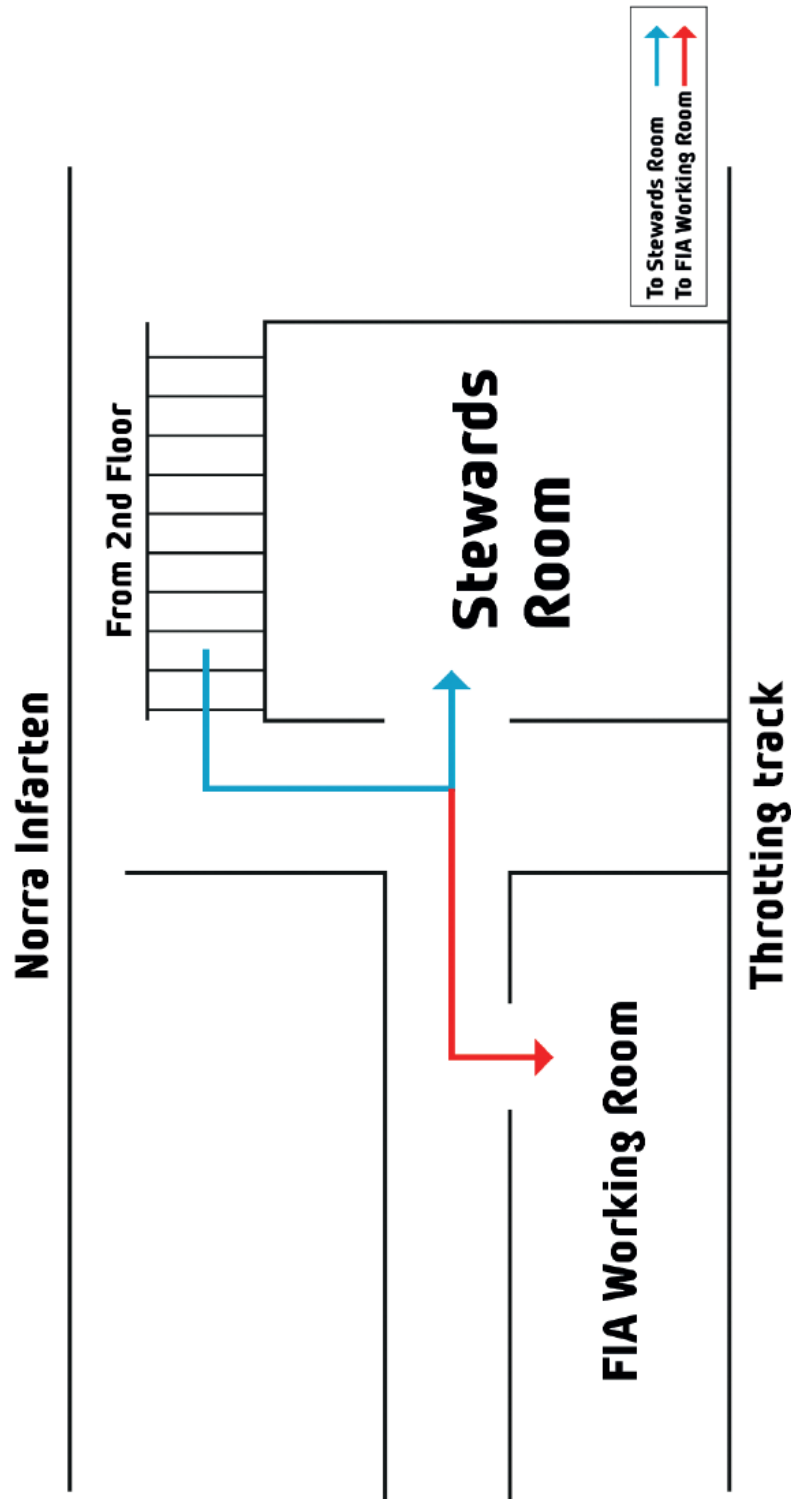

APPENDIX F Hospitality

VIP Colins Crest



VIP COLIN'S CREST SATURDAY

ROYAL SUPER SATURDAY AT COLIN'S CREST

Welcome to a truly unique VIP experience!

The highlight of winter has transformed into a summer celebration like no other.

Colin's Crest is one of the most iconic locations in the rally world.

Deep in the forest, just a few kilometres from the nearest parking area, you'll find a vibrant fan zone and one of rallying's most famous jumps.

Here, we've created a spectator area where you get incredibly close to the cars.

Follow the action on the big screen, and with live commentary on site, experience the ERC cars up close as they fly over the legendary crest, with jumps approaching 50 metres. Spectacular, wild, and truly unforgettable – quite simply, a royal experience.

Mads Østberg holds the record at 47 metres – can anyone beat it in 2026?

Schedule Colin's Crest Saturday May 23:

15:10 - SS6 Colins 1

17:13 - SS8 Colins 2



When? Saturday May 23

What? Colin's Crest, Löfstaholm Sunne

Price? 1995 SEK ex VAT

You get:

- VIP pass with access to the entire VIP area, including the best viewing spots at Colin's Crest
- featuring a bar area, natural grandstand overlooking the stage, seating around the bar and kitchen, restrooms, and more.
- Delicious buffet fresh from the grill, plus
- three drinks from the bar.
- VIP pass granting free entry to all rally stages
- throughout the day.
- Official event programme magazine.

Contact & Booking

anna.laurentinsson@ercroyalrally.com

+46 72-0648906

APPENDIX G

Additional order form is available in the rally website,

[https://ercroyalrally.com/en/competitors/other published documents](https://ercroyalrally.com/en/competitors/other_published_documents)

APPENDIX H

FIA WRC TRACKING SYSTEM - INSTALLATION AND OPERATING INSTRUCTIONS

Installation and Operation instructions for the FIA Safety Tracking Device and RS Lite (for recce) are available in the rally website,

<https://ercroyalrally.com/noticeboard/>

APPENDIX I

ROAD BOOK and OVERVIEW Map

Road Books are available in the rally website,

<https://ercroyalrally.com/en/competitors/protected-documents>

These instructions must be considered as integral part of the Rally Guide.

This will be available from 11 May.

You will get in logging details in your confirmation of entry